

WHAT'S IN THE BOX

JBL Stage GT 50011

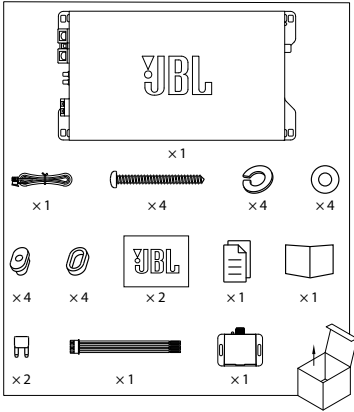

JBL Stage GT 90041

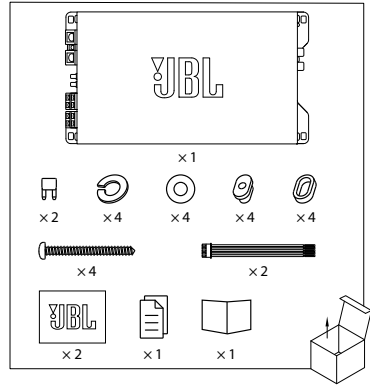

JBL Stage GT 80021

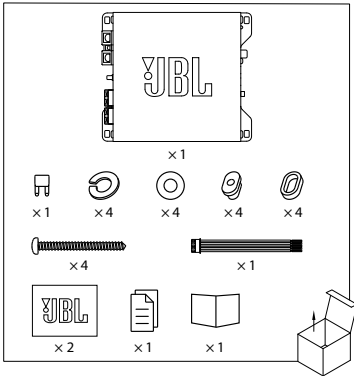

MOUNTING THE AMP

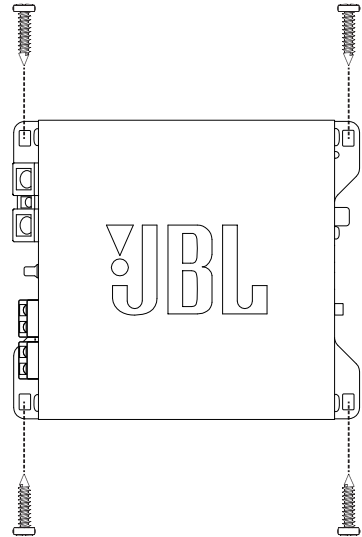

JBL Stage GT 60041

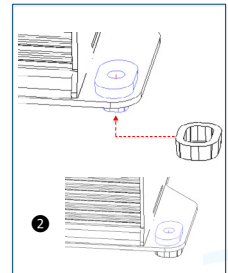
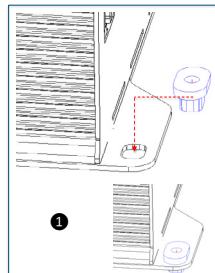
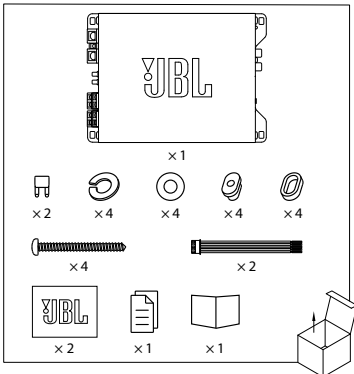

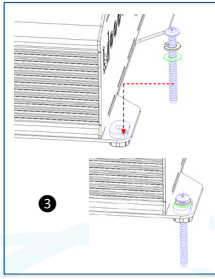

At ground location:

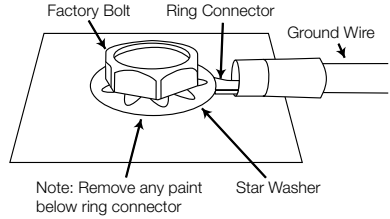

WIRING FOR INPUT SIGNAL

Stage GT 50011 and 80021 low-level signals

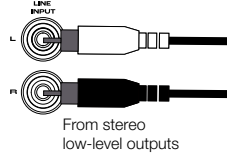

Stage GT 60041 and 90041 low-level signals

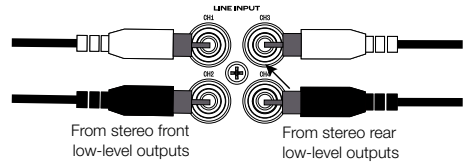

Stage GT 50011 and 80021 high-level signals

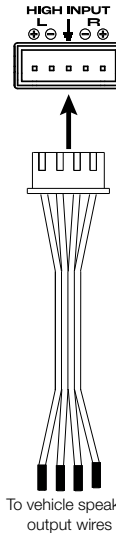

Note: Be sure to observe proper polarity when connecting the vehicle speaker wires to the high-level adapter.

Note: It is recommended that you make all wire connections before mounting the amplifier.

IMPORTANT: Disconnect the vehicle's negative (-) battery terminal before beginning the installation.

- Always wear protective eyewear when using tools.
- Choose a safe mounting location, away from moisture. Check clearances on both sides of a planned mounting surface. Be sure that screws or wires will not puncture brake lines, fuel lines, or wiring harnesses and that wire routing will not interfere with the safe vehicle operation. Use caution when drilling or cutting in the mounting area.
- Choose a location that provides enough air circulation.
- Do not mount the amplifier with the heat sink facing downward, as this interferes with cooling.
- Mount the amplifier so that it will not be damaged by the feet of backseat passengers or shifting cargo in the trunk.

WIRING FOR POWER AND GROUND

At amplifier:

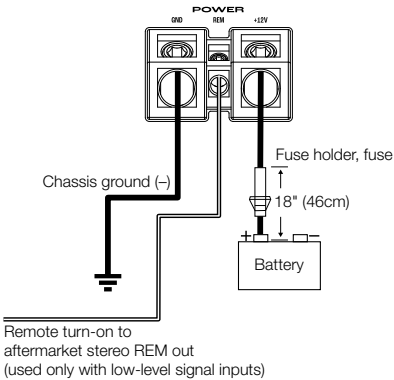

NOTE: If you are using high-level input signals, you do not need to connect the remote turn-on wire. In high-level mode, the amplifier automatically turns on when it detects signal.

Recommended fuse ratings:

- Stage GT 50011: 60A
- Stage GT 80021: 25A
- Stage GT 60041: 40A
- Stage GT 90041: 60A

Car Aftermarket Industry Standard Color Coding	
CH1+ (Front Left +)	White
CH1- (Front Left -)	White/Black
CH2+ (Front Right +)	Gray
CH2- (Front Right -)	Gray/Black

Stage GT 60041 and 90041 high-level input signals

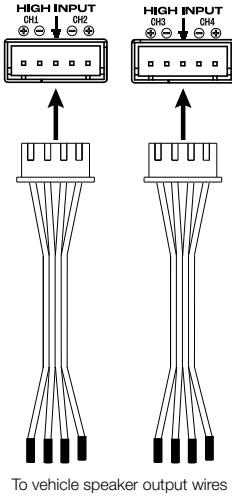

Stage GT 80021 2-channel output

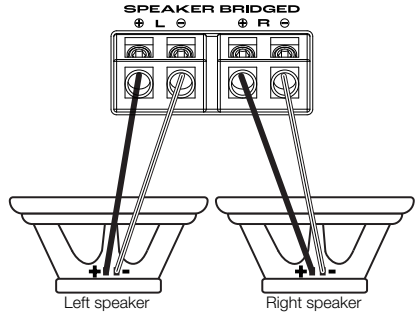

Stage GT 80021 mono (bridged) output

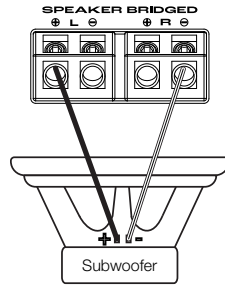

Car Aftermarket Industry Standard	
Color Coding	
CH1+ (Front Left +)	White
CH1- (Front Left -)	White/Black
CH2+ (Front Right +)	Gray
CH2- (Front Right -)	Gray/Black
CH3+ (Rear Left +)	Green
CH3- (Rear Left -)	Green/Black
CH4+ (Rear Right +)	Purple
CH4- (Rear Right -)	Purple/Black

WIRING FOR OUTPUT

Recommended speaker impedances:

- 2 ohm – 4 ohm (stereo inputs)
- 4 ohm (bridged inputs)

Stage GT 50011 mono output

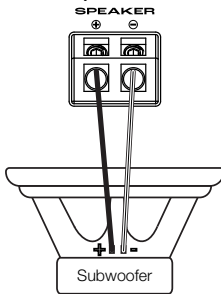

Stage GT 60041 and 90041 4-channel output

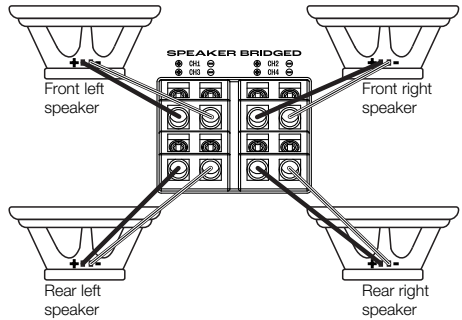

Stage GT 60041 and 90041 3-channel output

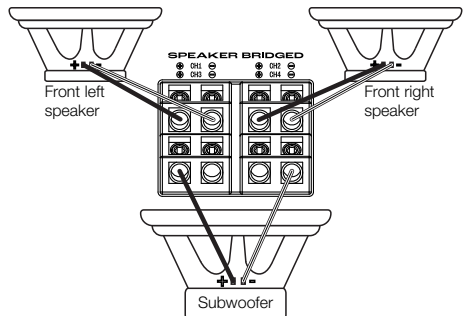

Stage GT 60041 and 90041 2-channel output

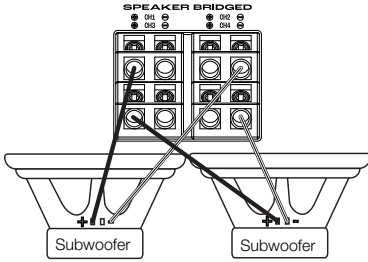

Connecting the remote bass controller (Stage GT 50011 only)

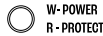
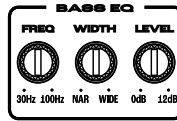
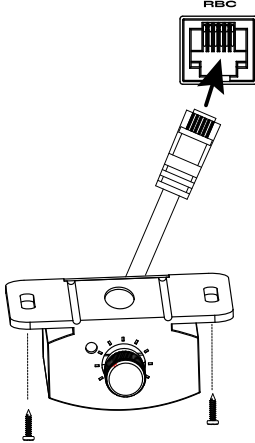

SETTING GAIN, CROSSOVERS, AND BASS EQ

Setting the gain

1. Start with the level control set to 5V, and the crossover control rotated midway.
2. Choose music you're familiar with.
3. Turn the volume control on your head unit to $\frac{3}{4}$ of its total output.
4. Adjust the gain control clockwise, listening carefully to the bass output. If you hear distortion, turn the gain control counterclockwise to decrease the gain.



Selecting the crossover mode

Choose HPF to allow only frequencies above a certain point to reach your speakers. Recommended if you are using a subwoofer in your system, as it keeps low bass from your full-range speakers.

Choose LPF to allow only frequencies below a certain point to reach your speakers. Recommended if you are bridging channels to power a subwoofer.

Choose FULL to allow all frequencies to reach your speakers. Recommended if you are not using a subwoofer in your system.

Note: The Stage GT 50011 features a low-pass crossover only.



Selecting the crossover frequency

Choose the crossover point to suit listening preferences. Turn the dials counterclockwise to lower the crossover point, and clockwise to raise the crossover point. Exact crossover settings for coaxial speakers and subwoofers depend on your listening preferences.

Selecting the Bass EQ – Stage GT 80021, 60041, and 90041

Choose the level of the bass output according to your listening preferences, from 0 to +12 dB. Turn the dial clockwise to raise the Bass EQ output level, and counterclockwise to lower it.

Selecting the Bass EQ – Stage GT 50011 only

1. Adjust the FREQ dial to select the center frequency – the primary bass frequency between 30 Hz and 100 Hz you want to enhance. Turn the dial clockwise to select a higher frequency, and counterclockwise to select a lower frequency. Which you choose depends on your listening preferences.
2. Adjust the WIDTH dial to determine how many adjacent frequencies are also enhanced. Turn the dial clockwise to select a wide range of frequencies, and counterclockwise to select a narrow range.
3. Adjust the LEVEL dial to select the output level of your bass signal, from 0 to +12 dB. Turn the dial clockwise to raise the output level, and counterclockwise to lower it.

Selecting the subwoofer phase – Stage GT 50011 only

Switch the phase back and forth between 0° and 180° to determine which setting provides the most clean bass output.

POWER/PROTECT STATUS INDICATOR

If the power/protect indicator is illuminated in white, the amplifier is on and performing normally. If the indicator is red and no sound is playing, the amplifier is in protect mode. See "Troubleshooting" for possible causes.

SPECIFICATIONS

	Stage GT 50011	Stage GT 80021	Stage GT 60041	Stage GT 90041
Rated power output @ 4 ohms	300 watts RMS x 1	80 watts RMS x 2	65 watts RMS x 4	90 watts RMS x 4
Rated power output @ 2 ohms	500 watts RMS x 1	130 watts RMS x 2	90 watts RMS x 4	130 watts RMS x 4
Peak output	1220 watts x 1 @ 2 ohms	800 watts x 1 @ 4 ohms	1240 watts x 2 @ 4 ohms	1480 watts x 2 @ 4 ohms
Rated power output in bridged mode	n/a	260 watts RMS x 1 @ 4 ohms	180 watts RMS x 2 @ 4 ohms	260 watts RMS x 2 @ 4 ohms
Frequency response (± 1 dB)	10 Hz – 320 Hz	20 Hz – 20 kHz	20 Hz – 20 kHz	20 Hz – 20 kHz
Crossover frequencies	32-320 Hz variable low-pass, 12 dB/octave	32-320 Hz variable high- and low-pass, 12 dB/octave	32-320 Hz variable high- and low-pass, 12 dB/octave	32-320 Hz variable high- and low-pass, 12 dB/octave
Bass EQ	0-12 dB @ 30-100 Hz, variable	0-12 dB @ 45 Hz	0-12 dB @ 45 Hz	0-12 dB @ 45 Hz
Line-level input sensitivity	0.2 Vrms – 5.0 Vrms	0.2 Vrms – 5.0 Vrms	0.2 Vrms – 5.0 Vrms	0.2 Vrms – 5.0 Vrms
High-level input sensitivity	1.0 Vrms – 25 Vrms	1.0 Vrms – 25 Vrms	1.0 Vrms – 25 Vrms	1.0 Vrms – 25 Vrms
Signal-to-noise ratio at 1W @ 4 ohms	>75 dB	>75 dB	>75 dB	>75 dB
THD+N @ rated power	1%	1%	1%	1%
Fuse rating	30A x 2	25A x 1	20A x 2	30A x 2
Operating voltage	9V – 16V	9V – 16V	9V – 16V	9V – 16V
Protection	DC, OVP, UVP, OCP, OTP	DC, OVP, UVP, OCP, OTP	DC, OVP, UVP, OCP, OTP	DC, OVP, UVP, OCP, OTP
Dimensions (W x H x D)	9-23/32" x 1-15/16" x 5-7/32" (246.9mm x 49.5mm x 132.5mm)	6-3/16" x 1-15/16" x 5-7/32" (156.9mm x 49.5mm x 132.5mm)	7-3/8" x 1-15/16" x 5-7/32" (186.9mm x 49.5mm x 132.5mm)	9-11/32" x 1-15/16" x 5-7/32" (236.9mm x 49.5mm x 132.5mm)
Weight	1633g (3.6 lb.)	1061g (2.34 lb.)	1338g (2.95 lb.)	1702g (3.75 lb.)
Recommended wire gauge	4	8	4	4
Max. operating temperature:	70°C	70°C	70°C	70°C

TROUBLESHOOTING

PROBLEM	CAUSE AND SOLUTION
No audio and POWER INDICATOR is off.	No voltage at BATT+ and/or REM terminals, or bad or no ground connection. Check voltages at amplifier terminals with VOM.
No audio and PROTECT INDICATOR flashes every 4 seconds.	DC voltage on amplifier output. Amplifier may need service; see enclosed warranty card for service information.
No audio and PROTECT and POWER INDICATORS flash.	Voltage less than 9V on BATT+ connection. Check vehicle charging system.
No audio and PROTECT INDICATOR is on.	Amplifier is overheated. Make sure amplifier cooling is not blocked at mounting location. Or, there may be voltage greater than 16V (or less than 8.5V) on BATT+ connection. Check vehicle charging system.
Amplifier fuse keeps blowing.	The wiring is connected incorrectly or there is a short circuit. Check wiring connections.
Distorted audio.	Gain is not set properly. Check setting. Check wires for shorts or grounds. Amplifier or source unit may be defective.
Distorted audio and PROTECT INDICATOR flashes.	Short circuit in speaker or wire. Remove speaker leads one at a time to locate shorted speaker or wire, and repair.
Music lacks dynamics or "punch."	Speakers are not connected properly. Check speaker connections for proper polarity.
Engine noise—whining or clicking—in system when the engine is on.	Amplifier is picking up alternator noise. First, check ground connection on the amplifier – a loose or improper ground is one of the main causes for noise. Turn down gain. Move RCA audio cables away from power wires. Installing an alternator noise filter on power line between battery and alternator might also be necessary.

CONTENU DE LA BOÎTE

JBL Stage GT 50011

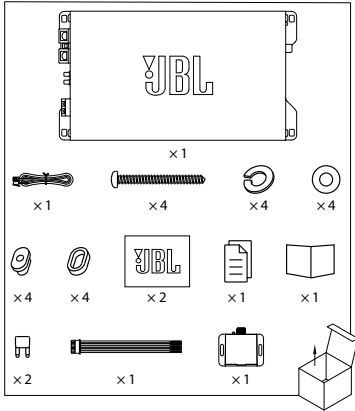

JBL Stage GT 90041

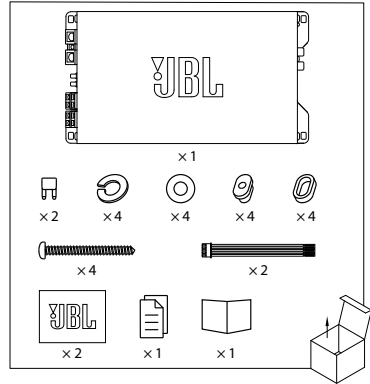

FR

JBL Stage GT 80021

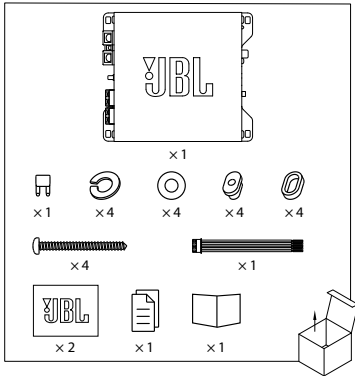

MONTAGE DE L'AMPLIFICATEUR

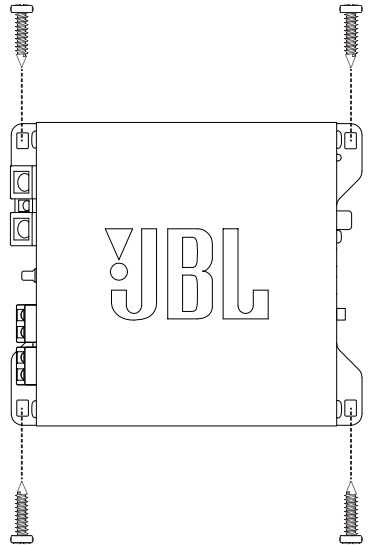

JBL Stage GT 60041

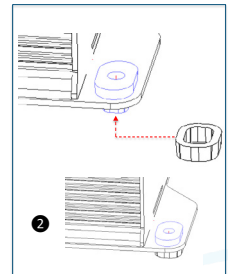
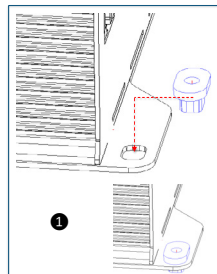
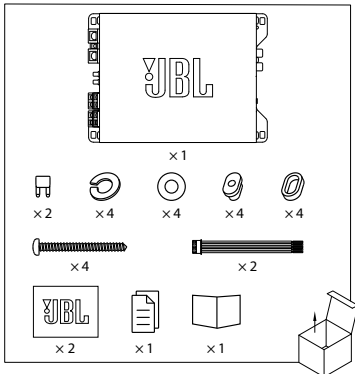

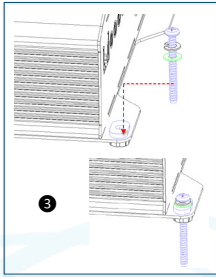

Au point de masse :

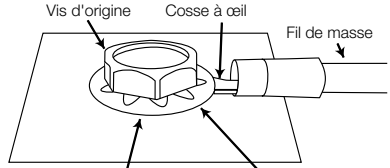

Remarque : retirez la peinture sous la cosse à œil

CÂBLAGE DU SIGNAL D'ENTRÉE

Signaux de niveaux bas des Stage GT 50011 et 80021

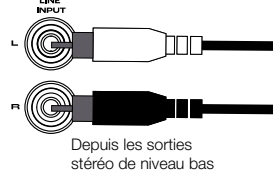

Signaux de niveaux bas des Stage GT 60041 et 90041

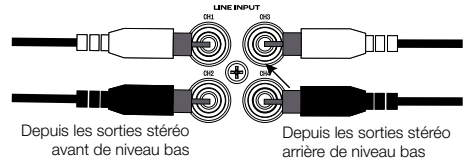

Signaux de niveaux hauts des Stage GT 50011 et 80021

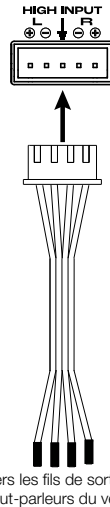

Remarque : Veillez à respecter la polarité adéquate lors de la connexion des fils des haut-parleurs du véhicule à l'adaptateur de niveau haut.

Remarque : Il est recommandé de faire toutes les connexions des câbles avant de monter l'amplificateur.

FR **IMPORTANT : Débranchez la borne négative de la batterie (-) du véhicule avant de commencer l'installation.**

- Portez toujours des lunettes de protection pour utiliser des outils.
- Choisissez un emplacement de montage sûr, sans humidité. Vérifiez les espaces des deux côtés de la surface de montage prévue. Veillez à ce que des vis ou des fils ne percent pas de canalisations de freins, de carburant ou des faisceaux de câblage, et que le cheminement des fils ne nuira pas à la sécurité de fonctionnement du véhicule. Soyez prudent lors des perçages ou des découpes dans la zone de montage.
- Choisissez un emplacement permettant une circulation d'air suffisante.
- Ne montez pas l'amplificateur avec son radiateur dessous, car ceci nuit à son refroidissement.
- Montez l'amplificateur de sorte qu'il ne soit pas endommagé par les pieds des passagers arrière ou le déplacement du chargement dans le coffre.

CÂBLAGE DE L'ALIMENTATION ET DE LA MASSE

Sur l'amplificateur :

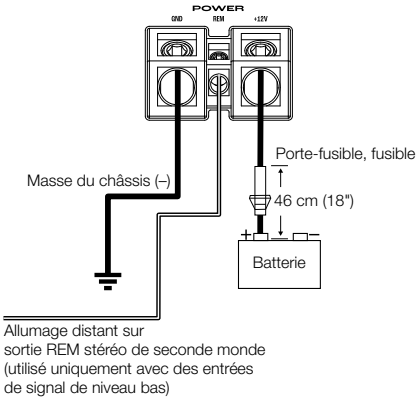

REMARQUE : Si vous utilisez des signaux d'entrée de niveau haut, vous n'avez pas besoin de connecter le fil d'allumage à distance. En mode niveau haut, l'amplificateur s'allume automatiquement lorsqu'il détecte un signal.

Calibres de fusibles recommandés :

- Stage GT 50011 : 60 A
- Stage GT 80021 : 25 A
- Stage GT 60041 : 40 A
- Stage GT 90041 : 60 A

Codage couleur standard de l'industrie automobile de seconde monte	
CH1+ (+ avant gauche)	Blanc
CH1- (- avant gauche)	Blanc/noir
CH2+ (+ avant droit)	Gris
CH2- (- avant droit)	Gris/noir

Signaux d'entrée de niveaux hauts des Stage GT 60041 et 90041

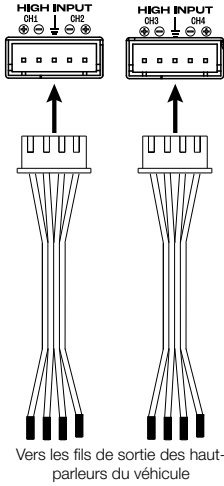

Sortie 2 canaux du Stage GT 80021

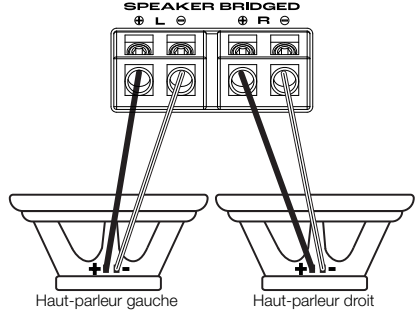

Sortie mono (pontée) du Stage GT 80021

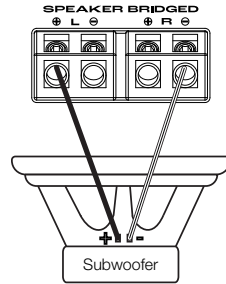

Standard de l'industrie automobile de seconde monte	
Code de couleurs	
CH1+ (+ avant gauche)	Blanc
CH1- (- avant gauche)	Blanc/noir
CH2+ (+ avant droit)	Gris
CH2- (- avant droit)	Gris/noir
CH3+ (+ arrière gauche)	Vert
CH3- (- arrière gauche)	Vert/noir
CH4+ (+ arrière droit)	Violet
CH4- (- arrière droit)	Violet/noir

CÂBLAGE DE LA SORTIE

Impédance de haut-parleur recommandée :

- 2 ohms – 4 ohms (entrées stéréo)
- 4 ohms (entrées pontées)

Sortie mono du Stage GT 50011

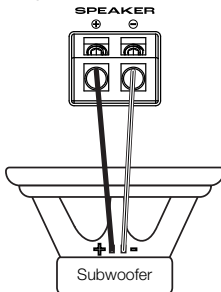

Sortie 4 canaux des Stage GT 60041 et 90041

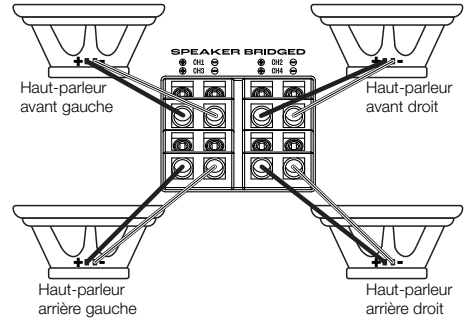

Sortie 3 canaux des Stage GT 60041 et 90041

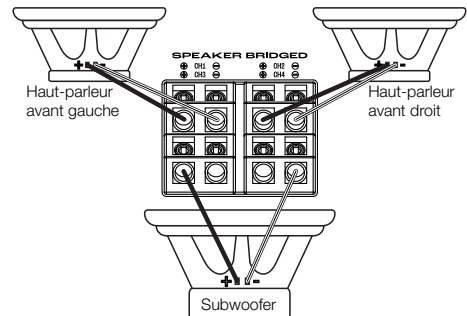

Sortie 2 canaux des Stage GT 60041 et 90041

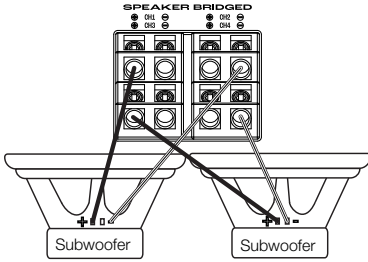

Branchement de la télécommande des graves (Stage GT 50011 uniquement)

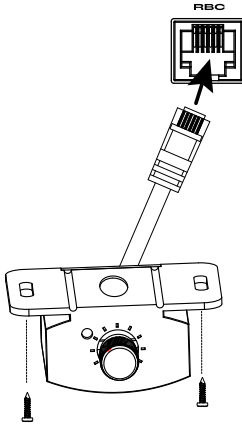

RÉGLAGE DU GAIN, DES FILTRES DE CROISEMENT ET DE L'ÉGALISATION DES GRAVES

Réglage du gain

- Démarrez avec la commande de niveau réglée sur 5 V et la commande de répartition centrée.
- Choisissez une musique que vous connaissez bien.
- Réglez le volume de votre unité principale à ¾ de sa puissance totale.
- Réglez la commande de gain dans le sens horaire, en écoutant attentivement la sortie des graves. Si vous percevez une distorsion, tournez la commande de gain dans le sens trigonométrique pour diminuer le gain.

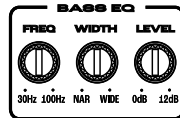
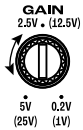

Sélection du mode de croisement

Choisissez **HPF** pour n'autoriser que les fréquences supérieures à un certain point vers vos haut-parleurs. Ce choix est recommandé si vous utilisez un subwoofer dans votre système, car il filtre les basses fréquences de vos haut-parleurs large bande.

Choisissez **LPF** pour n'autoriser que les fréquences inférieures à un certain point vers vos haut-parleurs. Recommandé si vous pontez des canaux pour alimenter un subwoofer.

Choisissez **FULL** pour autoriser toutes les fréquences vers vos haut-parleurs. Ce choix est recommandé si vous n'utilisez pas de subwoofer dans votre système.

Remarque : Le Stage GT 50011 intègre uniquement un filtre de croisement passe-bas.

Sélection de la fréquence de croisement

Choisissez le point de croisement en fonction de vos préférences d'écoute. Tournez les réglages vers la gauche pour abaisser le point de croisement et vers la droite pour l'élever. Les réglages de croisement exacts des haut-parleurs coaxiaux et des subwoofers dépendent de vos préférences d'écoute.

Sélection de l'égalisation des graves – Stage GT 80021, 60041 et 90041

Choisissez le niveau de la sortie des graves selon vos préférences d'écoute, de 0 à +12 dB. Tournez le réglage dans le sens horaire pour relever le niveau de sortie de l'égalisation des graves, et dans le sens contraire pour le baisser.

Sélection de l'égalisation des graves – Stage GT 50011 seulement

- Réglez la molette **FREQ** pour sélectionner la fréquence centrale – la fréquence primaire des graves entre 30 Hz et 100 Hz que vous souhaitez renforcer. Tournez la molette dans le sens horaire pour sélectionner une fréquence supérieure et dans le sens contraire pour sélectionner une fréquence inférieure. Votre choix dépend de vos préférences d'écoute.
- Réglez la molette **WIDTH** pour déterminer la plage des fréquences adjacentes également renforcées. Tournez la molette dans le sens horaire pour sélectionner une plage de fréquences plus large et dans le sens contraire pour sélectionner une plage plus étroite.
- Réglez la molette **LEVEL** pour sélectionner le niveau de sortie de votre signal grave, de 0 à +12 dB. Tournez le réglage dans le sens horaire pour relever le niveau de sortie, et dans le sens contraire pour le baisser.



Sélection de la phase du subwoofer – Stage GT 50011 seulement

Basculez le commutateur de phase sur 0° et 180° afin de déterminer quel réglage produit la sortie de graves la plus propre.

TÉMOIN D'ÉTAT DE L'ALIMENTATION ET DE LA PROTECTION

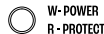

Si le témoin d'alimentation et de protection est allumé blanc, l'amplificateur est allumé et fonctionne normalement. Si le témoin est rouge et qu'aucun son n'est émis, l'amplificateur est en protection. Voir « Dépannage » pour les causes possibles.

CARACTÉRISTIQUES TECHNIQUES

	Stage GT 50011	Stage GT 80021	Stage GT 60041	Stage GT 90041
Puissance de sortie nominale sous 4 ohms	1 x 300 watts RMS	2 x 80 watts RMS	4 x 65 watts RMS	4 x 90 watts RMS
Puissance de sortie nominale sous 2 ohms	1 x 500 watts RMS	2 x 130 watts RMS	4 x 90 watts RMS	4 x 130 watts RMS
Puissance crête	1 x 1220 Watts sous 2 ohms	1 x 800 Watts sous 4 ohms	2 x 1240 Watts sous 4 ohms	2 x 1480 Watts sous 4 ohms
Puissance de sortie nominale avec pontage	S. O.	1 x 260 Watts RMS sous 4 ohms	2 x 180 Watts RMS sous 4 ohms	2 x 260 Watts RMS sous 4 ohms
Réponse en fréquence (±1 dB)	10 Hz – 320 Hz	20 Hz – 20 kHz	20 Hz – 20 kHz	20 Hz – 20 kHz
Fréquences de croisement	Passe-bas variable 32-320 Hz, 12 dB/octave	Passe-bas et haut variable 32-320 Hz, 12 dB/octave	Passe-bas et haut variable 32-320 Hz, 12 dB/octave	Passe-bas et haut variable 32-320 Hz, 12 dB/octave
Égalisation des graves	0-12 dB à 30-100 Hz, variable	0-12 dB à 45 Hz	0-12 dB à 45 Hz	0-12 dB à 45 Hz
Sensibilité d'entrée de niveau ligne	0,2 Vrms – 5,0 Vrms	0,2 Vrms – 5,0 Vrms	0,2 Vrms – 5,0 Vrms	0,2 Vrms – 5,0 Vrms
Sensibilité d'entrée de niveau haut	1,0 Vrms – 25 Vrms	1,0 Vrms – 25 Vrms	1,0 Vrms – 25 Vrms	1,0 Vrms – 25 Vrms
Rapport signal sur bruit à 1 W sous 4 ohms	> 75 dB	> 75 dB	> 75 dB	> 75 dB
DHT+B à la puissance nominale	1%	1%	1%	1%
Valeur du fusible	2 x 30 A	1 x 25 A	2 x 20 A	2 x 30 A
Tension de service	9 V – 16 V	9 V – 16 V	9 V – 16 V	9 V – 16 V
Protection	DC, OVP, UVP, OCP, OTP	DC, OVP, UVP, OCP, OTP	DC, OVP, UVP, OCP, OTP	DC, OVP, UVP, OCP, OTP
Dimensions (L x H x P)	246,9 mm x 49,5 mm x 132,5 mm (9-23/32" x 1-15/16" x 5-7/32")	156,9 mm x 49,5 mm x 132,5 mm (6-3/16" x 1-15/16" x 5-7/32")	186,9 mm x 49,5 mm x 132,5 mm (7-3/8" x 1-15/16" x 5-7/32")	236,9 mm x 49,5 mm x 132,5 mm (9-11/32" x 1-15/16" x 5-7/32")
Poids	1633 g (3,6 lb.)	1061 g (2,34 lb.)	1338 g (2,95 lb.)	1702 g (3,75 lb.)
Calibres de fils recommandés	4	8	4	4
Température de fonctionnement max. :	70 °C	70 °C	70 °C	70 °C

RÉSOLUTION DES PROBLÈMES

PROBLÈME	CAUSES ET SOLUTIONS
Aucun son et TÉMOIN D'ALIMENTATION éteint.	Aucune tension sur BATT + et/ou aux bornes REM, ou connexion de masse mauvaise ou absente. Vérifiez les tensions aux bornes de l'amplificateur avec un voltmètre.
Aucun son et clignotement du TÉMOIN DE PROTECTION toutes les 4 secondes.	Tension CC sur la sortie de l'amplificateur. L'amplificateur peut devoir être révisé ; consultez la carte de garantie jointe pour des informations sur le service.
Aucun son et clignotement des TÉMOINS D'ALIMENTATION ET DE PROTECTION.	Tension inférieure à 9 V sur la connexion à BATT +. Contrôlez le circuit de charge du véhicule.

PROBLÈME	CAUSES ET SOLUTIONS
Aucun son et TÉMOIN DE PROTECTION allumé.	L'amplificateur a surchauffé. Vérifiez que le refroidissement de l'amplificateur n'est pas empêché à l'emplacement de montage. Ou une tension supérieure à 16 V (ou inférieure à 8,5 V) est présente sur la connexion à BATT +. Contrôlez le circuit de charge du véhicule.
Le fusible de l'amplificateur fond constamment.	Le câblage est erroné ou il y a un court-circuit. Vérifiez les connexions du câblage.
Son déformé.	Le gain n'est pas réglé correctement. Vérifiez le réglage. Recherchez des court-circuits ou des masses sur les câbles. L'amplificateur ou l'appareil source peuvent être défectueux.
Son déformé et TÉMOIN DE PROTECTION clignotant.	Court-circuit dans le haut-parleur ou le fil. Débranchez un fil de haut-parleur à la fois pour localiser le haut-parleur ou le fil en court-circuit puis réparez.
La musique manque de la dynamique ou de « punch ».	Les haut-parleurs ne sont pas connectés correctement. Vérifiez la bonne polarité des connexions des haut-parleurs.
Bruit de moteur - couinement ou cliquetis - dans le système lorsque le moteur tourne.	L'amplificateur capte le bruit de l'alternateur. Vérifiez d'abord les connexions de masse de l'amplificateur - une masse lâche ou insuffisante est l'une des principales causes de bruit. Réduisez le gain. Éloignez les câbles audio RCA des fils d'alimentation. Le montage d'un filtre de bruit d'alternateur sur la ligne d'alimentation entre la batterie et l'alternateur peut également être nécessaire.

VERPACKUNGSINHALT

JBL Stage GT 50011

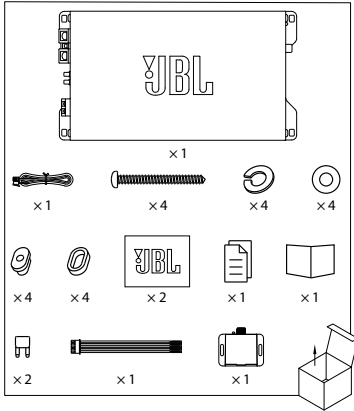

JBL Stage GT 90041

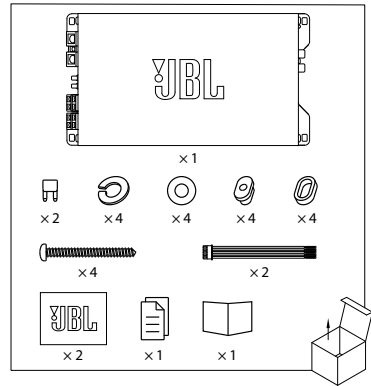

JBL Stage GT 80021

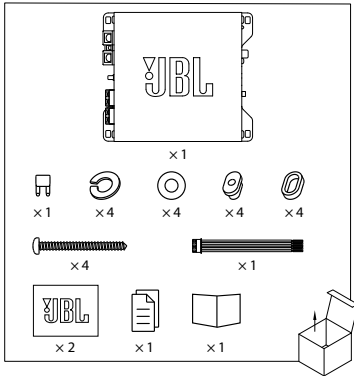

MONTAGE DES VERSTÄRKERS

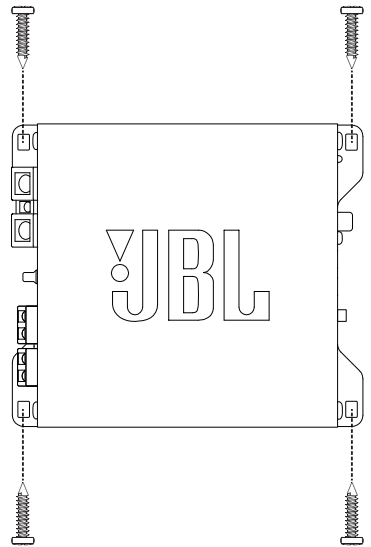

JBL Stage GT 60041

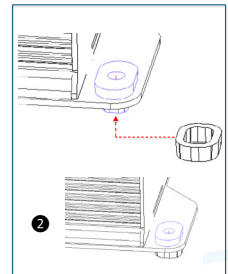
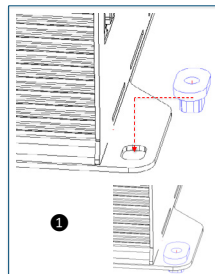
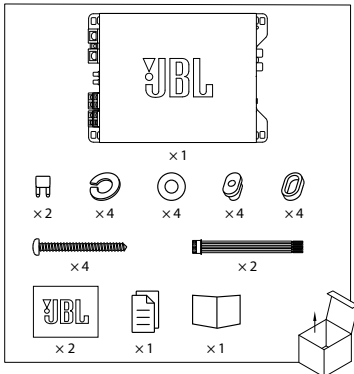

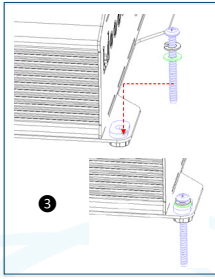

Am Masseanschluss:

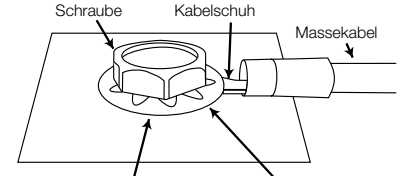

Hinweis: Jeglichen Lack unter dem Kabelschuh entfernen

VERKABELUNG FÜR EINGANGSSIGNAL

Stage GT 50011 und 80021 Niederpegelsignale

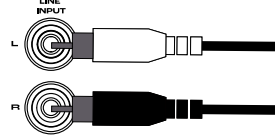

Von Stereo-Niederpegelausgängen

Stage GT 60041 und 90041 Niederpegelsignale

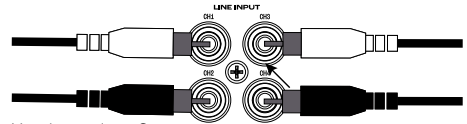

Von den vorderen Stereo-Niederpegelausgängen Von den hinteren Stereo-Niederpegelausgängen

Stage GT 50011 und 80021 Hochpegelsignale

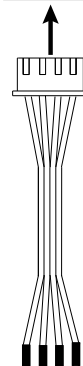
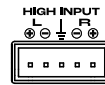

Zu den Fahrzeug-Lautsprecherausgangskabeln

Hinweis: Achte beim Anschluss der Fahrzeuglautsprecherkabel an den Hochpegeladapter auf die korrekte Polarität.

Hinweis: Es wird empfohlen, alle Kabelverbindungen herzustellen, bevor der Verstärker montiert wird.

WICHTIG: Trenne den Minus(-)-Pol der Fahrzeugbatterie vor Beginn der Installation.

- Bei der Arbeit mit Werkzeugen immer eine Schutzbrille tragen.
- Wähle einen sicheren und trockenen, vor Feuchtigkeit geschützten Montageort. Die Abstände auf beiden Seiten der vorgesehenen Montagefläche überprüfen. Achte darauf, dass Schrauben oder Kabel keine Bremsleitungen, Kraftstoffleitungen oder Kabelbäume durchstechen und dass die Kabelführung nicht den sicheren Betrieb des Fahrzeugs beeinträchtigt. Beim Bohren oder Schneiden im Montagebereich vorsichtig vorgehen.
- Einen Ort auswählen, der über eine ausreichende Luftzirkulation verfügt.
- Den Verstärker nicht mit dem Kühlkörper nach unten montieren, da dies die Konvektionskühlung beeinträchtigt.
- Montiere den Verstärker so, dass er nicht durch die Füße der Mitfahrer auf dem Rücksitz oder durch ein Verschieben der Ladung im Kofferraum beschädigt werden kann.

VERKABELUNG FÜR STROMVERSORGUNG UND MASSE

Am Verstärker:

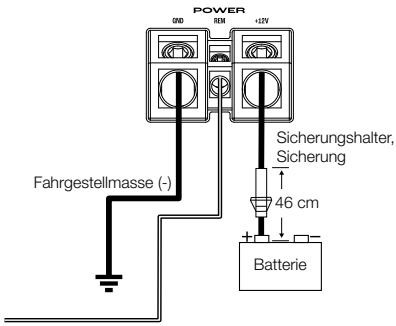

Ferneinschaltung für den Stereo-REM-Ausgang für nachträgliche Einbauten (nur bei Niederpegel-Signaleingängen verwenden)

HINWEIS: Wenn Hochpegel-Eingangssignale verwendet werden, muss die Ferneinschaltleitung nicht angeschlossen werden. Im Hochpegelmodus schaltet sich der Verstärker automatisch ein, wenn er ein Signal erkennt.

Empfohlene Sicherungswerte:

- Stage GT 50011: 60 A
- Stage GT 80021: 25 A
- Stage GT 60041: 40 A
- Stage GT 90041: 60 A

Farbcodierungs-Industrienorm für Kfz-Ersatzteilmarkt	
Kanal1+ (vorne links +)	Weiß
Kanal1- (vorne links -)	Weiß/Schwarz
Kanal2+ (vorne rechts +)	Grau
Kanal2- (vorne rechts -)	Grau/Schwarz

Stage GT 60041 und 90041 Hochpegel-Eingangssignale

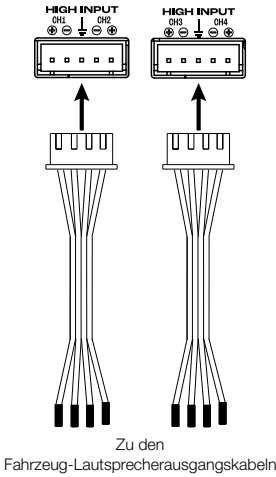

Stage GT 80021 2-Kanal-Ausgang

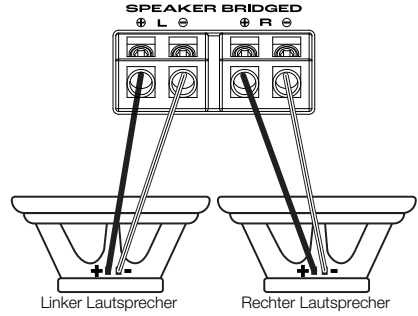

Stage GT 80021 Mono- (gebrückter) Ausgang

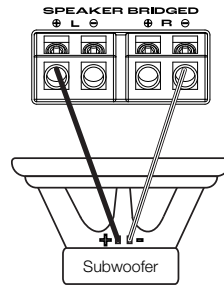

Stage GT 60041 und 90041 4-Kanal-Ausgang

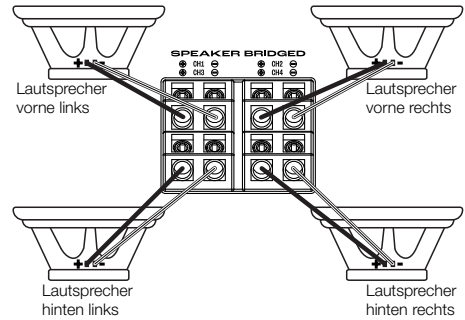

Stage GT 60041 und 90041 3-Kanal-Ausgang

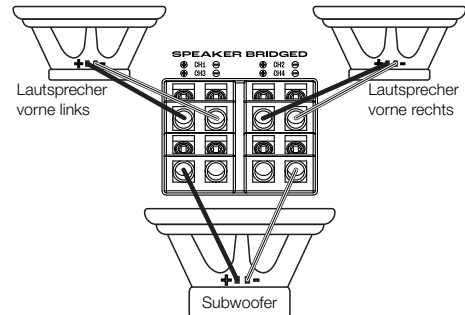

Industriernorm für Kfz-Ersatzteilmarkt	
Farbcodierung	
Kanal1+ (vorne links +)	Weiß
Kanal1- (vorne links -)	Weiß/Schwarz
Kanal2+ (vorne rechts +)	Grau
Kanal2- (vorne rechts -)	Grau/Schwarz
Kanal3+ (hinten links +)	Grün
Kanal3- (hinten links -)	Grün/Schwarz
Kanal4+ (hinten rechts +)	Violett
Kanal4- (hinten rechts -)	Violett/Schwarz

VERKABELUNG FÜR AUSGANG

Empfohlene Lautsprecherimpedanzen:

- 2 – 4 Ohm (Stereoeingänge)
- 4 Ohm (gebrückte Eingänge)

Stage GT 50011 Monoausgang

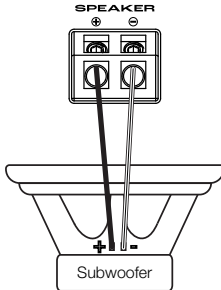

Stage GT 60041 und 90041 2-Kanal-Ausgang

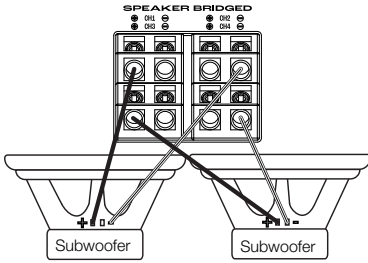

Anschluss der Bass-Fernsteuerung (nur Stage GT 50011)

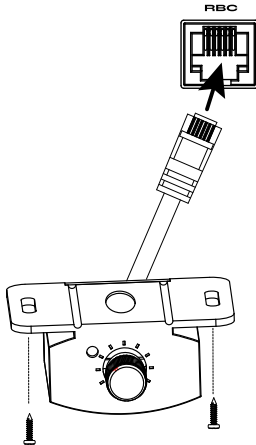

EINSTELLEN VON VORVERSTÄRKUNG, FREQUENZWEICHEN UND BASS-EQ

Einstellen der Vorverstärkung

1. Beginne mit dem Pegelregler auf 5 V, während die Frequenzweiche in Mittelstellung gedreht ist.
2. Wähle Musik, mit der du vertraut bist.
3. Drehe den Lautstärkereglers deines Hauptgeräts auf $\frac{3}{4}$ der Gesamtausgangsleistung.
4. Drehe den Vorverstärkungsregler im Uhrzeigersinn, während du gleichzeitig auf die Bässe hörst. Falls du eine Verzerrung hörst, drehe den Verstärkungsregler gegen den Uhrzeigersinn, um die Vorverstärkung zu reduzieren.

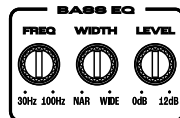

Auswahl des Frequenzweichenmodus

Wähle **HPF**, um nur Frequenzen ab einem bestimmten Wert zuzulassen, die deine Lautsprecher erreichen. Dies wird empfohlen, wenn ein Subwoofer in deinem System integriert ist, da er die Wiedergabe der tiefen Bässe übernimmt und sie nicht an die Breitbandlautsprecher weitergeleitet werden.

Wähle **LPF**, um nur Frequenzen unter einem bestimmten Wert zuzulassen, die deine Lautsprecher erreichen. Empfohlen, wenn Kanäle überbrückt werden, um einen Subwoofer zu betreiben.

Wähle **FULL**, damit alle Frequenzen deine Lautsprecher erreichen. Dies wird empfohlen, wenn kein Subwoofer im System integriert ist.

Hinweis: Der Stage GT 50011 verfügt nur über eine Tiefpass-Weiche.

Auswahl der Weichenfrequenz

Wähle den Übergangspunkt entsprechend den Hörpräferenzen. Drehe die Regler gegen den Uhrzeigersinn, um den Übergangspunkt zu senken bzw. im Uhrzeigersinn, um ihn zu erhöhen. Die genauen Frequenzweicheneinstellungen für Koaxial-Lautsprecher und Subwoofer sind von deinen persönlichen Vorlieben abhängig.

Auswählen des Bass-EQ – Stage GT 80021, 60041 und 90041

Wähle den Pegel des Bassausgangs entsprechend deinen Hörgewohnheiten, von 0 bis +12 dB. Drehe den Regler im Uhrzeigersinn, um den Bass-EQ-Ausgangspegel zu erhöhen, und gegen den Uhrzeigersinn, um ihn zu senken.

Auswählen des Bass-EQ – nur Stage GT 50011

1. Stelle den **FREQ**-Regler ein, um die Mittenfrequenz auszuwählen – die primäre Bassfrequenz zwischen 30 und 100 Hz, die verstärkt werden soll. Drehe den Regler im Uhrzeigersinn, um eine höhere Frequenz zu wählen, und gegen den Uhrzeigersinn, um eine niedrigere Frequenz zu wählen. Deine Auswahl ist von deinen Vorlieben abhängig.
2. Stelle den **WIDTH**-Regler ein, um festzulegen, wie viele benachbarte Frequenzen ebenfalls verstärkt werden. Drehe den Regler im Uhrzeigersinn, um einen breiten Frequenzbereich auszuwählen, und gegen den Uhrzeigersinn, um einen engen Bereich auszuwählen.
3. Stelle den **LEVEL**-Regler ein, um den Ausgangspegel deines Basssignals zwischen 0 und +12 dB einzustellen. Drehe den Regler im Uhrzeigersinn, um den Ausgangspegel zu erhöhen, und gegen den Uhrzeigersinn, um ihn zu senken.



Auswählen der Subwoofer-Phase – nur Stage GT 50011

Wechsle die Phase zwischen 0 und 180 Grad, um festzustellen, welche Einstellung die klarsten Bässe liefert.

STATUSANZEIGE POWER (EIN/AUS)/ PROTECT (SCHUTZ)



Wenn die Anzeige Power (Ein/Aus)/ Protect (Schutz) weiß leuchtet, ist der Verstärker eingeschaltet und funktioniert normal. Wenn die Anzeige rot leuchtet und kein Ton wiedergegeben wird, befindet sich der Verstärker im Schutzmodus. Mögliche Ursachen siehe „Fehlerbehebung“.

TECHNISCHE DATEN

	Stage GT 50011	Stage GT 80021	Stage GT 60041	Stage GT 90041
Nennausgangsleistung bei 4 Ohm	300 Watt RMS x 1	80 Watt RMS x 2	65 Watt RMS x 4	90 Watt RMS x 4
Nennausgangsleistung bei 2 Ohm	500 Watt RMS x 1	130 Watt RMS x 2	90 Watt RMS x 4	130 Watt RMS x 4
Spitzenausgangsleistung	1220 Watt x 1 bei 2 Ohm	800 Watt x 1 bei 4 Ohm	1240 Watt x 2 bei 4 Ohm	1480 Watt x 2 bei 4 Ohm
Nennausgangsleistung im gebrückten Modus	K. A.	260 Watt RMS x 1 bei 4 Ohm	180 Watt RMS x 2 bei 4 Ohm	260 Watt RMS x 2 bei 4 Ohm
Frequenzgang (±1 dB)	10 Hz – 320 Hz	20 Hz – 20 kHz	20 Hz – 20 kHz	20 Hz – 20 kHz
Trennfrequenzen	32–320 Hz variabler Tiefpass, 12 dB/Oktave	32–320 Hz variabler Hoch- und Tiefpass, 12 dB/Oktave	32–320 Hz variabler Hoch- und Tiefpass, 12 dB/Oktave	32–320 Hz variabler Hoch- und Tiefpass, 12 dB/Oktave
Bass EQ	0–12 dB bei 30–100 Hz, variabel	0–12 dB bei 45 Hz	0–12 dB bei 45 Hz	0–12 dB bei 45 Hz
Eingangsempfindlichkeit für Line-Pegel	0,2–5,0 Vrms	0,2–5,0 Vrms	0,2–5,0 Vrms	0,2–5,0 Vrms
Eingangsempfindlichkeit für Hochpegel	1,0–25 Vrms	1,0–25 Vrms	1,0–25 Vrms	1,0–25 Vrms
Rauschabstand bei 1 W und 4 Ohm	>75 dB	>75 dB	>75 dB	>75 dB
THD+N bei Nennleistung	1%	1%	1%	1%
Sicherungswert	30 A x 2	25 A x 1	20 A x 2	30 A x 2
Betriebsspannung	9 – 16 V	9 – 16 V	9 – 16 V	9 – 16 V
Schutz-	DC, OVP, UVP, OCP, OTP	DC, OVP, UVP, OCP, OTP	DC, OVP, UVP, OCP, OTP	DC, OVP, UVP, OCP, OTP
Abmessungen (B x H x T)	246,9 mm x 49,5 mm x 132,5 mm	156,9 mm x 49,5 mm x 132,5 mm	186,9 mm x 49,5 mm x 132,5 mm	236,9 mm x 49,5 mm x 132,5 mm
Gewicht	1633 g	1061 g	1338 g	1702 g
Empfohlener Kabelquerschnitt	4	8	4	4
Max. Betriebstemperatur:	70 °C	70 °C	70 °C	70 °C

FEHLERBEHEBUNG

PROBLEM	URSACHE UND ABHILFEN
Kein Ton und die POWER-ANZEIGE ist aus.	Kein Strom an den BATT+- und/oder REM-Anschlüssen, oder schlechte bzw. keine Masseverbindung. Überprüfe die Spannung an den Verstärkeranschlüssen mit einem Spannungsmessgerät.
Kein Ton und die SCHUTZANZEIGE blinkt alle 4 Sekunden.	DC-Spannung am Verstärker-Ausgang. Der Verstärker muss eventuell repariert werden. Siehe beiliegende Garantiekarte für Serviceinformationen.
Kein Ton und SCHUTZ- und POWER-ANZEIGE blinken.	Spannung unter 9 V am BATT+-Anschluss. Überprüfe das Batterieladesystem des Fahrzeugs.

PROBLEM	URSACHE UND ABHILFEN
Kein Ton und die SCHUTZANZEIGE leuchtet.	Der Verstärker ist überhitzt. Sicherstellen, dass der Verstärker am aufgestellten Standort genügend Kühlluft bekommt. Möglicherweise übersteigt die Spannung am BATT+-Anschluss 16 V (oder liegt unter 8,5 V). Überprüfe das Batterieladesystem des Fahrzeugs.
Die Sicherung des Verstärkers brennt immer wieder durch.	Die Verkabelung ist falsch angeschlossen oder ein Kurzschluss tritt auf. Überprüfe die Kabelanschlüsse.
Verzerrter Ton.	Die Vorverstärkung (Gain) ist falsch eingestellt. Einstellung überprüfen. Sicherstellen, dass keine Kurz- oder Masseschlüsse bestehen. Der Verstärker oder das Quellgerät ist evtl. defekt.
Verzerrter Ton und die SCHUTZANZEIGE blinkt.	Kurzschluss im Lautsprecher oder in der Verkabelung. Entferne die Lautsprecheranschlüsse einzeln und nacheinander, um die betroffene Komponente (Lautsprecher oder Kabel) zu identifizieren, und repariere sie.
Die Musik hat keine Dynamik oder keinen „Punch“.	Die Lautsprecher sind nicht richtig angeschlossen. Überprüfe die Anschlüsse und die entsprechenden Polaritäten.
Motorgeräusch – „Jaulen“ oder „Knacken“ – im System, wenn der Motor läuft.	Der Verstärker übernimmt die Geräusche der Lichtmaschine. Überprüfe die Masse-Anschlüsse am Verstärker – ein lockerer oder fehlerhafter Masse-Anschluss ist einer der häufigsten Gründe für externe Geräusche. Schalte das Gerät aus. Verlege die RCA-(Cinch-)Audiokabel weiter entfernt von den Stromkabeln. Die Installation eines Filters zum Herausfiltern von Lichtmaschinengeräuschen am Stromversorgungskabel zwischen der Batterie und der Lichtmaschine ist evtl. auch nötig.

CONTENIDO DE LA CAJA

JBL Stage GT 50011

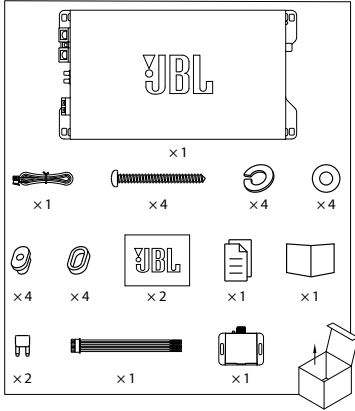

JBL Stage GT 90041

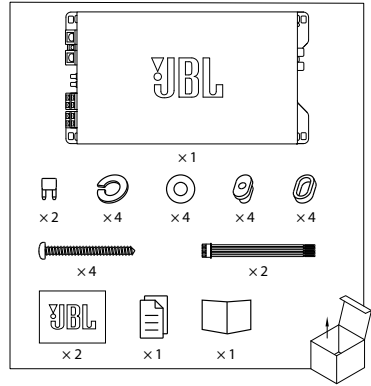

JBL Stage GT 80021

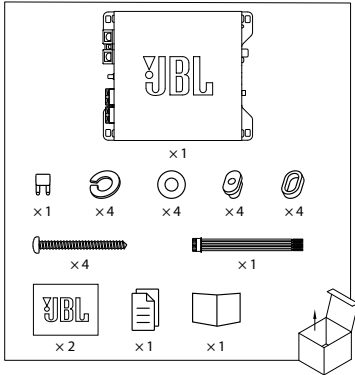

MONTAR EL AMPLIFICADOR

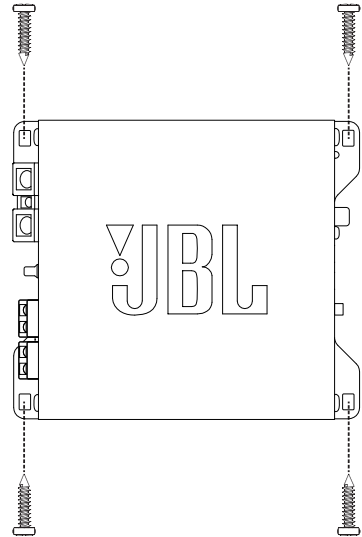

JBL Stage GT 60041

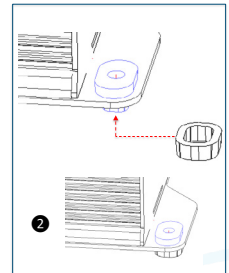
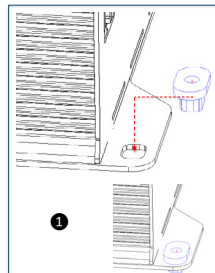
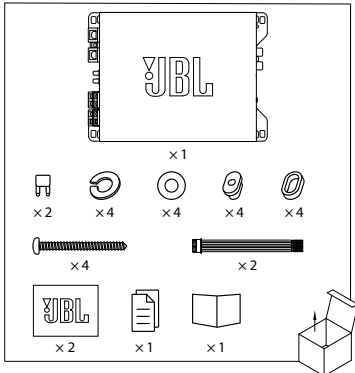

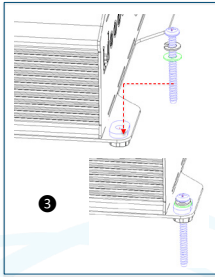

Nota: Se recomienda que efectúes todas las conexiones de cables antes de montar el amplificador.

IMPORTANTE: Desconecta el terminal negativo (-) de la batería del vehículo antes de empezar la instalación.

- Utiliza protección ocular siempre que utilices herramientas.
- Elige una ubicación de montaje segura, alejada de la humedad. Comprueba los espacios libres a ambos lados de las superficies de montaje planeada. Asegúrate de que los tornillos o cables no pinchen las líneas de freno, las líneas de combustible o los mazos de cables y que el tendido de los cables interfiera en el funcionamiento seguro del vehículo. Procede con precaución al taladrar o cortar en el área de montaje.
- Elige una ubicación con suficiente circulación de aire.
- No montes el amplificador con el sumidero de calor mirando hacia abajo, ya que esto interfiere con la refrigeración.
- Monta el amplificador de forma que no se dañe con los pies del asiento trasero del pasajero o la carga del maletero.

CABLEADO DE ALIMENTACIÓN Y TOMA DE TIERRA

En el amplificador:

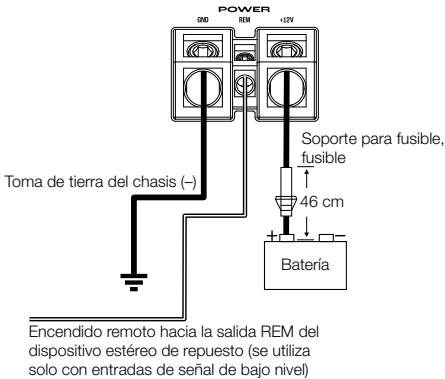

NOTA: Si estás utilizando señales de entrada de alto nivel, no tienes que conectar el cable de encendido remoto. En el modo de alto nivel, el amplificador se enciende automáticamente cuando detecta una señal.

Valores nominales de los fusibles recomendados:

- Stage GT 50011: 60 A
- Stage GT 80021: 25 A
- Stage GT 60041: 40 A
- Stage GT 90041: 60 A

En la ubicación de la toma de tierra:

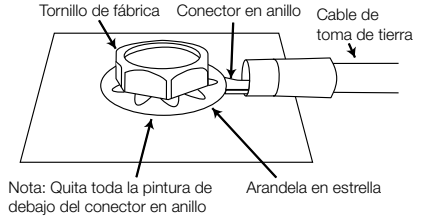

CABLEADO DE LA SEÑAL DE ENTRADA

Señales de bajo nivel del Stage GT 50011 y 80021

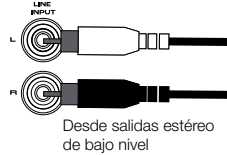

Señales de bajo nivel del Stage GT 60041 y 90041

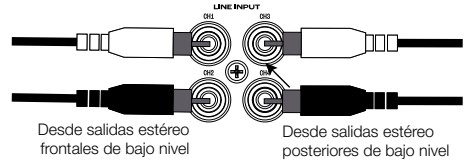

Señales de alto nivel del Stage GT 50011 y 80021

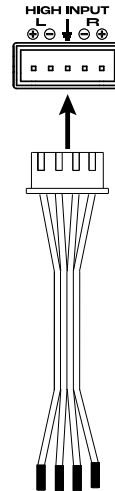

Nota: Asegúrate de tener en cuenta la polaridad adecuada al conectar los cables del altavoz del automóvil al adaptador de alto nivel.

Codificación de colores estándar del sector de repuestos para automóviles	
CH1+ (frontal izquierdo +)	Blanco
CH1- (frontal izquierdo -)	Blanco/Negro
CH2+ (frontal derecho +)	Gris
CH2- (frontal derecho -)	Gris/Negro

Señales de entrada de alto nivel del Stage GT 60041 y 90041

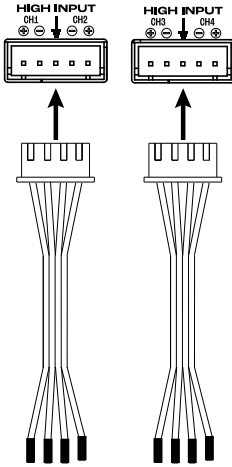

A los cables de salida de los altavoces del automóvil

Salida de dos canales del Stage GT 80021

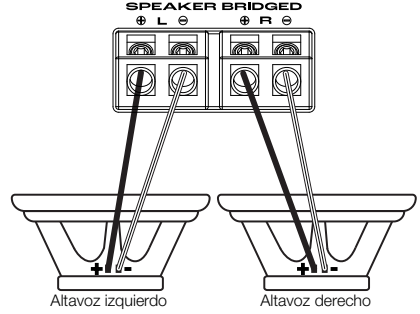

Salida mono del Stage GT 80021 (puenteada)

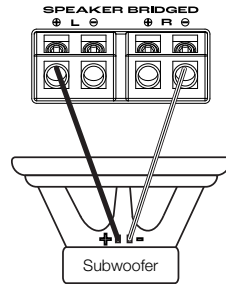

Salida de cuatro canales del Stage GT 60041 y 90041

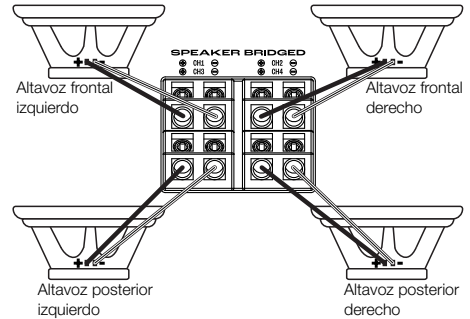

Salida de tres canales del Stage GT 60041 y 90041

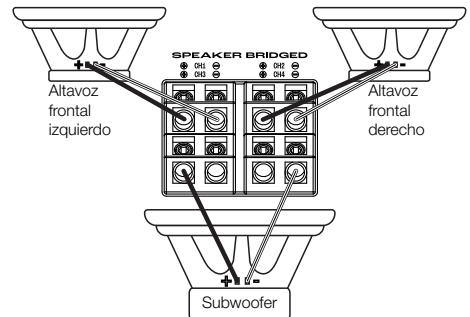

Codificación de colores estándar del sector de repuestos para automóviles	
CH1+ (frontal izquierdo +)	Blanco
CH1- (frontal izquierdo -)	Blanco/Negro
CH2+ (frontal derecho +)	Gris
CH2- (frontal derecho -)	Gris/Negro
CH3+ (posterior izquierdo +)	Verde
CH3- (posterior izquierdo -)	Verde/Negro
CH4+ (posterior derecho +)	Morado
CH4- (posterior derecho -)	Morado/Negro

CABLEADO DE SALIDA

Impedancias recomendada del altavoz:

- 2 ohm - 4 ohm (entradas estéreo)
- 4 ohm (entradas puenteadas)

Salida mono del Stage GT 50011

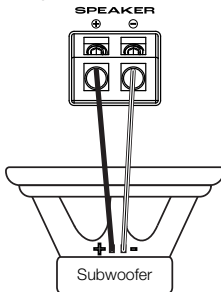

Salida de dos canales del Stage GT 60041 y 90041

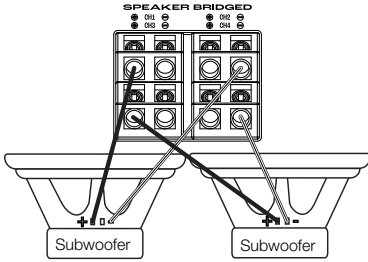

Conectar el control remoto de bajos (solo Stage GT 50011)

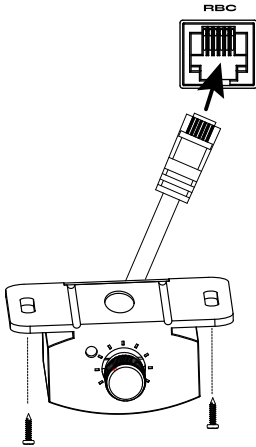

Seleccionar el modo del corte de frecuencias

Elige HPF para permitir que solo las frecuencias por encima de un punto determinado lleguen a tus altavoces. Se recomienda si estás usando un subwoofer en tu sistema, ya que mantiene la base baja de tus altavoces de gama completa.

Elige LPF para permitir que solo las frecuencias por debajo de un punto determinado lleguen a tus altavoces. Se recomienda si vas a conectar los canales para alimentar un subwoofer.

Elige FULL para permitir que todas las frecuencias lleguen a tus altavoces. Se recomienda si no estás usando un subwoofer en tu sistema.

Nota: El Stage GT 50011 solo incluye un corte de frecuencias pasabajos.

Seleccionar la frecuencia del corte de frecuencias

Elige el punto del corte de frecuencias para que se ajuste a las preferencias de escucha. Gira los diales hacia la izquierda para reducir el punto de corte de frecuencias y hacia la derecha para aumentarlo. Los ajustes de corte de frecuencia precisos para altavoces coaxiales y subwoofers dependen de las preferencias de escucha.

Seleccionar el ecualizador de bajos: Stage GT 80021, 60041 y 90041

Elige el nivel de salida de bajos en función de tus preferencias de escucha, de 0 a +12 dB. Gira el dial hacia la derecha para aumentar el nivel de salida del ecualizador de bajos y hacia la izquierda para disminuirlo.

Seleccionar el ecualizador de bajos: solo Stage GT 50011

1. Ajusta el dial **FREQ** para seleccionar la frecuencia central (la frecuencia de bajos principal entre 30 Hz y 100 Hz) que quieres mejorar. Gira el dial hacia la derecha para seleccionar una frecuencia más alta y hacia la izquierda para seleccionar una frecuencia más baja. La frecuencia que elijas depende de tus preferencias de escucha.
2. Ajusta el dial **WIDTH** para determinar cuántas frecuencias adyacentes se van a mejorar también. Gira el dial hacia la derecha para seleccionar un rango amplio de frecuencias y hacia la izquierda para seleccionar un rango estrecho.
3. Ajusta el dial **LEVEL** para seleccionar el nivel de salida de tu señal de bajos, de 0 a +12 dB. Gira el dial hacia la derecha para aumentar el nivel de salida y hacia la izquierda para disminuirlo.

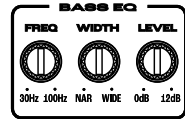

AJUSTAR LA GANANCIA, EL CORTE DE FRECUENCIAS Y EL ECUALIZADOR DE BAJOS

Ajustar la ganancia

1. Empieza con el control de nivel establecido en 5 V y el control de corte de frecuencias girado hasta la mitad.
2. Elige música que te resulte familiar.
3. Gira el control de volumen de tu unidad principal a 3/4 de la salida total.
4. Ajusta el control de ganancia hacia la derecha, escuchando atentamente a la salida de bajos. Si se oye distorsión, gira el control de ganancia hacia la izquierda para volver a reducirla.





**Seleccionar la fase del subwoofer:
solo Stage GT 50011**

Cambia la fase varias veces entre 0° y 180° para determinar qué salida proporciona unos bajos más nítidos.

INDICADOR DE ESTADO DE ENCENDIDO/ PROTECCIÓN

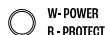

Si el indicador de encendido/protección está iluminado de color blanco, el amplificador está encendido y funcionando con normalidad. Si el indicador está en color rojo y no se reproduce ningún sonido, el amplificador está en modo de protección. Consulta "Resolución de problemas" para conocer las posibles causas.

ESPECIFICACIONES

	Stage GT 50011	Stage GT 80021	Stage GT 60041	Stage GT 90041
Salida de potencia nominal a 4 ohmios	300 W RMS x 1	80 W RMS x 2	65 W RMS x 4	90 W RMS x 4
Salida de potencia nominal a 2 ohmios	500 W RMS x 1	130 W RMS x 2	90 W RMS x 4	130 W RMS x 4
Salida máxima	1220 W x 1 a 2 ohmios	800 W x 1 a 4 ohmios	1240 W x 2 a 4 ohmios	1480 W x 2 a 4 ohmios
Potencia de salida nominal en modo puenteado	n/d	260 W RMS x 1 a 4 ohmios	180 W RMS x 2 a 4 ohmios	260 W RMS x 2 a 4 ohmios
Intervalo de frecuencias (±1 dB)	10 Hz – 320 Hz	20 Hz – 20 kHz	20 Hz – 20 kHz	20 Hz – 20 kHz
Frecuencias del corte de frecuencias	32 - 320 Hz de pasabajos variable, 12 dB/octava	32 - 320 Hz de pasaaltos y pasabajos variables, 12 dB/octava	32 - 320 Hz de pasaaltos y pasabajos variables, 12 dB/octava	32 - 320 Hz de pasaaltos y pasabajos variables, 12 dB/octava
Bass EQ	0 - 12 dB a 30 - 100 Hz, variable	0 - 12 dB a 45 Hz	0 - 12 dB a 45 Hz	0 - 12 dB a 45 Hz
Sensibilidad de las entradas de nivel de línea	0,2 Vrms – 5,0 Vrms	0,2 Vrms – 5,0 Vrms	0,2 Vrms – 5,0 Vrms	0,2 Vrms – 5,0 Vrms
Sensibilidad de las entradas de alto nivel	1,0 Vrms – 25 Vrms	1,0 Vrms – 25 Vrms	1,0 Vrms – 25 Vrms	1,0 Vrms – 25 Vrms
Relación señal-ruido (1 W a 4 ohmios)	>75 dB	>75 dB	>75 dB	>75 dB
THD+N a potencia nominal	1%	1%	1%	1%
Valor nominal del fusible	30 A x 2	25 A x 1	20 A x 2	30 A x 2
Tensión de funcionamiento	9 V – 16 V	9 V – 16 V	9 V – 16 V	9 V – 16 V
Indicador de	DC, OVP, UVP, OCP, OTP	DC, OVP, UVP, OCP, OTP	DC, OVP, UVP, OCP, OTP	DC, OVP, UVP, OCP, OTP
Dimensiones (An. x Al. x Prof.)	246,9 mm x 49,5 mm x 132,5 mm	156,9 mm x 49,5 mm x 132,5 mm	186,9 mm x 49,5 mm x 132,5 mm	236,9 mm x 49,5 mm x 132,5 mm
Peso	1633 g	1061 g	1338 g	1702 g
Calibre de cable recomendado	4	8	4	4
Temperatura máx. de funcionamiento:	70 °C	70 °C	70 °C	70 °C

RESOLUCIÓN DE PROBLEMAS

PROBLEMA	CAUSA Y SOLUCIÓN
No hay sonido y el indicador POWER (Alimentación) está apagado.	No hay tensión en los terminales BATT+ y/o REM o la conexión con tierra es defectuosa o inexistente. Comprueba las tensiones en los terminales del amplificador con VOM.
No hay sonido y el indicador PROTECT (Protección) parpadea cada 4 segundos.	Tensión de CC en la salida del amplificador. Es posible que sea necesario reparar el amplificador. Consulta la información de servicio en la tarjeta de garantía incluida.
No hay sonido y los indicadores PROTECT (Protección) y POWER (Alimentación) parpadean.	La tensión en el conector BATT+ es menor que 9 V. Comprueba el sistema de carga del vehículo.
No hay sonido y el indicador PROTECT (Protección) está encendido.	El amplificador está sobrecalentado. Comprueba que la refrigeración del amplificador no esté bloqueada en el lugar de montaje. También es posible que la tensión sea mayor que 16 V (o menor que 8,5 V) en el conector BATT+. Comprueba el sistema de carga del vehículo.
El fusible del amplificador se quema continuamente.	El cableado está mal conectado o hay un cortocircuito. Comprueba las conexiones de los cables.
Audio distorsionado.	La ganancia no está bien configurada. Comprueba el ajuste. Comprueba que no haya ningún cortocircuito ni derivación a tierra en los cables. Es posible que el amplificador o la unidad de fuente estén dañados.
Audio distorsionado y el indicador PROTECT (Protección) parpadea.	Cortocircuito en el altavoz o el cable. Quita los latiguillos de altavoz de uno en uno para localizar el cable o el altavoz cortocircuitado y repáralo.
La música carece de dinámica o "punch".	Los altavoces no están bien conectados. Comprueba la polaridad de las conexiones de los altavoces.
Ruido del motor (chirridos o chasquidos) en el sistema cuando el motor está en marcha.	El amplificador capta ruido del alternador. Comprueba las conexiones del amplificador, ya que una toma de tierra floja o deficiente es una de las causas principales del ruido ajeno en el sistema de audio. Reduce la ganancia. Aleja los cables de audio RCA de los cables de alimentación. Instala un filtro para el ruido del alternador en la línea de alimentación entre la batería y el alternador.

CONTENUTO DELLA CONFEZIONE

JBL Stage GT 50011

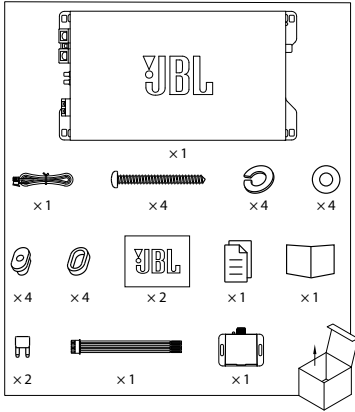

JBL Stage GT 90041

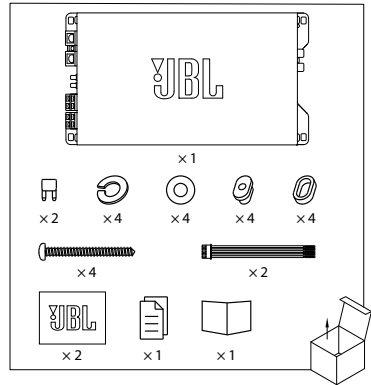

JBL Stage GT 80021

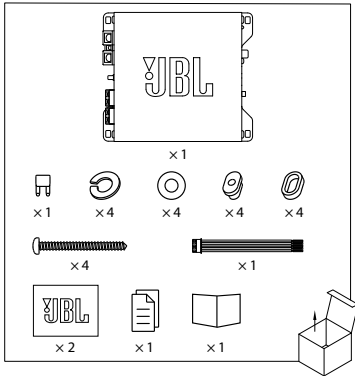

JBL Stage GT 60041

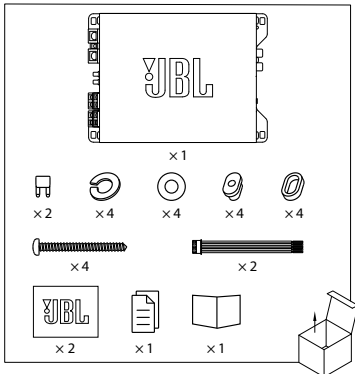

MONTAGGIO DELL'AMPLIFICATORE

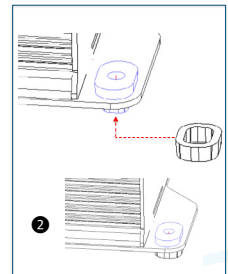
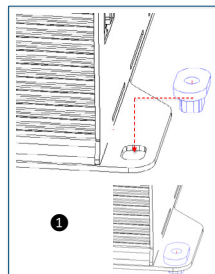
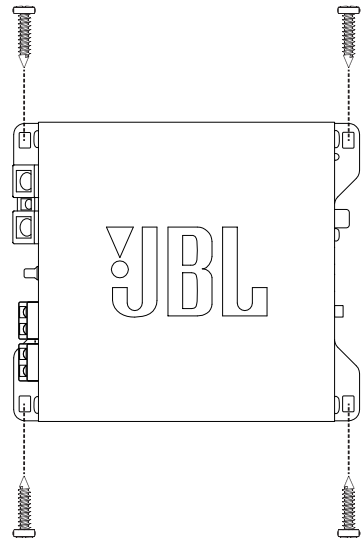

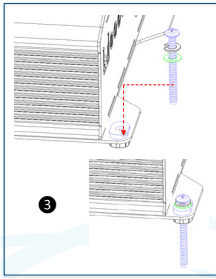

Nota: Si raccomanda di effettuare tutti i collegamenti dei cavi prima di montare l'amplificatore.

IMPORTANTE: Prima di iniziare l'installazione, scollegare il terminale negativo (-) della batteria del veicolo.

- Quando si usano gli attrezzi, indossare sempre gli occhiali di protezione.
- Scegliere una posizione di montaggio sicura, lontano dall'umidità. Controllare che vi sia spazio libero su entrambi i lati della superficie di montaggio prevista. Accertarsi che le viti o i cavi non forino le linee dei freni, le linee del carburante o i cablaggi e che l'instradamento dei cavi non interferisca con il funzionamento in sicurezza del veicolo. Prestare attenzione quando si effettuano delle perforazioni o tagli nella zona di montaggio.
- Scegliere una posizione che fornisca una sufficiente circolazione dell'aria.
- Non montare l'amplificatore con il dissipatore di calore rivolto verso il basso, poiché ciò interferisce con il raffreddamento.
- Montare l'amplificatore in modo tale che non sia danneggiato da parte dei piedi dei passeggeri dei sedili posteriori o dal carico del bagagliaio che si sposta.

CABLAGGIO PER L'ALIMENTAZIONE E LA MESSA A TERRA

Verso l'amplificatore:

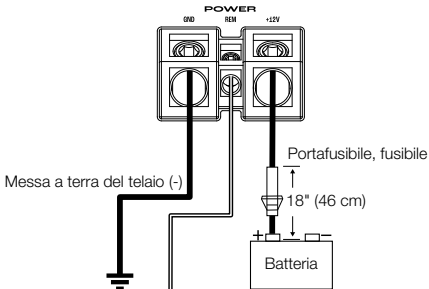

Accensione remota all'uscita REM stereo dell'autoradio aftermarket (utilizzata solo con ingressi di segnale a basso livello)

NOTA: Se si utilizzano segnali in ingresso ad alto livello, non è necessario collegare il cavo di accensione remota. In modalità ad alto livello, l'amplificatore si accende automaticamente quando rileva un segnale.

Valori nominali consigliati dei fusibili:

- Stage GT 50011: 60 A
- Stage GT 80021: 25A
- Stage GT 60041: 40A
- Stage GT 90041: 60A

Nel punto di messa a terra:

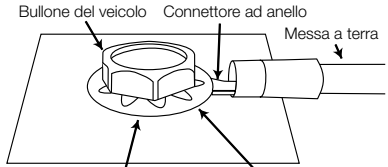

Nota: Rimuovere ogni traccia di vernice sotto il connettore ad anello

CABLAGGIO PER IL SEGNALE IN INGRESSO

Segnali a basso livello Stage GT 50011 e 80021

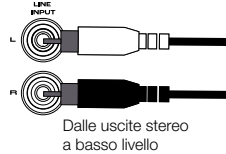

Segnali a basso livello Stage GT 60041 e 90041

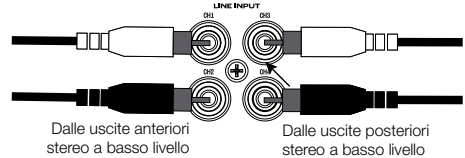

Segnali ad alto livello Stage GT 50011 e 80021

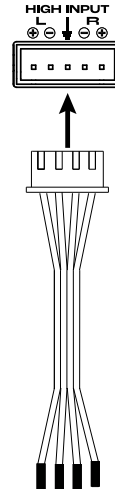

Nota: Accertarsi di rispettare la polarità corretta quando si collegano i cavi degli speaker del veicolo all'adattatore ad alto livello.

Codice colore standard per l'industria automobilistica aftermarket	
CH1+ (anteriore sinistro +)	Bianco
CH1- (anteriore sinistro -)	Bianco/Nero
CH2+ (anteriore destro +)	Grigio
CH2- (anteriore destro -)	Grigio/Nero

Segnali ad alto livello Stage GT 60041 e 90041

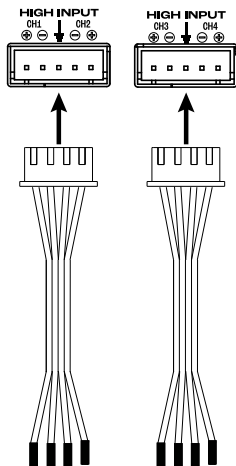

Ai cavi in uscita dei diffusori del veicolo

Codice colore standard per l'industria automobilistica aftermarket	
CH1+ (anteriore sinistro +)	Bianco
CH1- (anteriore sinistro -)	Bianco/Nero
CH2+ (anteriore destro +)	Grigio
CH2- (anteriore destro -)	Grigio/Nero
CH3+ (posteriore sinistro +)	Verde
CH3- (posteriore sinistro -)	Verde/nero
CH4+ (posteriore destro +)	Viola
CH4- (posteriore destro -)	Viola/nero

CABLAGGIO PER L'USCITA

Impedenze consigliate degli speaker:

- 2 ohm - 4 ohm (ingressi stereo)
- 4 ohm (ingressi a ponte)

Uscita mono Stage GT 50011

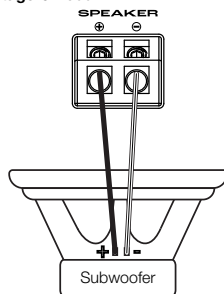

Uscita a 2 canali Stage GT 80021

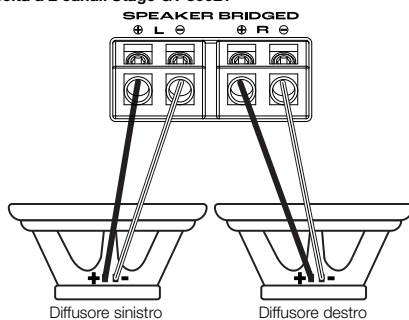

Uscita mono (a ponte) Stage GT 80021



Uscita a 4 canali Stage GT 60041 e 90041

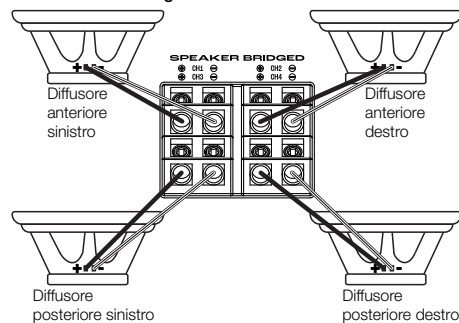

Uscita a 3 canali Stage GT 60041 e 90041

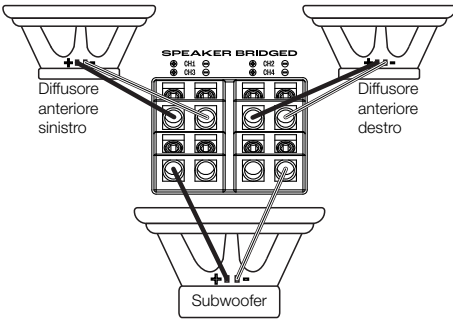

Uscita a 2 canali Stage GT 60041 e 90041

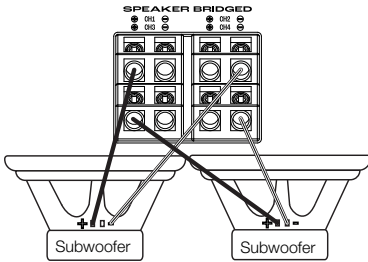

Collegamento del controller remoto dei bassi (solo Stage GT 50011)

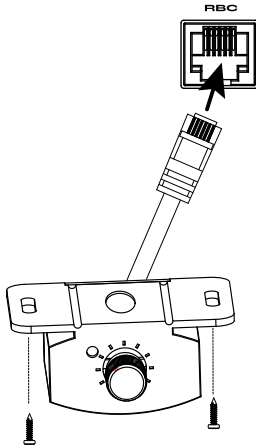

IMPOSTAZIONE DEL GUADAGNO, DEL CROSSOVER E DEL BASS EQ

Impostazione del guadagno (gain)

1. Cominciare con il controllo del livello impostato a 5 V, e con il controllo del crossover ruotato a metà.
2. Scegliere un brano musicale familiare.
3. Impostare il controllo del volume dell'autoradio a ¾ del livello massimo.
4. Regolare il controllo del guadagno in senso orario, ascoltando attentamente la riproduzione dei bassi. Se il suono è distorto, ruotare il controllo del guadagno in senso antiorario per ridurre il guadagno.



Sceita della modalità del crossover

Scegliere **HPF** per consentire solo alle frequenze al di sopra di un certo punto di raggiungere i diffusori. Impostazione consigliata se nel sistema si utilizza un subwoofer, in quanto vengono inviati pochi bassi ai diffusori full-range.

Scegliere **LPF** per consentire solo alle frequenze al di sotto di un certo punto di raggiungere i diffusori. Consigliato se si stanno collegando i canali a ponte per pilotare un subwoofer.

Scegliere **FULL** per consentire a tutte le frequenze di raggiungere i diffusori. Consigliato se non si utilizza un subwoofer nel sistema.

Nota: Lo Stage GT 50011 è dotato solo di un crossover passa-basso.



Sceita della frequenza del crossover

Scegliere il punto di crossover in base alle preferenze di ascolto. Girare le ghiera in senso antiorario per abbassare il punto di frequenza del crossover ed in senso orario per alzare il punto di frequenza. L'impostazione perfetta del crossover per gli speaker coassiali ed i subwoofer, in ultima istanza è comunque legata ai gusti personali dell'ascoltatore.



Selezione del Bass EQ – Stage GT 80021, 60041, e 90041

Scegliere il livello di uscita dei bassi in base alle preferenze di ascolto, da 0 a +12 dB. Ruotare la ghiera in senso orario per aumentare il livello di uscita del Bass EQ e in senso antiorario per abbassarlo.



Selezione del Bass EQ – solo Stage GT 50011

1. Regolare la ghiera **FREQ** per selezionare la frequenza centrale, ovvero la frequenza primaria dei bassi compresa tra 30 Hz e 100 Hz che si desidera migliorare. Ruotare la ghiera in senso orario per selezionare una frequenza più alta e in senso antiorario per selezionare una frequenza più bassa. La frequenza da scegliere dipende dai propri gusti personali.
2. Regolare la ghiera **WIDTH** per determinare inoltre quante frequenze adiacenti sono da migliorare. Ruotare la ghiera in senso orario per selezionare un'ampia gamma di frequenze e in senso antiorario per selezionare una gamma ristretta.
3. Regolare la ghiera **LEVEL** per selezionare il livello di uscita del segnale dei bassi, da 0 a +12 dB. Ruotare la ghiera in senso orario per aumentare il livello di uscita e in senso antiorario per abbassarlo.

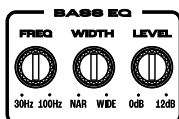

Selezione della fase del subwoofer – solo Stage GT 50011

Spostare il controllo della fase in avanti e indietro fra 0° e 180° per determinare quale impostazione fornisce una migliore riproduzione delle basse frequenze.

SPIA STATO ALIMENTAZIONE/PROTEZIONE

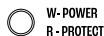

Se la spia di alimentazione/protezione è accesa in bianco, l'amplificatore è acceso e funziona normalmente. Se la spia è rossa e non viene riprodotto alcun suono, l'amplificatore è in modalità protezione. Per le possibili cause, vedere "risoluzione dei problemi".

SPECIFICHE

	Stage GT 50011	Stage GT 80021	Stage GT 60041	Stage GT 90041
Potenza nominale in uscita @ 4 ohm	300 watt RMS x 1	80 watt RMS x 2	65 watt RMS x 4	90 watt RMS x 4
Potenza nominale in uscita @ 2 ohm	500 watt RMS x 1	130 watt RMS x 2	90 watt RMS x 4	130 watt RMS x 4
Potenza di picco	1220 watt x 1 @ 2 ohm	800 watt x 1 @ 4 ohm	1240 watt x 2 @ 4 ohm	1480 watt x 2 @ 4 ohm
Potenza nominale in uscita in modalità a ponte	n/d	260 watt RMS x 1 @ 4 ohm	180 watt RMS x 2 @ 4 ohm	260 watt RMS x 2 @ 4 ohm
Risposta in frequenza (±1 dB)	10 Hz - 320 Hz	20 Hz - 20 kHz	20 Hz - 20 kHz	20 Hz - 20 kHz
Frequenze del Crossover	32-320 Hz passa basso variabile, 12 dB/ottava	32-320 Hz passa-alto e passa-basso variabili, 12 dB/ottava	32-320 Hz passa-alto e passa-basso variabili, 12 dB/ottava	32-320 Hz passa-alto e passa-basso variabili, 12 dB/ottava
EQ Bassi	0-12 dB @ 30-100 Hz, variabile	0-12 dB @ 45 Hz	0-12 dB @ 45 Hz	0-12 dB @ 45 Hz
Sensibilità dell'ingresso a livello-linea	0,2 Vrms – 5,0 Vrms	0,2 Vrms – 5,0 Vrms	0,2 Vrms – 5,0 Vrms	0,2 Vrms – 5,0 Vrms
Sensibilità dell'ingresso ad alto livello	1,0 Vrms – 25 Vrms	1,0 Vrms – 25 Vrms	1,0 Vrms – 25 Vrms	1,0 Vrms – 25 Vrms
Rapporto segnale-rumore a 1 W @ 4 ohm	>75 dB	>75 dB	>75 dB	>75 dB
THD+N @ potenza nominale	1%	1%	1%	1%
Valore nominale del fusibile	30 A x 2	25 A x 1	20 A x 2	30 A x 2
Tensione di funzionamento	9 V – 16 V	9 V – 16 V	9 V – 16 V	9 V – 16 V
Protezione	DC, OVP, UVP, OCP, OTP	DC, OVP, UVP, OCP, OTP	DC, OVP, UVP, OCP, OTP	DC, OVP, UVP, OCP, OTP
Dimensioni (L x A x P)	9-23/32" x 1-15/16" x 5-7/32" (246,9 mm x 49,5 mm x 132,5 mm)	6-3/16 x 1-15/16" x 5-7/32" (156,9 mm x 49,5 mm x 132,5 mm)	7-3/8 x 1-15/16" x 5-7/32" (186,9 mm x 49,5 mm x 132,5 mm)	9-11/32 x 1-15/16" x 5-7/32" (236,9 mm x 49,5 mm x 132,5 mm)
Peso	1633 g (3,6 lb)	1061 g (2,34 lb)	1338 g (2,95 lb)	1702 g (3,75 lb)
Sezione raccomandata dei cavi	4	8	4	4
Temperatura d'esercizio mas.:	70°C	70°C	70°C	70°C

RISOLUZIONE DEI PROBLEMI

PROBLEMA	CAUSA E SOLUZIONE
Assenza di suono e la SPIA di ALIMENTAZIONE è spenta.	Nessuna tensione ai terminali BATT+ e/o REM, o cattivo o nessun collegamento a terra. Controllare la tensione ai terminali dell'amplificatore con un VOM (Volt/Ohm Meter).
Assenza di suono e la SPIA di PROTEZIONE lampeggia ogni 4 secondi.	Tensione continua (DC) in uscita dall'amplificatore. L'amplificatore potrebbe avere bisogno di assistenza; fare riferimento alla scheda di garanzia allegata per informazioni sul servizio di assistenza.
Assenza di suono e le SPIE di PROTEZIONE e ALIMENTAZIONE sono accese.	Tensione inferiore a 9 V sul terminale BATT+. Controllare il sistema di ricarica del veicolo.
Assenza di suono e la SPIA di PROTEZIONE è accesa.	L'amplificatore è surriscaldato. Assicurarsi che il raffreddamento dell'amplificatore non sia ostacolato nella posizione di montaggio. Oppure, potrebbe essere presente una tensione superiore a 16 V (o inferiore a 8,5 V) sul morsetto BATT+. Controllare il sistema di ricarica del veicolo.
Un fusibile dell'amplificatore si è bruciato.	Il cablaggio è collegato in modo non corretto o è presente un corto circuito. Controllare i collegamenti dei cavi.
Suono distorto.	Il guadagno non è regolato correttamente. Controllare l'impostazione. Controllare la presenza di corto circuiti sui cavi. L'amplificatore o la sorgente potrebbero essere difettosi.
Suono distorto e la SPIA di PROTEZIONE lampeggia.	Corto circuito su un diffusore o su un cavo. Rimuovere i terminali degli altoparlanti uno alla volta per individuare il diffusore o il cavo in corto, e ripararlo.
La riproduzione musicale manca di dinamica o di "punch".	Gli speaker non sono collegati correttamente. Controllare la corretta polarità dei collegamenti degli altoparlanti.
Rumore del motore - continuo o intermittente - nel sistema quando il motore è acceso.	L'amplificatore è disturbato dall'alternatore. Innanzitutto, controllare i collegamenti a terra dell'amplificatore - una messa a terra poco serrata o impropria è una delle principali cause di rumori estranei. Abbassare il guadagno. Spostare i cavi audio RCA lontano dai cavi di alimentazione. Potrebbe inoltre essere necessario installare un filtro antirumore per l'alternatore sulla linea elettrica tra la batteria e l'alternatore.

O QUE ESTÁ INCLUÍDO

JBL Stage GT 50011

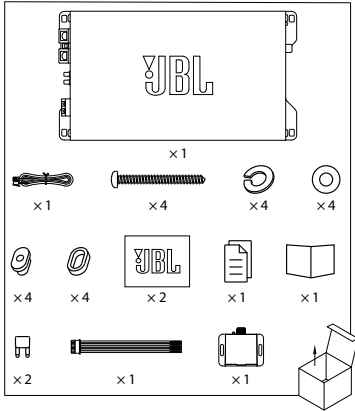

JBL Stage GT 90041

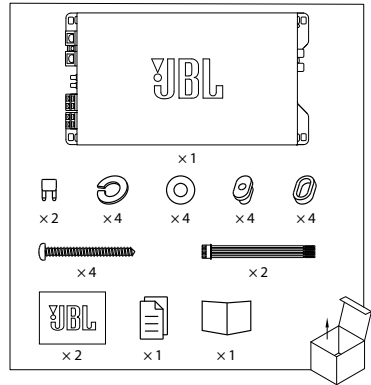

JBL Stage GT 80021

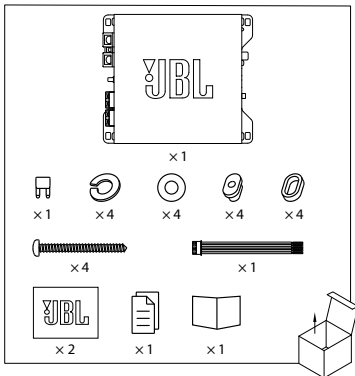

INSTALAR O AMPLIFICADOR

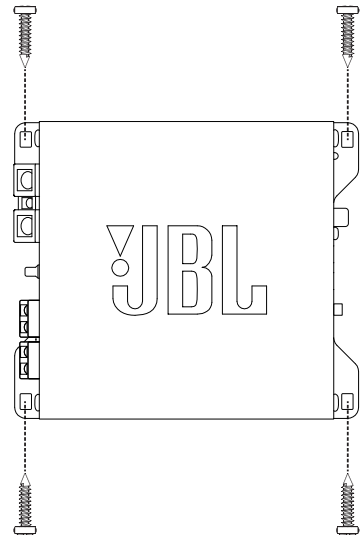

JBL Stage GT 60041

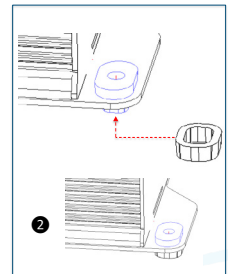
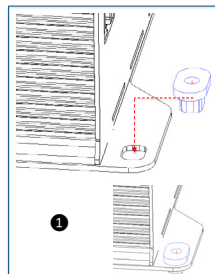
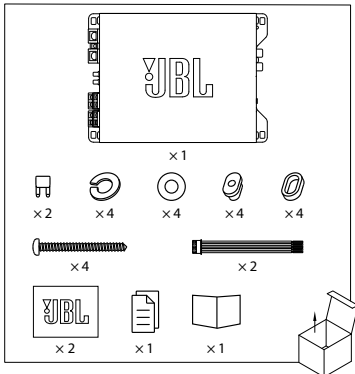

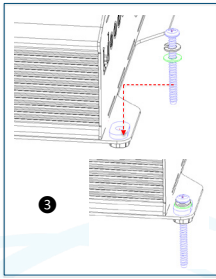

Nota: Recomendamos fazer todas as ligações de fios antes de instalar o amplificador.

IMPORTANTE: Desligue o terminal negativo (-) da bateria do veículo antes de começar a instalação.

- Use sempre proteção para os olhos ao utilizar as ferramentas.
- Escolha um local de instalação seguro, sem humidade. Verifique os espaços nos dois lados de uma superfície de instalação planeada. Certifique-se de que os parafusos ou fios não perfurem as linhas do travão, as linhas de combustível ou os chicotes de cabos e que a orientação do fio não interfira com a operação segura do veículo. Tenha cuidado ao perfurar ou cortar a área de instalação.
- Escolha um local que ofereça uma boa circulação de ar.
- Não instale o amplificador com o dissipador de calor voltado para baixo, uma vez que interfere com o arrefecimento.
- Instale o amplificador de modo que não seja danificado pelos pés dos passageiros do banco de trás ou pela troca de carga na bagageira.

CABLAGEM PARA ALIMENTAÇÃO E LIGAÇÃO À TERRA

No amplificador:

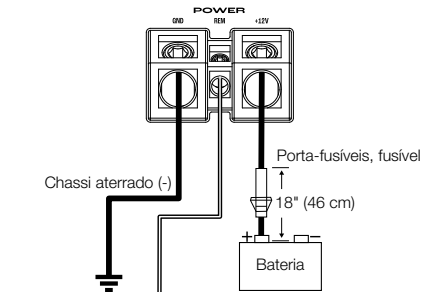

Ativação remota para a saída de REM estéreo pós-vendas (utilizada somente com entradas de sinal de baixo nível)

NOTA: Se estiver a utilizar sinais de entrada de alto nível, não é necessário ligar o fio de acionamento remoto. No modo de alto nível, o amplificador liga automaticamente quando deteta um sinal.

Classificações recomendadas para o fusível:

- Stage GT 50011: 60 A
- Stage GT 80021: 25 A
- Stage GT 60041: 40 A
- Stage GT 90041: 60 A

Localizado no chão:

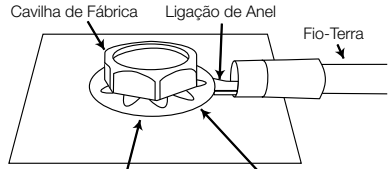

Nota: Remova qualquer pintura por baixo da ligação de anel

CABLAGEM PARA SINAL DE ÁUDIO

Sinais de baixo nível do Stage GT 50011 e 80021

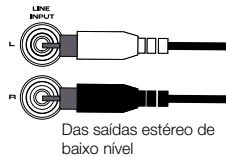

Das saídas estéreo de baixo nível

Sinais de baixo nível do Stage GT 60041 e 90041

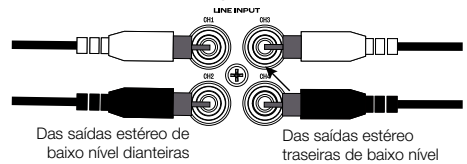

Das saídas estéreo de baixo nível dianteiras

Das saídas estéreo traseiras de baixo nível

Sinais de alto nível do Stage GT 50011 e 80021

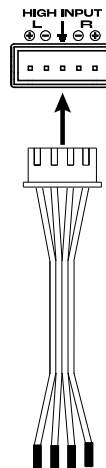

Para os fios de saída das colunas do veículo há de

Nota: Certifique-se de observar a polaridade correta ao ligar as colunas do veículo no adaptador de alto nível.

Codificação de Cores Padrão da Indústria Pós-Vendas de Carros	
CH1+ (Frontal Esquerdo +)	Branco
CH1- (Frontal Esquerdo -)	Branco/Preto
CH2+ (Frontal Direito +)	Cinza
CH2- (Frontal Direito -)	Cinza/Preto

Sinais de entrada de alto nível do Stage GT 60041 e 90041

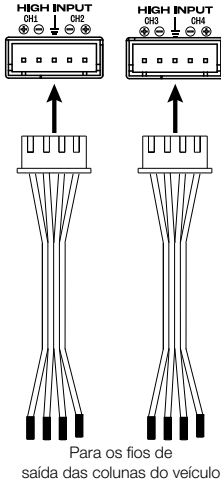

Saída 2 canais do Stage GT 80021

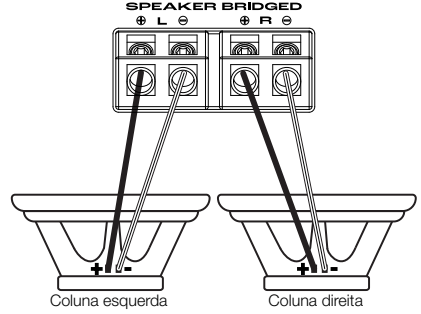

Saída mono (com ligação) do Stage GT 80021

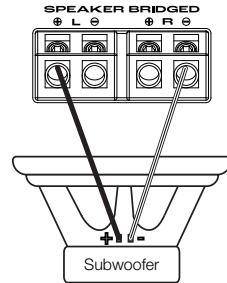

Padrão da Indústria Pós-Vendas de Carros	
Codificação por Cor	
CH1+ (Frontal Esquerdo +)	Branco
CH1- (Frontal Esquerdo -)	Branco/Preto
CH2+ (Frontal Direito +)	Cinza
CH2- (Frontal Direito -)	Cinza/Preto
CH3+ (Traseiro Esquerdo +)	Verde
CH3- (Traseiro Esquerdo -)	Verde/Preto
CH4+ (Traseiro Direito +)	Roxo
CH4- (Traseiro Direito -)	Roxo/ Preto

CABEAMENTO PARA SAÍDA

Impedâncias recomendadas da coluna:

- 2 ohm – 4 ohm (entradas estéreo)
- 4 ohm (entradas ligadas)

Saída mono do Stage GT 50011

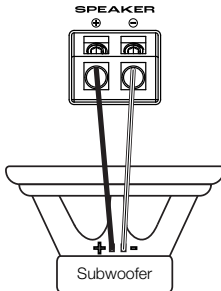

Saída 4 canais do Stage GT 60041 e 90041

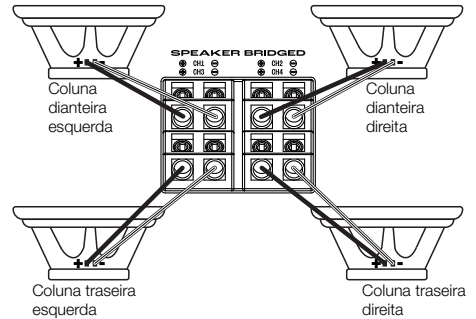

Saída 3 canais do Stage GT 60041 e 90041

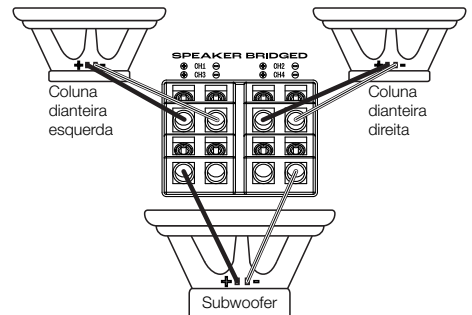

Saída 2 canais do Stage GT 60041 e 90041

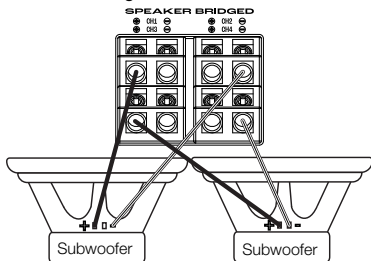

Ligar o controlador de graves remoto (somente o Stage GT 50011)

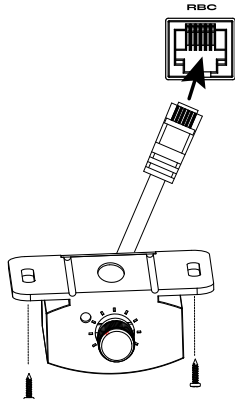

Selecionar a frequência crossover

Selecione o ponto de crossover para se adequar às preferências de escuta. Gire os manipuladores em sentido anti-horário para baixar o ponto de crossover e em sentido horário para aumentar o ponto de crossover. As definições exatas do crossover para colunas e subwoofers coaxiais dependem de suas preferências de escuta.

Selecionar a EQ de Graves – Stage GT 80021, 60041 e 90041

Selecione o nível da saída de graves de acordo com as suas preferências de escuta, de 0 a +12 dB. Gire o manipulador em sentido horário para aumentar o nível de saída de EQ de Graves e em sentido anti-horário para baixá-lo.

Selecionar a EQ de Graves – Somente Stage GT 50011

1. Ajuste o manipulador FREQ para selecionar a frequência central - a frequência de graves principal entre 30 Hz e 100 Hz que deseja aprimorar. Gire o manipulador em sentido horário para selecionar uma frequência mais alta e em sentido anti-horário para selecionar uma frequência mais baixa. A sua seleção depende de suas preferências de escuta.
2. Ajuste o manipulador de WIDTH para selecionar o nível de saída de seu sinal de graves, de 0 até +12 dB. Gire o manipulador em sentido horário para aumentar o nível de saída e em sentido anti-horário para baixá-lo.
3. Ajuste o manipulador de LEVEL para selecionar o nível de saída de seu sinal de graves, de 0 até +12 dB. Gire o manipulador em sentido horário para aumentar o nível de saída e em sentido anti-horário para baixá-lo.

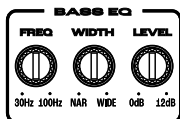

DEFINIR GANHO, CROSSOVER E EQ DE GRAVES

Definir o ganho

1. Comece com a definição do controle de nível em 5 V e o controle de crossover na posição central.
2. Selecione uma música conhecida.
3. Deixe o controle de volume de sua unidade principal a 3/4 de sua saída total.
4. Ajuste o controle de ganho em sentido horário, ouvindo atentamente a saída de graves. Se ouvir distorção, rode o controle de ganho em sentido anti-horário para diminuir o ganho.



Selecionar o modo crossover

Selecione **HPF** para permitir somente frequências acima de um determinado ponto para alcançar as colunas. Recomendado se estiver a utilizar um subwoofer no sistema, logo que ele mantém graves baixos vindos das colunas de ampla faixa.

Selecione **LPF** para permitir somente frequências abaixo de um determinado ponto para alcançar as colunas. Recomendado se estiver a ligar canais para alimentar um subwoofer.

Selecione **FULL** para permitir que todas as frequências alcancem as colunas. Recomendado se não estiver a utilizar um subwoofer no sistema.

Nota: O Stage GT 50011 apresenta somente um crossover de low-pass.



Selecionar a fase de subwoofer – Somente Stage GT 50011

Mude a fase para a frente e para trás, entre 0° e 180° para determinar qual definição fornece a saída de graves mais nítida.

INDICADOR DE STATUS DE ENERGIA/ PROTEÇÃO

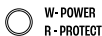

Se o indicador de energia/proteção acender em branco, o amplificador está ligado e a funcionar normalmente. Se o indicador estiver vermelho e nenhum som estiver em reprodução, o amplificador está no modo de proteção. Veja "Resolução de Problemas" para as possíveis causas.

ESPECIFICAÇÕES

	Stage GT 50011	Stage GT 80021	Stage GT 60041	Stage GT 90041
Saída de potência nominal @ 4 ohms	300 watts RMS x 1	80 watts RMS x 2	65 watts RMS x 4	90 watts RMS x 4
Saída de potência nominal @ 2 ohms	500 watts RMS x 1	130 watts RMS x 2	90 watts RMS x 4	130 watts RMS x 4
Saída máxima	1220 watts x 1 @ 2 ohms	800 watts x 1 @ 4 ohms	1240 watts x 2 @ 4 ohms	1480 watts x 2 @ 4 ohms
Saída de potência nominal no modo de ligação	n/a	260 watts RMS x 1 @ 4 ohms	180 watts RMS x 2 @ 4 ohms	260 watts RMS x 2 @ 4 ohms
Resposta em frequência (±1 dB)	10 Hz – 320 Hz	20 Hz – 20 kHz	20 Hz – 20 kHz	20 Hz – 20 kHz
Frequências de crossover	Low-pass variável de 32-320 Hz, 12 dB/oitava	High- e low-pass variável de 32-320 Hz, 12 dB/oitava	High- e low-pass variável de 32-320 Hz, 12 dB/oitava	High- e low-pass variável de 32-320 Hz, 12 dB/oitava
EQ Graves	0-12 dB @ 30-100 Hz, variável	0-12 dB @ 45 Hz	0-12 dB @ 45 Hz	0-12 dB @ 45 Hz
Sensibilidade de entrada de nível de linha	0,2 Vrms – 5,0 Vrms	0,2 Vrms – 5,0 Vrms	0,2 Vrms – 5,0 Vrms	0,2 Vrms – 5,0 Vrms
Sensibilidade de entrada de alto nível	1,0 Vrms – 25 Vrms	1,0 Vrms – 25 Vrms	1,0 Vrms – 25 Vrms	1,0 Vrms – 25 Vrms
Relação sinal-ruído a 1 W @ 4 ohms	>75 dB	>75 dB	>75 dB	>75 dB
THD+N @ potência nominal	1%	1%	1%	1%
Valor nominal do fusível	30 A x 2	25 A x 1	20 A x 2	30 A x 2
Tensão elétrica em funcionamento	9 V – 16 V	9 V – 16 V	9 V – 16 V	9 V – 16 V
Proteção	CC, OVP, UVP, OCP, OTP	CC, OVP, UVP, OCP, OTP	CC, OVP, UVP, OCP, OTP	CC, OVP, UVP, OCP, OTP
Dimensões (L x A x P)	9-23/32" x 1-15/16" x 5-7/32" (246,9 mm x 49,5 mm x 132,5 mm)	6-3/16 x 1-15/16" x 5-7/32" (156,9 mm x 49,5 mm x 132,5 mm)	7-3/8 x 1-15/16" x 5-7/32" (186,9 mm x 49,5 mm x 132,5 mm)	9-11/32 x 1-15/16" x 5-7/32" (236,9 mm x 49,5 mm x 132,5 mm)
Peso	1633 g (3,6 lb.)	1061 g (2,34 lb.)	1338 g (2,95 lb.)	1702 g (3,75 lb.)
Calibre do cabo recomendado	4	8	4	4
Temperatura máxima de funcionamento:	70°C	70°C	70°C	70°C

PT

RESOLUÇÃO DE PROBLEMAS

PROBLEMA	CAUSA E SOLUÇÃO
Sem áudio e o INDICADOR DE ENERGIA está desligado.	Não há tensão elétrica nos terminais BATT+ e/ou REM, má ligação ou sem ligação à terra. Verifique as tensões elétricas nos terminais do amplificador com VOM.
Sem áudio e o INDICADOR DE PROTEÇÃO pisca a cada 4 segundos.	Tensão DC na saída do amplificador. O amplificador pode precisar de manutenção; consulte o cartão de garantia incluído para obter informações sobre como obter assistência técnica.
Sem áudio e os INDICADORES DE PROTEÇÃO e ENERGIA piscam.	Tensão menor que 9 V na ligação BATT+. Verifique o sistema de carregamento do veículo.
Sem áudio e o INDICADOR DE PROTEÇÃO está ligado.	O amplificador está sobreaquecido. Verifique se a refrigeração do amplificador não está bloqueada no local de instalação. Ou pode haver tensão elétrica superior a 16 V (ou inferior a 8,5 V) na ligação BATT+. Verifique o sistema de carregamento do veículo.
O fusível do amplificador continua a queimar.	A cablagem está ligada incorretamente ou há um curto-circuito. Verifique as ligações da cablagem.
Áudio distorcido.	O ganho não está definido corretamente. Verifique a definição. Verifique os fios quanto a curto-circuitos ou ligação à terra. O amplificador ou a unidade de fonte pode estar com defeito.
Distorção de áudio e o INDICADOR DE PROTEÇÃO pisca.	Curto-circuito na coluna ou fio. Retire os fios da coluna um de cada vez para localizar a coluna ou fio com curto-circuito e repare.
A música carece de dinâmica ou "intensidade".	As colunas não estão ligadas corretamente. Verifique a polaridade correta das ligações da coluna.
Ruído do motor - gemido ou estalidos - no sistema quando o motor está ligado.	O amplificador está a captar o ruído do alternador. Primeiro, verifique a ligação à terra no amplificador - uma ligação à terra incorreta ou solta é uma das principais causas de ruído. Baixe o ganho. Afaste os cabos de áudio RCA dos fios de energia. Também pode ser necessária a instalação de um filtro de ruído do alternador na linha de alimentação entre a bateria e o alternador.

JBL Stage GT 50011、80021、60041 和 90041 功放

产品清单

JBL Stage GT 50011

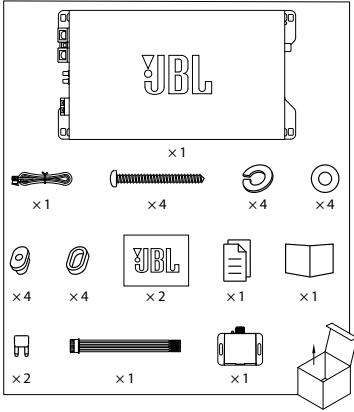

JBL Stage GT 90041

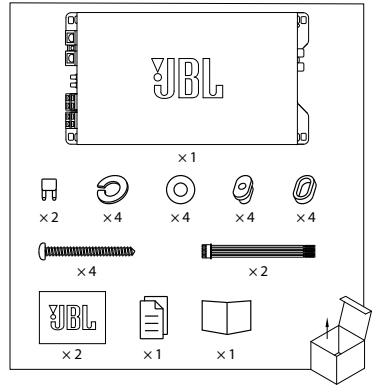

JBL Stage GT 80021

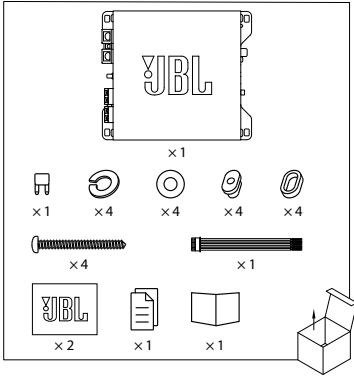

安装功放

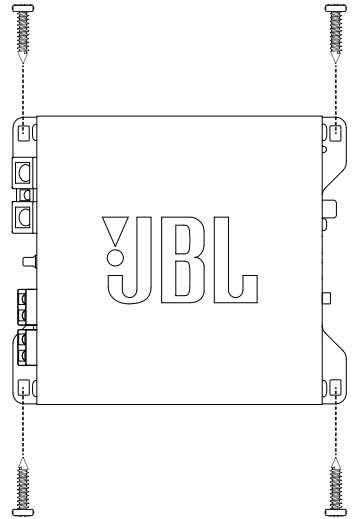

ZH-CN

JBL Stage GT 60041

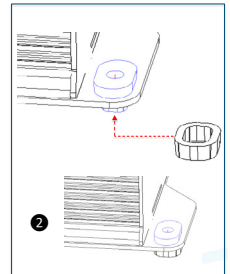
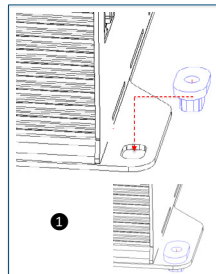
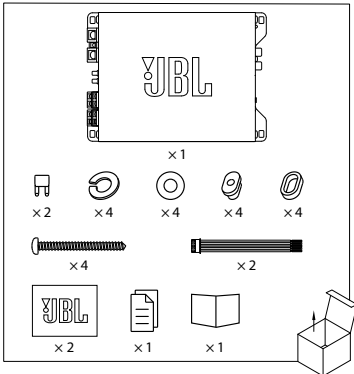

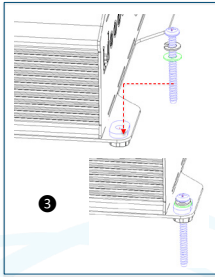

在接地端：

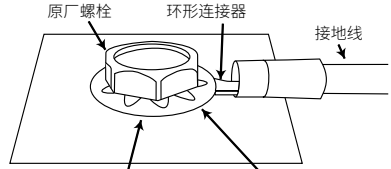

注：请移除环形连接器
下的所有油漆

输入信号布线

Stage GT 50011 和 80021 低电平信号

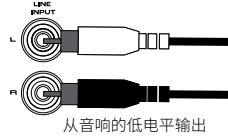

从音响的低电平输出

Stage GT 60041 和 90041 低电平信号

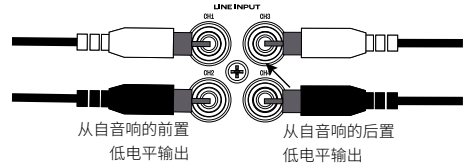

从自音响的前置
低电平输出

从自音响的后置
低电平输出

Stage GT 50011 和 80021 高电平信号

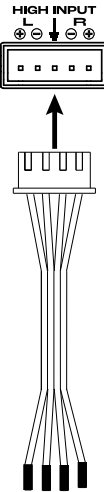

连接至车载音箱输出线

注：在将车辆音箱线连接到高电平适配器时，请务必确保极性正确。

注：建议在安装放大器之前完成所有电线连接。

重要提示：开始安装前，请先断开汽车的负极 (-) 电池端子连接。

- 使用工具时，应始终佩戴护目镜。
- 选择一个安全的安装位置，避免潮湿。确认并清空安装位置表面的两侧空间。确保螺丝和电线不会刺穿制动管线、燃料管线或任何线束，且布线不会对车辆的安全驾驶造成干扰。在安装区域进行钻孔或切割时应小心谨慎。
- 选择一个空气流通的地方。
- 安装时请勿将散热器朝向下，以免干扰功放冷却。
- 请将功放安装在安全位置，避免被后排乘客踢碰或因后备箱内物品移动而损坏。

电源和接地布线

在功放端：

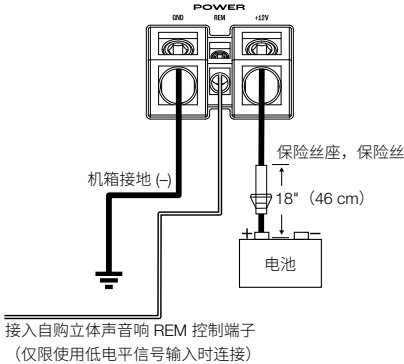

接入自购立体声音响 REM 控制端子
(仅限使用低电平信号输入时连接)

注：如果你使用的是高电平输入信号，则无需连接远程开机线。在高电平模式下，当功放检测到信号时会自动开机。

推荐的保险丝额定值：

- Stage GT 50011：60 A
- Stage GT 80021：25 A
- Stage GT 60041：40 A
- Stage GT 90041：60 A

汽车后市场行业标准颜色编码	
CH1+ (左前声道+)	白色
CH1- (左前声道-)	白色/黑色
CH2+ (右前声道+)	灰色
CH2- (右前声道-)	灰色/黑色

Stage GT 80021 双声道输出

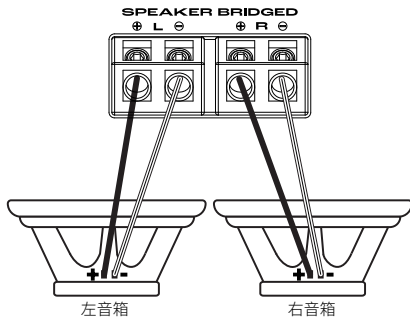

Stage GT 80021 单声道 (桥接) 输出

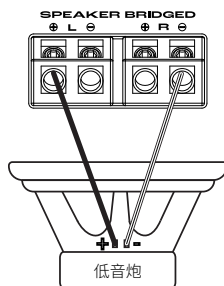

Stage GT 60041 和 90041 四声道输出

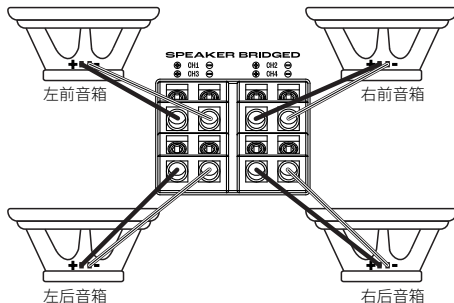

Stage GT 60041 和 90041 三声道输出

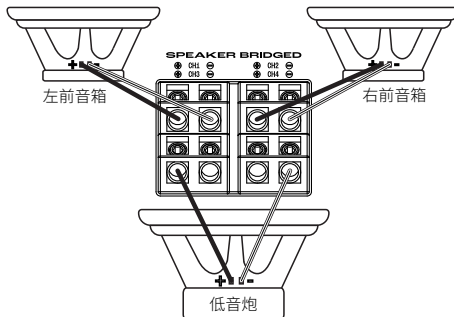

Stage GT 60041 和 90041 高电平输入信号

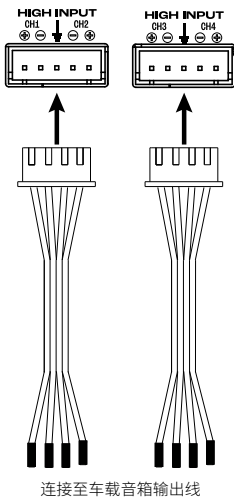

汽车后市场行业标准	
颜色编码	
CH1+ (左前声道+)	白色
CH1- (左前声道-)	白色/黑色
CH2+ (右前声道+)	灰色
CH2- (右前声道-)	灰色/黑色
CH3+ (左后声道+)	绿色
CH3- (左后声道-)	绿色/黑色
CH4+ (右后声道+)	紫色
CH4- (右后声道-)	紫色/黑色

输出布线

推荐的音箱阻抗:

- 2 Ω-4 Ω (立体声输入)
- 4 Ω (桥接输入)

Stage GT 50011 单声道输出

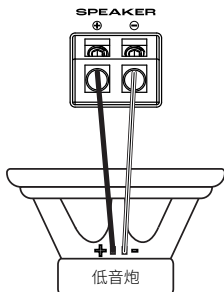

Stage GT 60041 和 90041 双声道输出

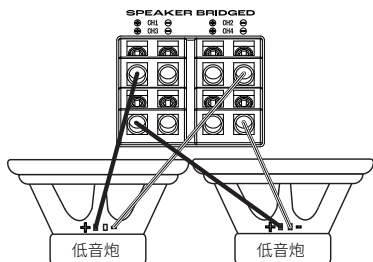

连接远程低音控制器 (仅适用于 Stage GT 50011)

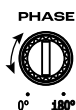
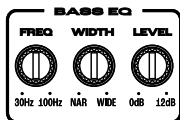
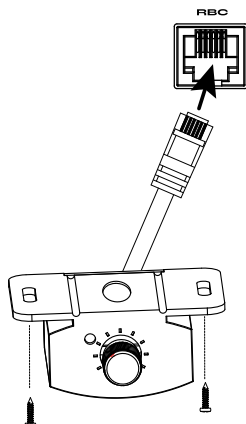

选择分频频率

根据听音偏好选择分频点。逆时针旋转可降低分频点，顺时针旋转可提高分频点。同轴音箱和低音炮的精确分频器设置取决于你的听音偏好。

选择低音均衡器——Stage GT 80021、60041 和 90041

根据你的听音偏好，从 0 dB 至 +12 dB 的范围内选择低音输出级别。顺时针旋转旋钮可提高低音均衡器输出，逆时针旋转可降低低音均衡器。

选择低音均衡器——仅适用于 Stage GT 50011

1. 调整 FREQ 旋钮选择中心频率，即你希望增强的主要低音频率，范围在 30 Hz 至 100 Hz 之间。顺时针旋转选择较高的频率，逆时针旋转选择较低的频率。可根据听音偏好选择频率。
2. 调整 WIDTH 旋钮决定被增强的相邻频率范围。顺时针旋转选择较宽的频率范围，逆时针旋转选择较窄的频率范围。
3. 调整 LEVEL 旋钮，设置低音输出电平，范围为 0 dB 至 +12 dB。顺时针旋转可提高输出电平，逆时针旋转可降低输出电平。

选择低音扬声器的相位 - 仅适用于 Stage GT 50011

在 0° 至 180° 之间切换相位，以设置能提供最干净的低音输出。

ZH-CN

调整增益、分频器和低音均衡器

设置增益

1. 将电平控制设置为 5V，分频器控制旋钮调至中间位置。
2. 选择你熟悉的音乐。
3. 将主机的音量调节至总输出的 3/4。
4. 顺时针调整增益控制旋钮，同时仔细聆听低音效果。如果听到失真，则逆时针转动增益控件以降低增益。

选择分频模式

选择 HPF 时，仅允许高于某一频率的信号传输到音箱。推荐在系统中使用低音炮时选择此选项，以防止全频音箱播放低频声音。

选择 LPF 时，仅允许低于某一频率的信号传输到音箱。推荐在桥接通道为低音炮供电时选择此选项。

选择 FULL 时，允许所有频率传输到音箱。系统中不使用低音炮时，推荐选择此选项。

注：Stage GT 50011 仅支持低通分频器。



电源/ 保护状态指示灯

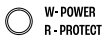

如果电源/保护指示灯显示白色，表示功放已开启且工作正常。如果指示灯显示红色且没有播放声音，表示功放处于保护模式。请参考“故障排除”章节查看可能的原因。

规格

	Stage GT 50011	Stage GT 80021	Stage GT 60041	Stage GT 90041
4 Ω时额定功率输出	300 W RMS x 1	80 W RMS x 2	65 W RMS x 4	90 W RMS x 4
2 Ω时额定功率输出	500 W RMS x 1	130 W RMS x 2	90 W RMS x 4	130 W RMS x 4
峰值输出功率	2 Ω时, 1220 W x 1	4 Ω时, 800 W x 1	4 Ω时, 1240 W x 2	4 Ω时, 1480 W x 2
桥接模式额定输出功率	不适用	4 Ω时, 260 W RMS x 1	4 Ω时, 180 W RMS x 2	4 Ω时, 260 W RMS x 2
频率响应 (±1 dB)	10 Hz – 320 Hz	20 Hz – 20 kHz	20 Hz – 20 kHz	20 Hz – 20 kHz
分频频率	32 - 320 Hz 可变低通滤波器, 12 dB/倍频程	32 - 320 Hz 可变高通与低通低通滤波器, 12 dB/倍频程	32 - 320 Hz 可变高通与低通低通滤波器, 12 dB/倍频程	32 - 320 Hz 可变高通与低通低通滤波器, 12 dB/倍频程
低音均衡器	0 - 12 dB @ 30 - 100 Hz, 可变	0 - 12 dB @ 45 Hz	0 - 12 dB @ 45 Hz	0 - 12 dB @ 45 Hz
线路电平输入灵敏度	0.2 Vrms–5.0 Vrms	0.2 Vrms–5.0 Vrms	0.2 Vrms–5.0 Vrms	0.2 Vrms–5.0 Vrms
高电平输入灵敏度	1.0 Vrms–25 Vrms	1.0 Vrms–25 Vrms	1.0 Vrms–25 Vrms	1.0 Vrms–25 Vrms
1 W @ 4 Ω时的信噪比	>75 dB	>75 dB	>75 dB	>75 dB
额定功率时的 THD+N	1%	1%	1%	1%
保险丝额定值	30 A x 2	25 A x 1	20 A x 2	30 A x 2
工作电压	9 V – 16 V	9 V – 16 V	9 V – 16 V	9 V – 16 V
保护	DC、OVP、UVP、OCP、OTP	DC、OVP、UVP、OCP、OTP	DC、OVP、UVP、OCP、OTP	DC、OVP、UVP、OCP、OTP
尺寸 (宽 x 高 x 厚)	9-23/32" x 1-15/16" x 5-7/32" (246.9 mm x 49.5 mm x 132.5 mm)	6-3/16 x 1-15/16" x 5-7/32" (156.9 mm x 49.5 mm x 132.5 mm)	7-3/8 x 1-15/16" x 5-7/32" (186.9 mm x 49.5 mm x 132.5 mm)	9-11/32 x 1-15/16" x 5-7/32" (236.9 mm x 49.5 mm x 132.5 mm)
重量	1633 g (3.6 lb.)	1061 g (2.34 lb.)	1338 g (2.95 lb.)	1702 g (3.75 lb.)
推荐的线规	4	8	4	4
最高工作温度:	70 °C	70 °C	70 °C	70 °C

ZH-CN

故障排除

问题	原因和解决方案
无音频且电源指示灯关闭。	BATT+ 和/或 REM 端子没有电压, 接地线损坏或未接地。使用万用表检查功放端子电压。
无音频且保护指示灯每 4 秒闪烁一次。	功放输出直流电压故障。功放可能需要维修; 请参阅随附保修卡以了解维修信息。
无音频且保护和电源指示灯闪烁。	BATT+ 连接的电压小于 9 V。检查汽车充电系统。
无音频且保护指示灯亮起。	功放过热。确保功放散热口未被安装位置阻挡。或者, BATT+ 连接的电压可能大于 16 V (或小于 8.5 V)。检查汽车充电系统。
功放保险丝熔断。	线路连接不正确, 或存在短路。检查线路连接。
音频失真。	增益未正确设置。检查设置。检查电缆是否短路或接地不准确。功放或源设备可能存在质量缺陷。
音频失真且保护指示灯闪烁。	音箱或电线短路。一次移除一根音箱引线, 定位短路的音箱或电线并修理。
音乐缺乏动态效果或“冲击力”。	音箱未正确连接。检查音箱连接的极性是否正确。
引擎启动时系统中存在引擎噪声, 如嘎嘎声或咔哒声。	功放正在拾起交流发电机噪声。首先, 检查功放的接地连接, 因为松散或错误的接地连接是引起噪声的主要原因之一。调低增益。将 RCA 音频电缆从电源线处移开。此外, 也可能需要在电池和交流发电机之间的电源线上安装交流发电机噪声滤波器。

包裝盒內物品

JBL Stage GT 50011

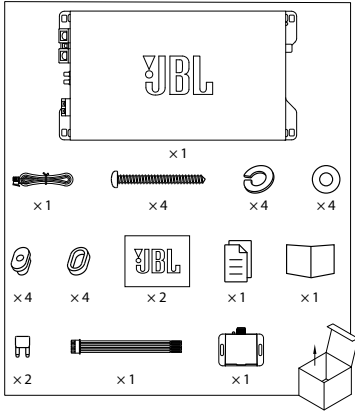

JBL Stage GT 90041

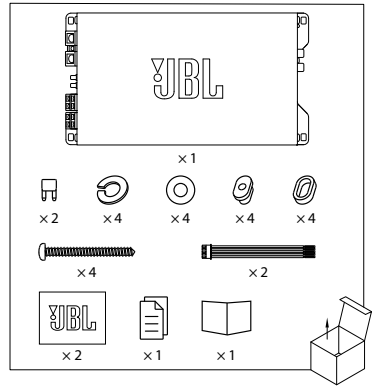

JBL Stage GT 80021

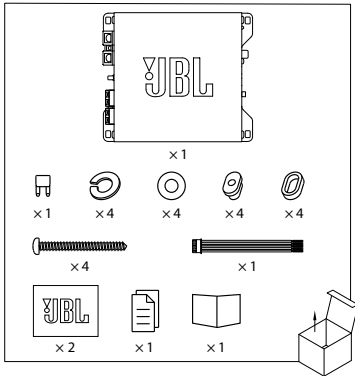

JBL Stage GT 60041

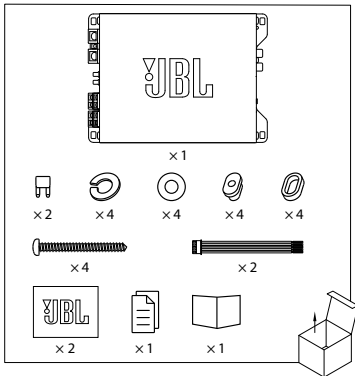

安裝放大器

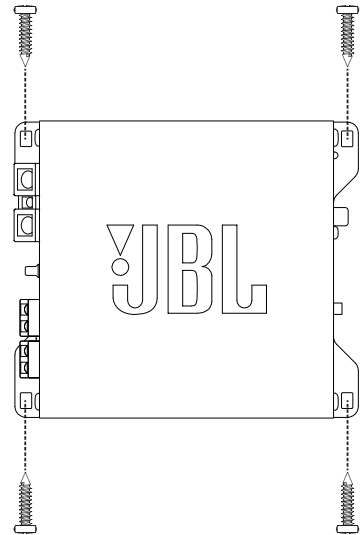

ZH-TW

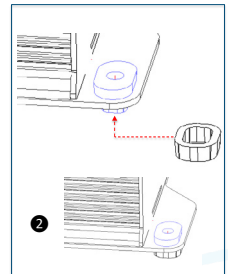
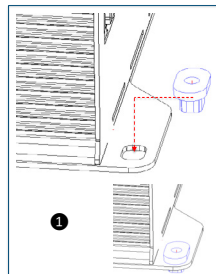

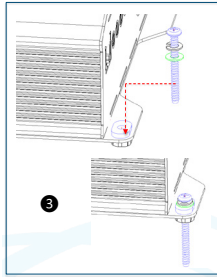

在接地位置：

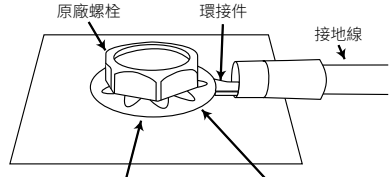

附註：除去環接件下的
任何油漆

輸入訊號的接線

Stage GT 50011 和 80021 低電平訊號

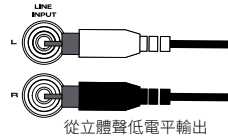

從立體聲低電平輸出

Stage GT 60041 和 90041 低電平訊號

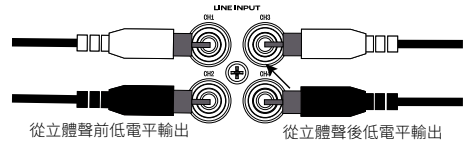

從立體聲前低電平輸出

從立體聲後低電平輸出

Stage GT 50011 和 80021 高電平訊號

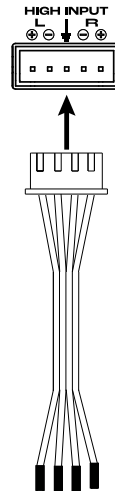

到車輛喇叭輸出電線

附註：連接車輛喇叭線到高電平適配器時，務必遵守正確的極性。

附註：建議您在安裝放大器前進行所有電線連接。

重要事項：開始安裝之前，請先斷開汽車的負極 (-) 電池端子。

- 使用工具時，請始終佩戴護目鏡。
- 選擇一個遠離濕氣的安全安裝位置。檢查計劃的安裝表面兩側的距離。請確保螺絲或電線不會刺穿制動管線、燃料管線或任何線束，以及佈線不會干擾車輛的安全操控。在安裝區域鑽孔或切割時請小心。
- 選擇提供足夠空氣流通的位置。
- 安裝放大器時，請勿將散熱槽正面朝下，因為這會干擾冷卻。
- 安裝放大器時，請確保放大器不會被後座乘客踢碰，或因車尾箱內物品晃動而損壞。

電源和接地的接線

在放大器處：

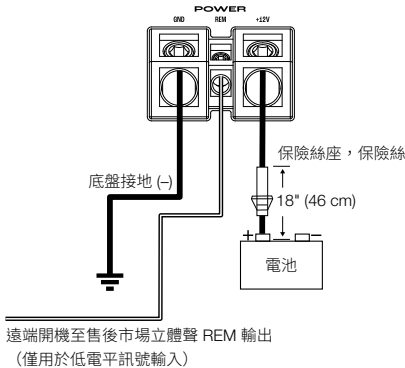

遠端開機至售後市場立體聲 REM 輸出
(僅用於低電平訊號輸入)

附註：如果您使用高電平輸入訊號，您不需要連接遠端開機電線。在高電平模式下，放大器將在偵測到訊號時自動開機。

建議的保險絲額定電流：

- Stage GT 50011：60 A
- Stage GT 80021：25 A
- Stage GT 60041：40 A
- Stage GT 90041：60 A

汽車後市場行業標準顏色編碼	
CH1+ (左前 +)	白色
CH1- (左前 -)	白色/黑色
CH2+ (右前 +)	灰色
CH2- (右前 -)	灰色/黑色

Stage GT 60041 和 90041 高電平輸入訊號

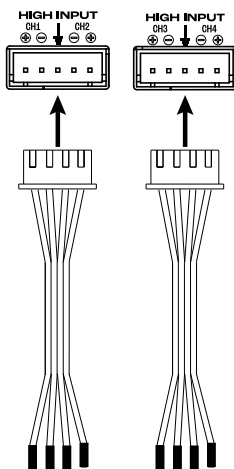

到車輛喇叭輸出電線

Stage GT 80021 2 聲道輸出

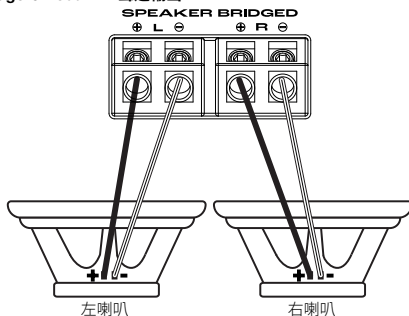

Stage GT 80021 單聲道 (橋接) 輸出

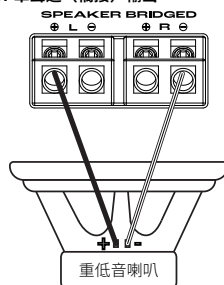

Stage GT 60041 和 90041 4 聲道輸出

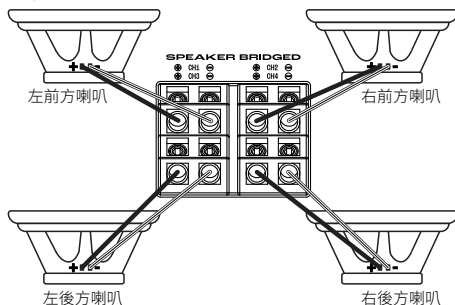

Stage GT 60041 和 90041 3 聲道輸出

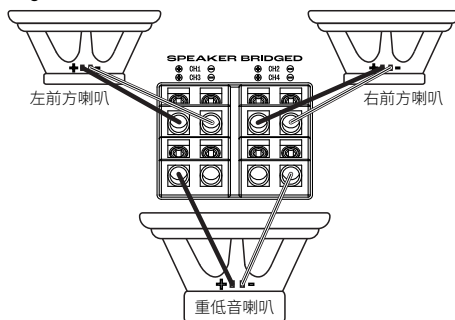

汽車後市場行業標準	
顏色編碼	
CH1+ (左前 +)	白色
CH1- (左前 -)	白色/黑色
CH2+ (右前 +)	灰色
CH2- (右前 -)	灰色/黑色
CH3+ (左後 +)	綠色
CH3- (左後 -)	綠色/黑色
CH4+ (右後 +)	紫色
CH4- (右後 -)	紫色/黑色

輸出接線

建議的喇叭阻抗：

- 2 歐姆 – 4 歐姆 (立體聲輸入)
- 4 歐姆 (橋接輸入)

Stage GT 50011 單聲道輸出

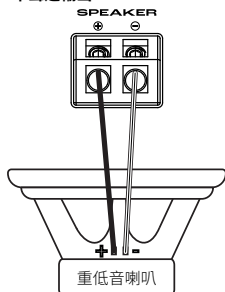

Stage GT 60041 和 90041 2 聲道輸出

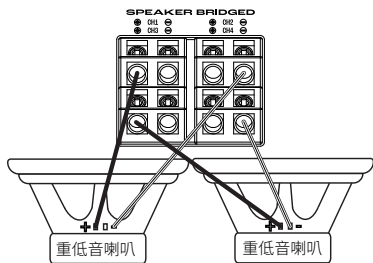

連接遠端低音控制器 (僅限 Stage GT 50011)

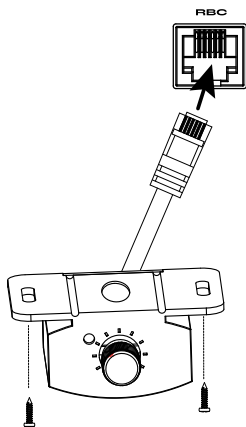

32Hz 320Hz



32Hz 320Hz



0dB 12dB

選擇分頻頻率

選擇分頻點以適合聆聽喜好。逆時針旋轉撥盤降低分頻點，順時針旋轉提高分頻點。同軸喇叭和重低音喇叭的確切分頻設定取決於您的聆聽喜好。

選擇低音均衡器 - Stage GT 80021、60041 和 90041

根據您的聆聽喜好，選擇低音輸出電平（從 0 到 +12 dB）。順時針旋轉撥盤提高低音均衡器輸出電平，逆時針旋轉撥盤降低低音均衡器輸出電平。

選擇低音均衡器 - 僅限 Stage GT 50011

- 調節 **FREQ** 撥盤選擇中心頻率 - 30 Hz 和 100 Hz 之間您要增強的主要低音頻率。順時針旋轉撥盤選擇較高頻率，逆時針旋轉撥盤選擇較低頻率。您選擇哪一個頻率取決於您的聆聽喜好。
- 調節 **WIDTH** 撥盤以確定還增強了多少相鄰頻率。順時針旋轉撥盤選擇較寬的頻率範圍，逆時針旋轉撥盤選擇較窄的頻率範圍。
- 調節 **LEVEL** 撥盤以選擇低音訊號的輸出電平（0 至 +12 dB）。順時針旋轉撥盤提高輸出電平，逆時針旋轉撥盤降低輸出電平。

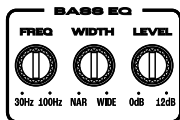

0° 180°

選擇重低音喇叭相位 - 僅限 Stage GT 50011

在 0° 和 180° 之間來回切換相位，以決定哪個設定可提供最清晰的低音輸出。

電源/ 保護狀態指示燈

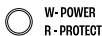

如果電源/保護狀態指示燈亮白色，放大器將開啟並且正常運行。如果該指示燈為紅色並且未播放聲音，放大器將處於保護模式。請參閱「疑難排解」以了解可能的原因。

ZH-TW

設定增益、分頻和低音均衡器

設定增益

- 首先將電平控制鈕設為 5 V，分頻控制鈕轉至中間值。
- 選擇您熟悉的音樂。
- 旋轉主機上的音量控制鈕至其總輸出的 ¾。
- 順時針調節增益控制鈕，仔細聆聽低音輸出。若您聽到了失真，則逆時針轉動增益控制鈕以減少增益。

選擇分頻模式

選擇 HPF(高通)，僅允許高於某個點的頻率到達您的喇叭。在系統中使用重低音喇叭時推薦使用，因為它可防止低通到達全音域喇叭。

選擇 LPF(低通)，僅允許低於某個點的頻率到達您的喇叭。在您橋接聲道以向重低音喇叭供電時推薦使用。

選擇 FULL(全部)，允許全部的頻率到達您的喇叭。在系統中不使用重低音喇叭時推薦使用。

附註：Stage GT 50011 只具備低通分頻。

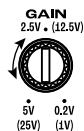

規格

	Stage GT 50011	Stage GT 80021	Stage GT 60041	Stage GT 90041
4 歐姆時額定功率輸出	300 瓦 RMS x 1	80 瓦 RMS x 2	65 瓦 RMS x 4	90 瓦 RMS x 4
2 歐姆時額定功率輸出	500 瓦 RMS x 1	130 瓦 RMS x 2	90 瓦 RMS x 4	130 瓦 RMS x 4
峰值輸出	2 歐時 1220 瓦 x 1	4 歐時 800 瓦 x 1	4 歐時 1240 瓦 x 2	4 歐時 1480 瓦 x 2
橋接模式下的額定功率輸出	不適用	4 歐時，260 瓦 RMS x 1	4 歐時，180 瓦 RMS x 2	4 歐時，260 瓦 RMS x 2
頻率回應 (±1dB)	10 Hz – 320 Hz	20 Hz – 20 kHz	20 Hz – 20 kHz	20 Hz – 20 kHz
分頻頻率	32 - 320 Hz 可變低通， 12 dB/八音度	32 - 320 Hz 可變高通和 低通，12 dB/八音度	32 - 320 Hz 可變高通和 低通，12 dB/八音度	32 - 320 Hz 可變高通和 低通，12 dB/八音度
低音均衡器	30 - 100 Hz 時， 0 - 12 dB，可變	45 Hz 時，0 - 12 dB	45 Hz 時，0 - 12 dB	45 Hz 時，0 - 12 dB
線路電平輸入靈敏度	0.2 Vrms – 5.0 Vrms	0.2 Vrms – 5.0 Vrms	0.2 Vrms – 5.0 Vrms	0.2 Vrms – 5.0 Vrms
線路電平輸入靈敏度	1.0 Vrms – 25 Vrms	1.0 Vrms – 25 Vrms	1.0 Vrms – 25 Vrms	1.0 Vrms – 25 Vrms
雜訊比，4 歐姆時為 1 W	>75 dB	>75 dB	>75 dB	>75 dB
額定功率時的 THD+N	1%	1%	1%	1%
保險絲額定電流	30 A x 2	25 A x 1	20 A x 2	30 A x 2
工作電壓	9 V – 16 V	9 V – 16 V	9 V – 16 V	9 V – 16 V
保護	DC、OVP、UVP、 OCP、OTP	DC、OVP、UVP、 OCP、OTP	DC、OVP、UVP、 OCP、OTP	DC、OVP、UVP、 OCP、OTP
尺寸 (寬 x 高 x 深)	9-23/32" x 1-15/16" x 5-7/32" (246.9 mm x 49.5 mm x 132.5 mm)	6-3/16 x 1-15/16" x 5-7/32" (156.9 mm x 49.5 mm x 132.5 mm)	7-3/8 x 1-15/16" x 5-7/32" (186.9 mm x 49.5 mm x 132.5 mm)	9-11/32 x 1-15/16" x 5-7/32" (236.9 mm x 49.5 mm x 132.5 mm)
重量	1633 g (3.6 lb.)	1061 g (2.34 lb.)	1338 g (2.95 lb.)	1702 g (3.75 lb.)
推薦電線線徑	4	8	4	4
最高工作溫度：	70°C	70°C	70°C	70°C

ZH-TW

疑難排解

問題	原因和解決方案
無音訊並且電源指示燈關閉。	BATT+ 和/或 REM 端子沒有電壓，或者接地連接出錯或缺失。使用伏特/歐姆計 (VOM) 檢查放大器端子的電壓。
無音訊並且保護指示燈每 4 秒鐘閃爍一次。	放大器輸出上的 DC 電壓。放大器可能需要維修；請參閱隨附的保固卡，瞭解維修資訊。
無音訊並且保護和電源指示燈閃爍。	BATT+ 連接上的電壓低於 9 V。檢查車輛的充電系統。
無音訊並且保護指示燈開啟。	放大器過熱。確保安裝位置不會阻礙放大器冷卻。或者 BATT+ 連接上可能存在大於 16 V (或小於 8.5 V) 的電壓。檢查車輛的充電系統。
放大器保險絲總是熔斷。	電線連接不正確或存在短路。檢查連線。
音訊失真。	增益設定不正確。檢查設定。檢查電線是否短路或接地。放大器或來源裝置可能存在缺陷。
音訊失真，保護指示燈閃爍。	喇叭內或電線短路。每次拔掉一條喇叭導線，找到短路的喇叭或電線，並進行維修。
音樂缺乏動感或「衝擊力」。	喇叭連接不正確。檢查喇叭連接的極性是否正確。
引擎啟動時系統中發出雜訊 (喀噠聲或高頻噪音)。	放大器拾取交流發電機雜訊。首先，檢查放大器上的接地連接 - 鬆動或不正確接地是產生雜訊的主要原因之一。調小增益。讓 RCA 音訊線與電源線保持一定距離。在電池和交流發電機之間的電源線上也可能有必要安裝交流發電機雜訊濾波器。

ISI KOTAK

JBL Stage GT 50011

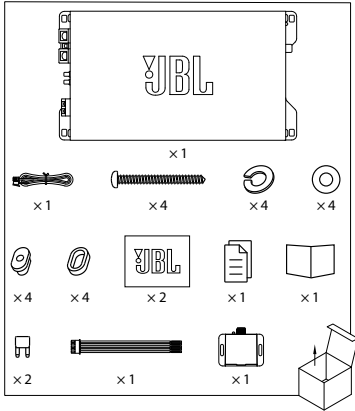

JBL Stage GT 90041

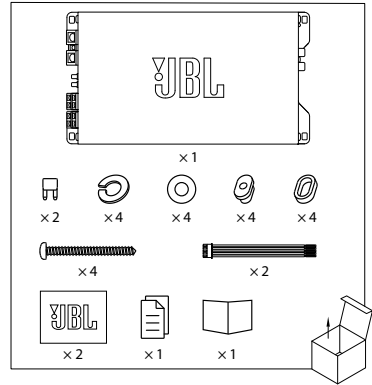

JBL Stage GT 80021

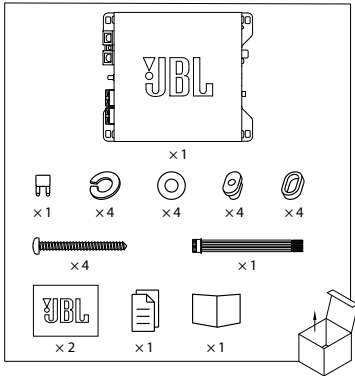

MEMASANG AMPLIFIER

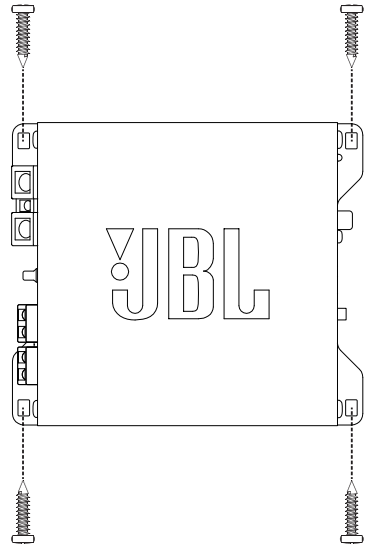

JBL Stage GT 60041

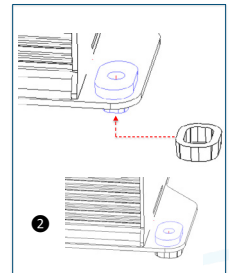
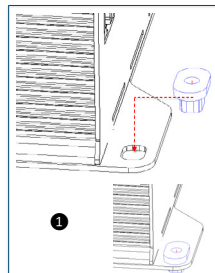
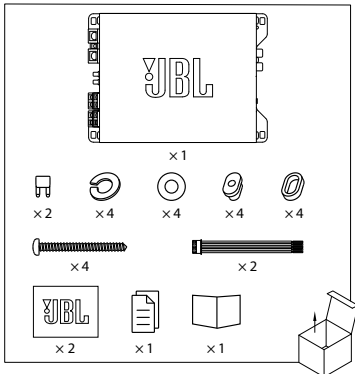

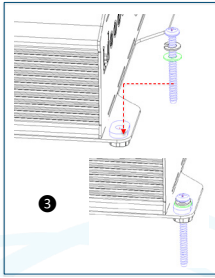

Catatan: Disarankan untuk memasang semua sambungan kabel sebelum memasang amplifier.

PENTING: Putuskan terminal aki negatif (-) kendaraan sebelum memulai pemasangan.

- Selalu kenakan pelindung mata saat menggunakan peralatan untuk memasang.
- Pilih lokasi pemasangan yang aman dan tidak lembap. Pastikan ketersediaan ruang pada kedua sisi permukaan pemasangan yang sudah direncanakan. Pastikan agar sekrup atau kabel tidak akan menusuk jalur rem, saluran bahan bakar, atau harness kabel, dan jalur kabel tersebut tidak akan mengganggu keamanan dalam mengoperasikan kendaraan. Berhati-hatilah saat melubangi atau memotong area dukungan.
- Pilih lokasi yang memiliki sirkulasi udara yang cukup.
- Jangan memasang amplifier dengan membuang panas menghadap ke arah bawah karena akan mengganggu proses pendinginan.
- Pasang amplifier di posisi yang tidak akan membuatnya rusak akibat terinjak kaki penumpang kursi belakang atau akibat keluar masuknya barang bawaan di ruang bagasi.

SAMBUNGAN KABEL DAYA DAN GROUND

Di amplifier:

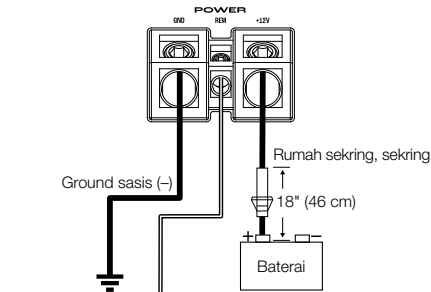

Pengaktif jarak jauh ke keluaran REM pada stereo toko komersial (hanya digunakan dengan input sinyal tingkat rendah)

CATATAN: Jika menggunakan sinyal input tingkat tinggi, Anda tidak perlu menghubungkan kabel pengaktif jarak jauh. Dalam mode tingkat tinggi, amplifier akan menyala secara otomatis ketika mendeteksi sinyal.

Rating sekring yang disarankan:

- Stage GT 50011: 60 A
- Stage GT 80021: 25 A
- Stage GT 60041: 40 A
- Stage GT 90041: 60 A

Di lokasi ground:

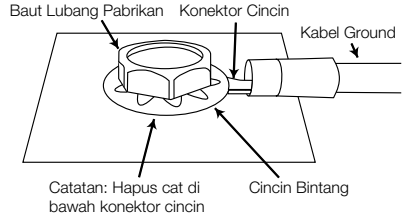

SAMBUNGAN UNTUK SINYAL INPUT

Stage GT 50011 dan 80021 sinyal tingkat rendah

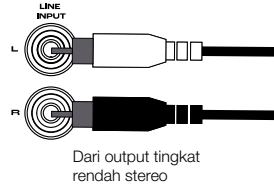

Stage GT 60041 dan 90041 sinyal tingkat rendah

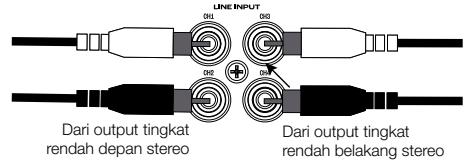

Stage GT 50011 dan 80021 sinyal tingkat tinggi

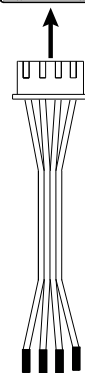

Catatan: Perhatikan kutub kabel saat menghubungkan kabel speaker kendaraan ke adaptor tingkat tinggi.

Kode Warna Standar Industri Komersial Mobil	
CH1+ (Kiri Depan +)	Putih
CH1- (Kiri Depan -)	Putih/Hitam
CH2+ (Kanan Depan +)	Abu-abu
CH2- (Kanan Depan -)	Abu-abu/Hitam

Stage GT 60041 dan 90041 sinyal input tingkat tinggi

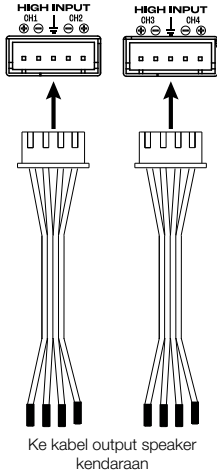

Stage GT 80021 output 2-saluran

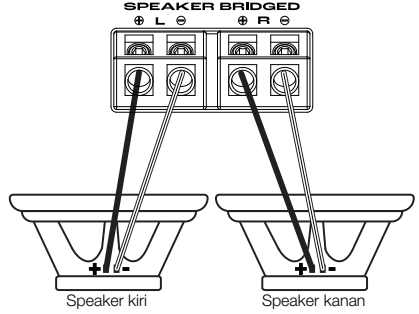

Stage GT 80021 output mono (bridged)

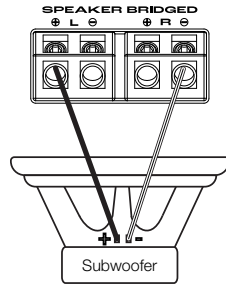

Standar Industri Komersial Mobil	
Kode Warna	
CH1+ (Kiri Depan +)	Putih
CH1- (Kiri Depan -)	Putih/Hitam
CH2+ (Kanan Depan +)	Abu-abu
CH2- (Kanan Depan -)	Abu-abu/Hitam
CH3+ (Kiri Belakang +)	Hijau
CH3- (Kiri Belakang -)	Hijau/Hitam
CH4+ (Kanan Belakang +)	Ungu
CH4- (Kanan Belakang -)	Ungu/Hitam

Stage GT 60041 dan 90041 output 4-saluran

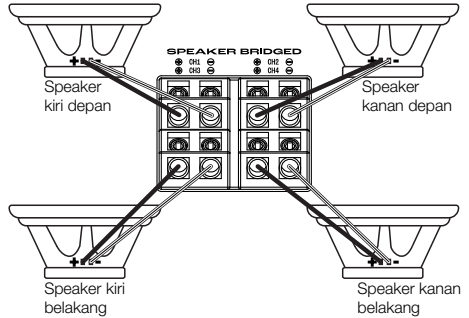

SAMBUNGAN UNTUK OUTPUT

Rekomendasi impedansi speaker:

- 2 ohm-4 ohm (input stereo)
- 4 ohm (input bridged)

Stage GT 50011 output mono

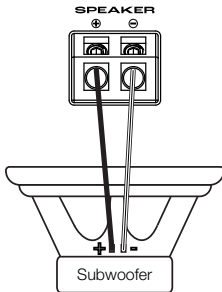

Stage GT 60041 dan 90041 output 3-saluran

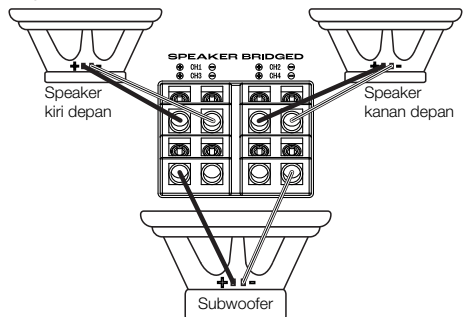

Stage GT 60041 dan 90041 output 2-saluran

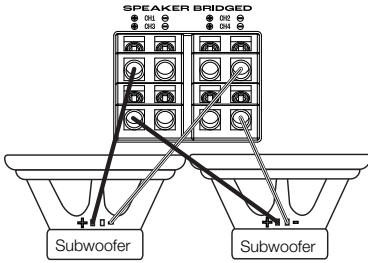

Menghubungkan pengendali bas jarak jauh (khusus Stage GT 50011)

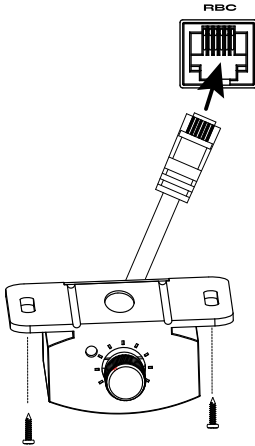

Milih frekuensi crossover

Pilih titik crossover sesuai dengan selera pendengaran. Putar knob berlawanan jarum jam untuk menurunkan titik crossover dan searah jarum jam untuk menaikkan titik crossover. Pengaturan crossover yang tepat untuk speaker dan subwoofer koaksial bergantung pada selera pendengaran Anda.

Milih Bass EQ – Stage GT 80021, 60041, dan 90041

Pilih tingkat output bass sesuai dengan selera pendengaran Anda, dari 0 sampai +12 dB. Putar knob searah jarum jam untuk menaikkan tingkat output Bass EQ, dan berlawanan jarum jam untuk menurunkannya.

Memilih Bass EQ – khusus Stage GT 50011

1. Sesuaikan knob FREQ untuk memilih frekuensi tengah, yaitu frekuensi bass primer antara 30 Hz dan 100 Hz yang ingin ditingkatkan. Putar knob searah jarum jam untuk memilih frekuensi yang lebih tinggi, dan berlawanan jarum jam untuk memilih frekuensi lebih rendah. Pilih sesuai dengan selera pendengaran Anda.
2. Sesuaikan knob WIDTH untuk menentukan jumlah frekuensi berdekatan yang juga ditingkatkan. Putar knob searah jarum jam untuk memilih frekuensi dengan jangkauan yang luas, dan berlawanan jarum jam untuk memilih jangkauan sempit.
3. Sesuaikan knob LEVEL untuk memilih tingkat level sinyal bass, dari 0 sampai +12 dB. Putar knob searah jarum jam untuk menaikkan tingkat output, dan berlawanan jarum jam untuk menurunkannya.

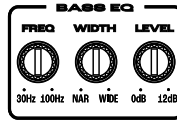

MENGATUR GAIN, CROSSOVER, DAN BASS EQ

Mengatur gain

1. Mulai dengan kontrol tingkat yang diatur ke 5 V, dan kontrol crossover yang diputar ke tengah.
2. Pilih musik yang familier bagi Anda.
3. Putar kontrol volume di unit utama hingga $\frac{3}{4}$ output totalnya.
4. Sesuaikan kontrol gain searah jarum jam sambil mendengarkan output bass dengan saksama. Jika ada distorsi, putar kontrol gain berlawanan arah jarum jam untuk mengurangi gain.

Memilih mode crossover

Pilih **HPF** agar hanya frekuensi di atas titik tertentu yang dapat menjangkau speaker. Pilihan ini disarankan jika Anda menggunakan subwoofer di sistem karena akan mencegah bass rendah mencapai speaker full-range.

Pilih **LPF** agar hanya frekuensi di bawah titik tertentu yang dapat menjangkau speaker. Pilihan ini disarankan jika Anda melakukan bridging saluran untuk menyalakan subwoofer.

Pilih **FULL** agar semua frekuensi dapat menjangkau speaker. Pilihan ini disarankan jika Anda tidak menggunakan subwoofer di sistem.

Catatan: Stage GT 50011 hanya dilengkapi crossover frekuensi rendah.



Memilih fase subwoofer – khusus Stage GT 50011

Atur fase ke belakang dan depan antara 0° dan 180° untuk menentukan pengaturan yang memberikan output bas paling jernih.

LAMPU INDIKATOR STATUS DAYA/ PERLINDUNGAN



Jika lampu indikator daya/ perlindungan menyala warna putih, itu artinya amplifier menyala dan bekerja secara normal. Jika lampu indikator berwarna merah dan tidak ada suara yang terdengar, itu artinya amplifier sedang berada dalam mode perlindungan. Baca "Pemecahan Masalah" untuk melihat masalah yang mungkin terjadi.

SPEKIFIKASI

	Stage GT 50011	Stage GT 80021	Stage GT 60041	Stage GT 90041
Output daya terukur @ 4 ohm	300 watt RMS x 1	80 watt RMS x 2	65 watt RMS x 4	90 watt RMS x 4
Output daya terukur @ 2 ohm	500 watt RMS x 1	130 watt RMS x 2	90 watt RMS x 4	130 watt RMS x 4
Output puncak	1.220 watt x 1 @ 2 ohm	800 watt x 1 @ 4 ohm	1.240 watt x 2 @ 4 ohm	1.480 watt x 2 @ 4 ohm
Output daya terukur dalam mode bridged	tidak ada	260 watt RMS x 1 @ 4 ohm	180 watt RMS x 2 @ 4 ohm	260 watt RMS x 2 @ 4 ohm
Respons frekuensi (± 1 dB)	10 Hz–320 Hz	20 Hz–20 kHz	20 Hz–20 kHz	20 Hz–20 kHz
Frekuensi crossover	Variabel 32–320 Hz frekuensi rendah, 12 dB/oktaf	Variabel 32–320 Hz frekuensi tinggi dan rendah, 12 dB/oktaf	Variabel 32–320 Hz frekuensi tinggi dan rendah, 12 dB/oktaf	Variabel 32–320 Hz frekuensi tinggi dan rendah, 12 dB/oktaf
Bass EQ	0–12 dB @ 30–100 Hz, variabel	0–12 dB @ 45 Hz	0–12 dB @ 45 Hz	0–12 dB @ 45 Hz
Sensitivitas input tingkat lintasan	0,2 Vrms–5,0 Vrms	0,2 Vrms–5,0 Vrms	0,2 Vrms–5,0 Vrms	0,2 Vrms–5,0 Vrms
Sensitivitas input tingkat tinggi	1,0 Vrms–25 Vrms	1,0 Vrms–25 Vrms	1,0 Vrms–25 Vrms	1,0 Vrms–25 Vrms
Rasio sinyal terhadap derau pada 1 W @ 4 ohm	>75 dB	>75 dB	>75 dB	>75 dB
THD+N @ daya terukur	1%	1%	1%	1%
Rating sekering	30 A x 2	25 A x 1	20 A x 2	30 A x 2
Voltase pengoperasian	9 V–16 V	9 V–16 V	9 V–16 V	9 V–16 V
Perlindungan	DC, OVP, UVP, OCP, OTP	DC, OVP, UVP, OCP, OTP	DC, OVP, UVP, OCP, OTP	DC, OVP, UVP, OCP, OTP
Dimensi (P x T x L)	9–23/32" x 1–15/16" x 5–7/32" (246,9 mm x 49,5 mm x 132,5 mm)	6–3/16" x 1–15/16" x 5–7/32" (156,9 mm x 49,5 mm x 132,5 mm)	7–3/8" x 1–15/16" x 5–7/32" (186,9 mm x 49,5 mm x 132,5 mm)	9–11/32" x 1–15/16" x 5–7/32" (236,9 mm x 49,5 mm x 132,5 mm)
Berat	1.633 g (3,6 lb)	1.061 g (2,34 lb)	1.338 g (2,95 lb)	1.702 g (3,75 lb)
Diameter kabel yang disarankan	4	8	4	4
Suhu pengoperasian maks.:	70 °C	70 °C	70 °C	70 °C

PEMECAHAN MASALAH

PERMASALAHAN	PENYEBAB DAN SOLUSI
Tidak ada suara yang keluar dan LAMPU INDIKATOR DAYA tidak menyala.	Tidak ada voltase pada terminal BATT+ dan/atau REM, atau ada koneksi yang jelek atau tidak ada koneksi ground. Cek voltase pada terminal amplifier dengan VOM.
Tidak ada suara yang keluar dan LAMPU INDIKATOR PERLINDUNGAN berkedip setiap 4 detik.	Tegangan DC pada output amplifier. Amplifier mungkin perlu diservis; lihat kartu garansi untuk informasi servis.
Tidak ada suara yang keluar dan LAMPU INDIKATOR PERLINDUNGAN serta LAMPU INDIKATOR DAYA berkedip.	Voltase kurang dari 9 V pada koneksi BATT+. Periksa sistem pengisian daya kendaraan.
Tidak ada suara yang keluar dan LAMPU INDIKATOR PERLINDUNGAN menyala.	Amplifier terlalu panas. Pastikan komponen pendingin dari amplifier tidak terblokir/tertutup di lokasi dudukan. Kemungkinan lain, ada voltase yang lebih besar dari 16 V (atau kurang dari 8,5 V) pada koneksi BATT+. Periksa sistem pengisian daya kendaraan.
Sekering amplifier cepat putus.	Kabel tidak tersambung dengan benar atau ada arus pendek. Cek sambungan kabel.
Ada distorsi suara pada audio.	Gain tidak diatur sebagaimana mestinya. Cek pengaturan. Cek ada tidaknya arus pendek atau sambungan ground. Amplifier atau unit sumber mungkin rusak.
Ada distorsi suara pada audio dan LAMPU INDIKATOR PERLINDUNGAN berkedip.	Ada arus pendek pada speaker atau kabelnya. Lepaskan kabel-kabel lead pada speaker satu per satu untuk menemukan speaker atau kabel yang mengalami arus pendek, lalu perbaiki.
Musik terdengar kurang dinamis atau kurang "menendang".	Speaker tidak tersambung dengan benar. Pastikan pasangan kutub pada koneksi speaker sudah benar.
Derau mesin—memekek atau ada suara klik-klik—di sistem saat mesin menyala.	Amplifier meneruskan derau alternator. Pertama-tama, cek sambungan kabel ground pada amplifier. Kabel ground yang kendur atau tidak benar terpasang bisa jadi salah satu penyebab utama derau. Turunkan gain. Jauhkan kabel audio RCA dari kabel daya. Ada baiknya pasang penyaring derau alternator pada jalur daya antara aki dan alternator.

구성품

JBL Stage GT 50011

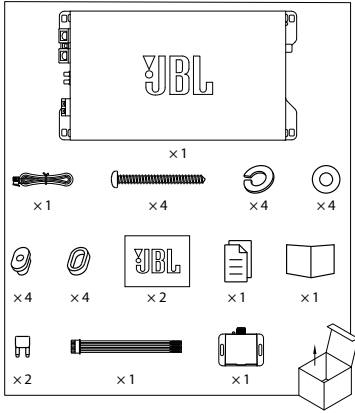

JBL Stage GT 90041

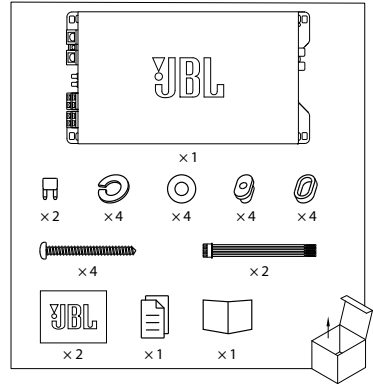

JBL Stage GT 80021

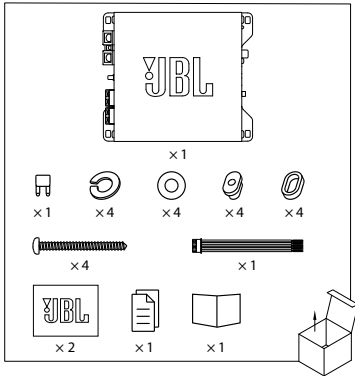

앰프 장착

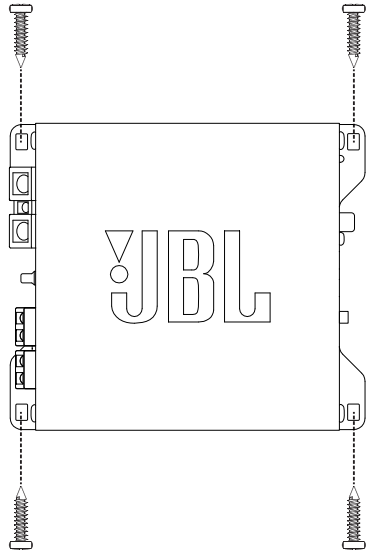

JBL Stage GT 60041

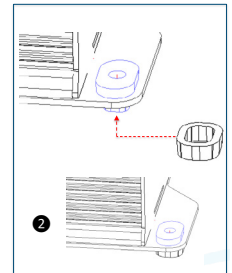
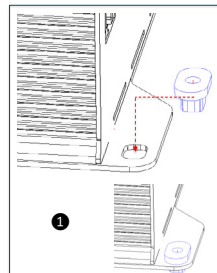
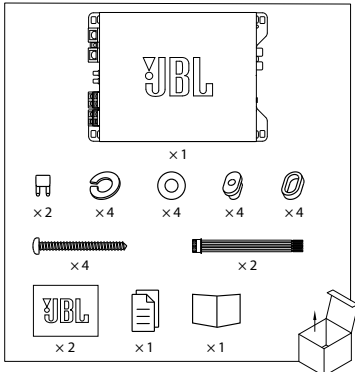

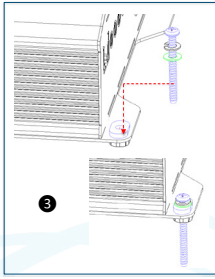

접지 위치 측:

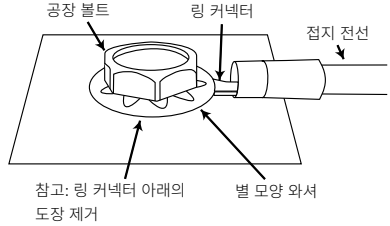

참고: 앰프를 장착하기 전 모든 배선을 연결하는 것이 좋습니다.

중요: 설치하기 전에 차량 배터리 음극(-) 단자의 연결을 분리하십시오.

- 공구를 사용할 때는 반드시 눈 보호용 장비를 착용하십시오.
- 습기가 없는 안전한 장착 위치를 선택하십시오. 장착하려는 양쪽 표면의 간격을 확인합니다. 나사나 선이 브레이크 라인, 연료 라인 또는 와이어링 하니스를 뚫지 않는지, 선 배치가 차량의 안전한 작동을 방해하지 않는지 확인합니다. 장착 부위에 드릴 작업을 하거나 절단할 때는 주의하십시오.
- 공기가 충분히 순환되는 위치를 선택하십시오.
- 히트 싱크가 아래를 향하게 하여 앰프를 장착하지 마십시오. 앰프의 냉각을 방해하게 됩니다.
- 발이나 트렁크의 짐이 움직임에 따라 손상되지 않도록 앰프를 장착하십시오.

전원 및 접지 배선

앰프 측:

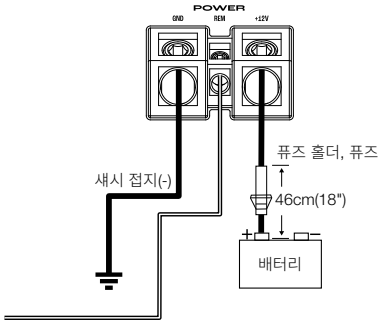

원격 켜짐 전선 - 애프터마켓
스테레오 REM 출력
(로우 레벨 신호 입력 시에만 사용)

참고: 하이 레벨 입력 신호를 사용 중인 경우 원격 켜짐 전선을 연결하지 않아도 됩니다. 하이 레벨 모드에서는 앰프가 신호를 감지하면 자동으로 켜집니다.

권장 퓨즈 정격:

- Stage GT 50011: 60A
- Stage GT 80021: 25A
- Stage GT 60041: 40A
- Stage GT 90041: 60A

입력 신호 배선

Stage GT 50011 및 80021 로우 레벨 신호

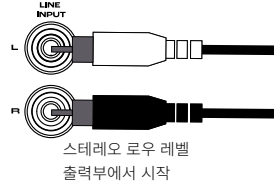

Stage GT 60041 및 90041 로우 레벨 신호

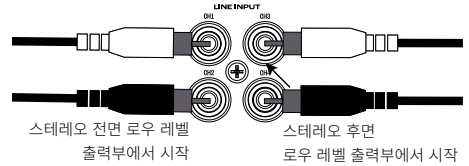

Stage GT 50011 및 80021 하이 레벨 신호

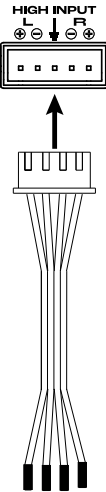

차량 스피커 출력 전선에 연결

참고: 차량 스피커 전선을 하이 레벨 어댑터에 연결할 때 적절한 극성인지 확인하십시오.

자동차 애프터마켓 산업 표준 색상 코딩	
CH1+ (전면 좌측 +)	흰색
CH1- (전면 좌측 -)	흰색/검은색
CH2+ (전면 우측 +)	회색
CH2- (전면 우측 -)	회색/검은색

Stage GT 60041 및 90041 하이 레벨 입력 신호

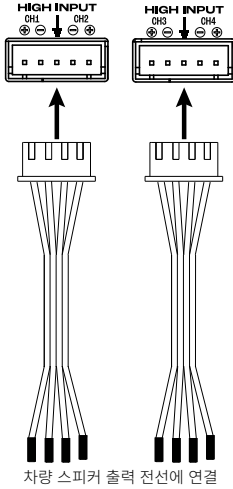

자동차 애프터마켓 산업 표준 색상 코딩	
색상 코딩	
CH1+ (전면 좌측 +)	흰색
CH1- (전면 좌측 -)	흰색/검은색
CH2+ (전면 우측 +)	회색
CH2- (전면 우측 -)	회색/검은색
CH3+ (후면 좌측 +)	녹색
CH3- (후면 좌측 -)	녹색/검은색
CH4+ (후면 우측 +)	퍼플
CH4- (후면 우측 -)	보라색/검은색

출력 배선

권장 스피커 임피던스:

- 2Ω-4Ω(스테레오 입력)
- 4Ω(브리지 입력)

Stage GT 50011 모노 출력

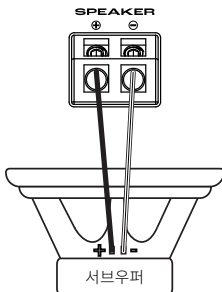

Stage GT 80021 2채널 출력

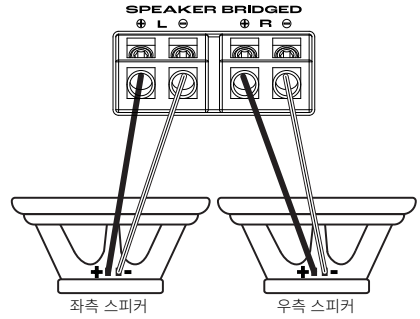

Stage GT 80021 모노(브리지) 출력

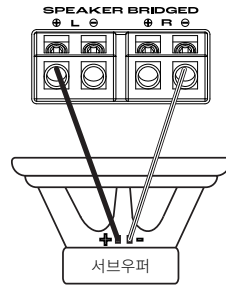

Stage GT 60041 및 90041 4채널 출력

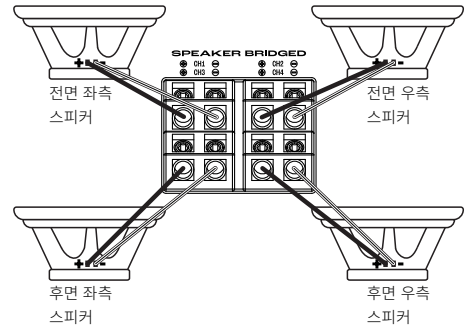

Stage GT 60041 및 90041 3채널 출력

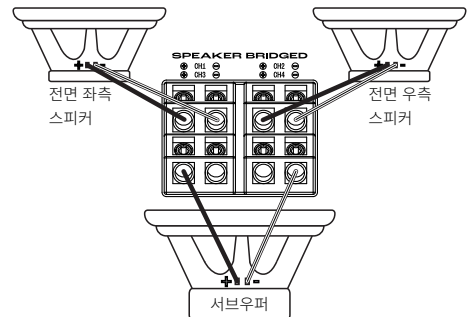

Stage GT 60041 및 90041 2채널 출력

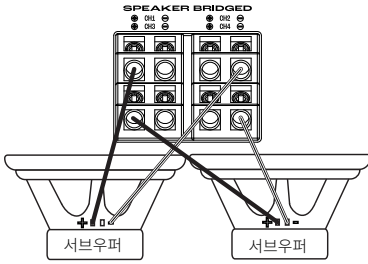

원격 저음 컨트롤러 연결(Stage GT 50011만 해당)

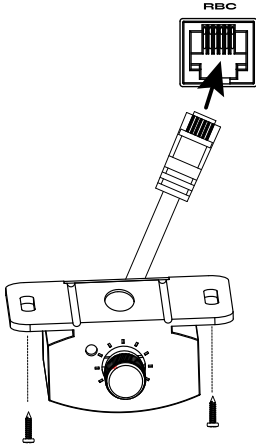

게인, 크로스오버 및 저음 EQ 설정

게인 설정

- 레벨 제어를 5V로 설정하고 크로스오버 제어가 중간을 향하도록 한 상태에서 시작하십시오.
- 즐거 듣는 음악을 선택합니다.
- 총 출력의 3/4 수준으로 헤드 장치 불륨 제어를 켭니다.
- 저음 출력을 주의 깊게 들으면서 게인 컨트롤을 시계 방향으로 조절합니다. 왜곡이 들리면 게인 컨트롤을 시계 반대 방향으로 돌려 게인을 낮추십시오.



크로스오버 모드 선택

특정 지점을 초과하는 주파수만 스피커에 도달할 수 있도록 하려면 **HPF**를 선택하십시오. 시스템에서 서브우퍼를 사용하여 플레인지 스피커에서 낮은 저음을 유지할 경우 사용할 것을 권장합니다.



특정 지점 미만의 주파수만 스피커에 도달할 수 있도록 하려면 **LPF**를 선택하십시오. 서브우퍼에 전원을 공급하기 위해 채널을 연결하는 경우에 사용할 것을 권장합니다.

모든 주파수가 스피커에 도달할 수 있도록 하려면 **FULL**을 선택하십시오. 시스템에서 서브우퍼를 사용하지 않는 경우에 사용할 것을 권장합니다.

참고: Stage GT 50011에는 저음 통과 크로스오버만 제공됩니다.

크로스오버 주파수 선택



청취자의 취향에 맞게 크로스오버 지점을 선택하십시오. 다이얼을 시계 반대 방향으로 돌리면 크로스오버 지점을 낮추고 시계 방향으로 돌리면 크로스오버 지점을 높입니다. 동축 스피커와 서브우퍼의 정확한 크로스오버 설정은 청취자의 취향에 따라 다릅니다.

저음 EQ 선택 - Stage GT 80021, 60041 및 90041



청취자 취향에 따라 저음 출력 수준을 0~+12dB 사이에서 선택합니다. 다이얼을 시계 방향으로 돌리면 저음 EQ 출력 수준을 높이고 시계 반대 방향으로 돌리면 수준을 낮춥니다.

저음 EQ 선택 - Stage GT 50011 만 해당

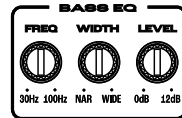

- FREQ** 다이얼을 조절하여 중심 주파수(30Hz~100Hz 사이에서 향상하고 싶은 기본 저음 주파수)를 선택합니다. 다이얼을 시계 방향으로 돌리면 주파수를 높이고 시계 반대 방향으로 돌리면 주파수를 낮춥니다. 청취자의 취향에 따라 선택할 수 있습니다.
- WIDTH** 다이얼을 조절하여 인접 주파수가 향상되는 정도를 확인합니다. 다이얼을 시계 방향으로 돌리면 넓은 주파수 범위를 선택하고 시계 반대 방향으로 돌리면 좁은 주파수 범위를 선택합니다.
- LEVEL** 다이얼을 조절하여 저음 신호 출력 수준을 0~+12dB 사이에서 선택합니다. 다이얼을 시계 방향으로 돌리면 출력 수준을 높이고 시계 반대 방향으로 돌리면 수준을 낮춥니다.



서브우퍼 위상 선택 - Stage GT 50011
만 해당

위상 스위치를 0°~180° 사이에서
앞뒤로 전환해 저음 출력이 가장 깨끗한
설정을 선택하십시오.

전원/보호 상태 표시등



전원/보호 표시등이 흰색으로 점등된
경우 앰프가 켜지고 정상적으로
작동합니다. 표시등이 빨간색이며
사운드가 재생되지 않는 경우 앰프가
보호 모드 상태입니다. 가능한 원인을
알아보려면 "문제 해결"을 참조하십시오.

사양

	Stage GT 50011	Stage GT 80021	Stage GT 60041	Stage GT 90041
4Ω에서의 정격 전원 출력	300W RMS x 1	80W RMS x 2	65W RMS x 4	90W RMS x 4
2Ω에서의 정격 전원 출력	500W RMS x 1	130W RMS x 2	90W RMS x 4	130W RMS x 4
최대 출력	1,220W x 1(2Ω)	800W x 1(4Ω)	1,240W x 2(4Ω)	1,480W x 2(4Ω)
브리지 방식 모드의 정격 전원 출력	해당 없음	260W RMS x 1(4Ω)	180W RMS x 2(4Ω)	260W RMS x 2(4Ω)
주파수 응답(±1dB)	10Hz~320Hz	20Hz~20kHz	20Hz~20kHz	20Hz~20kHz
크로스오버 주파수	32~320Hz 가변 저음 통과, 12dB/옥타브	32~320Hz 가변 고음/저음 통과, 12dB/옥타브	32~320Hz 가변 고음/저음 통과, 12dB/옥타브	32~320Hz 가변 고음/저음 통과, 12dB/옥타브
저음 EQ	30~100Hz에서 0~12dB, 가변	45Hz에서 0~12dB	45Hz에서 0~12dB	45Hz에서 0~12dB
라인 레벨 입력 민감도	0.2Vrms~5.0Vrms	0.2Vrms~5.0Vrms	0.2Vrms~5.0Vrms	0.2Vrms~5.0Vrms
하이 레벨 입력 민감도	1.0Vrms~25Vrms	1.0Vrms~25Vrms	1.0Vrms~25Vrms	1.0Vrms~25Vrms
4Ω에서 1W 시 신호 대 잡음비	>75dB	>75dB	>75dB	>75dB
정격 출력에서 THD+N	1%	1%	1%	1%
퓨즈 정격	30A x 2	25A x 1	20A x 2	30A x 2
작동 전압	9V~16V	9V~16V	9V~16V	9V~16V
보호	DC, OVP, UVP, OCP, OTP	DC, OVP, UVP, OCP, OTP	DC, OVP, UVP, OCP, OTP	DC, OVP, UVP, OCP, OTP
치수(너비 x 높이 x 깊이)	246.9mm x 49.5mm x 132.5mm(9-23/32" x 1-15/16" x 5-7/32")	156.9mm x 49.5mm x 132.5mm(6-3/16" x 1-15/16" x 5-7/32")	186.9mm x 49.5mm x 132.5mm(7-3/8" x 1-15/16" x 5-7/32")	236.9mm x 49.5mm x 132.5mm(9-11/32" x 1-15/16" x 5-7/32")
무게	1,633g(3.6lb.)	1,061g(2.34lb.)	1,338g(2.95lb.)	1,702g(3.75lb.)
권장하는 전선 게이지	4	8	4	4
최대 작동 온도:	70°C	70°C	70°C	70°C

문제 해결

문제	원인 및 해결책
오디오가 나오지 않고 전원 표시등이 꺼져 있습니다.	BATT+ 및/또는 REM 단자에 전압이 없거나 접지 연결이 불량하거나 없습니다. VOM 으로 앰프 단자의 전압을 점검하십시오.
오디오가 나오지 않고 보호 표시등이 4초마다 깜박입니다.	앰프 출력의 DC 전압. 앰프를 점검해야 할 수 있습니다. 서비스 정보는 동봉된 보증서를 참조하십시오.
오디오가 나오지 않고 보호, 전원 표시등이 깜박입니다.	BATT+ 연결 전압이 9V 미만입니다. 차량 충전 시스템을 점검하십시오.
오디오가 나오지 않고 보호 표시등이 켜져 있습니다.	앰프가 과열되었습니다. 앰프 장착 위치에서 냉각 차단 여부를 확인하십시오. 또는 BATT+ 연결 전압이 16V를 초과했거나 8.5V 미만일 수 있습니다. 차량 충전 시스템을 점검하십시오.
앰프 퓨즈가 계속 나갑니다.	배선이 잘못 연결되었거나 합선되었습니다. 배선 연결을 점검하십시오.
오디오 왜곡.	게인이 제대로 설정되지 않았습니다. 설정을 점검하십시오. 전선의 합선이나 접지를 점검하십시오. 앰프나 소스 장치에 결함이 있을 수 있습니다.
오디오가 왜곡되고 보호 표시등이 깜박입니다.	스피커나 전선의 합선. 합선이 발생한 스피커나 전선을 찾기 위해 스피커 리드를 한 번에 하나씩 분리한 다음, 수리하십시오.
음악에 역동성이나 "활력"이 부족합니다.	스피커가 제대로 연결되지 않았습니다. 적절한 극성으로 스피커가 연결되었는지 점검하십시오.
엔진을 켤 때 시스템에 끼익끼하거나 딸깍하는 엔진 소음이 있습니다.	앰프가 교류 발전기 소음을 수신하고 있습니다. 먼저 느슨하거나 부적절한 접지는 소음의 주 원인 중 하나이므로 앰프의 접지 연결을 점검하십시오. 게인을 끄니다. RCA 오디오 케이블을 전선에서 멀리 옮기십시오. 필요 시 배터리와 교류 발전기 사이의 전선에 교류 발전기 소음 필터를 설치하십시오.



HARMAN International Industries,
Incorporated 8500 Balboa Boulevard,
Northridge, CA 91329 USA
www.jbl.com

© 2024 HARMAN International Industries, Incorporated. All rights reserved.
JBL is a trademark of HARMAN International Industries, Incorporated,
registered in the United States and/or other countries. Features, specifications
and appearance are subject to change without notice.