

CONNECTION DIAGRAM

ADZ-NMMI

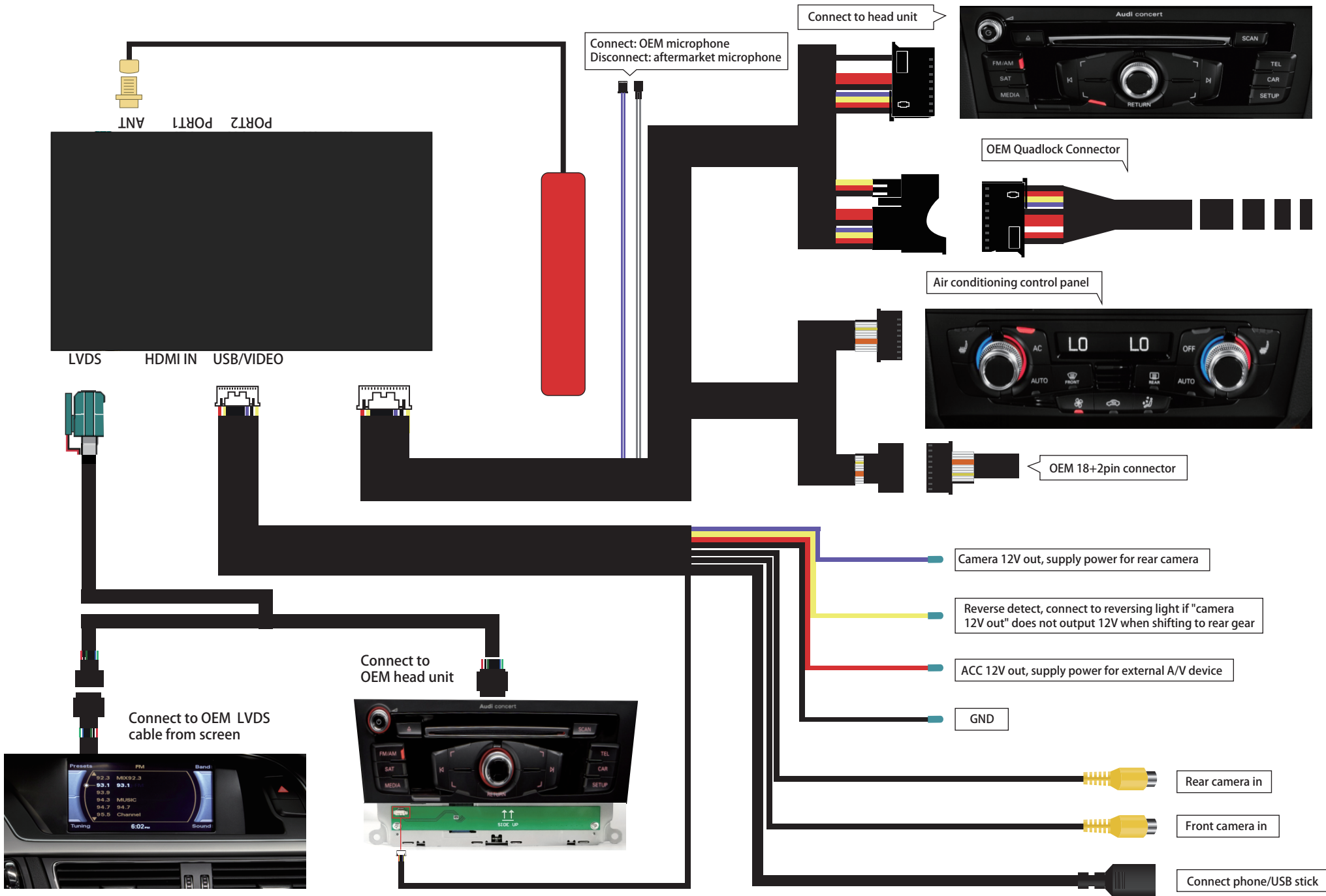

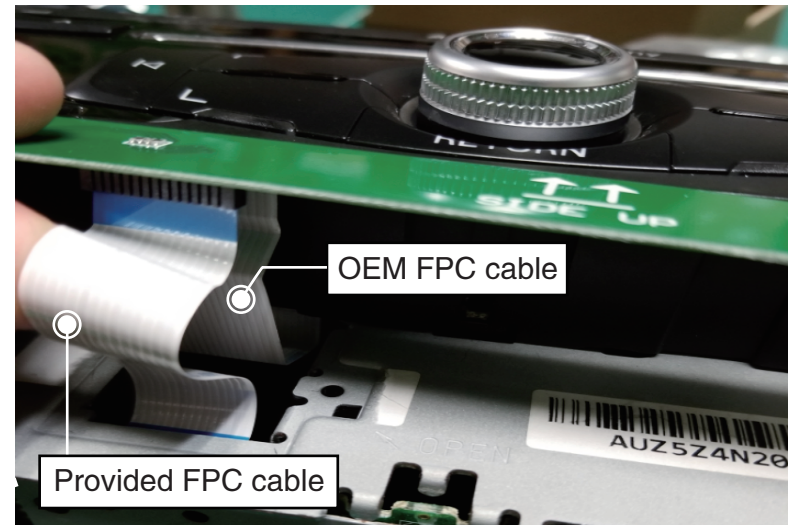
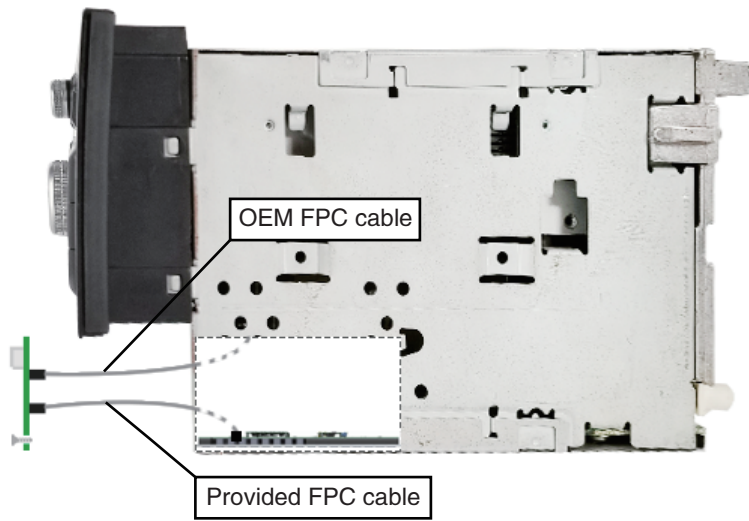

NOTE! Unplug the OEM FPC from main board of head unit and connect to the black connector above of provided board, then connect provided FPC cable to the OEM connector that just pulled out OEM FPC. Please pay attention to the direction of provided FPC board. (SIDE UP)

DIP setting:

DIP						Selection of car model	model
OFF ▲	OFF ▲	OFF ▲	ON ▽	OFF ▲	ON ▽	Without MMI: 2009–2015 A4/A5/Q5	ADZ-NMMI

DIP	ON	OFF
7	Car without “PARK”	Car with “PARK” button
8	External microphone	OEM microphone

NOTE! Please disconnect & reconnect interface's power after changing any DIP setting.



How to switch



Press and hold “MEDIA” button

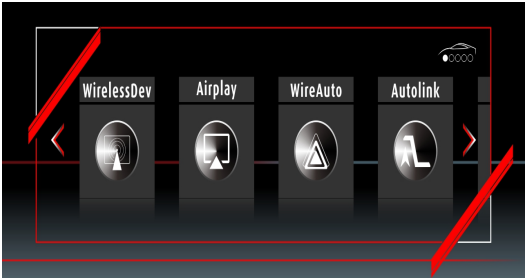

Add on module interface