

Before installing make sure ignition supply to the vehicle is switched off !

## Dashboard Disassembly

1. Unclip and remove the recirculate/ fresh slide button. (Figure A)
2. Unclip and remove the entire panel surrounding the radio including the a/c vents. (Figure B)
3. Remove (4) Phillips screws securing the radio. (Figure C)

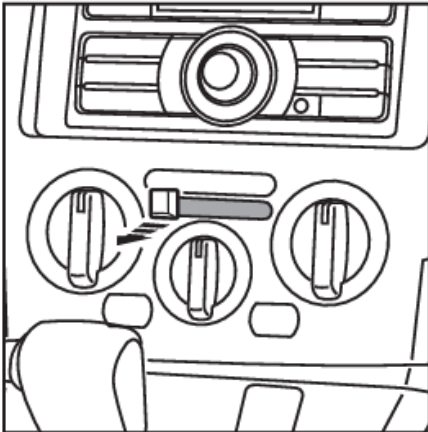

(Figure A)

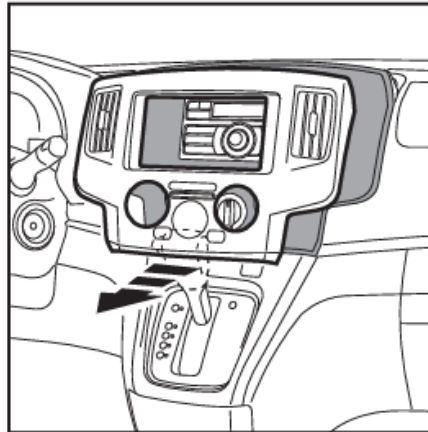

(Figure B)

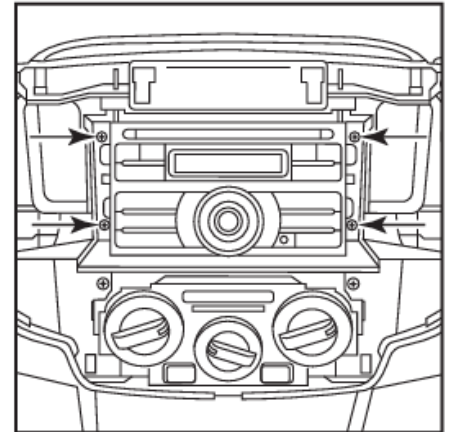

(Figure C)

## ISO adapter (20-163) installation

1. Connect the black and brown male ISO connections to the corresponding female ISO connections from the back of the radio. If your radio has loose wires rather than ISO connections, please use an ISO adapter such as a Incartec 20-022 to add them to your radio.
2. Connect the vehicle specific connectors into the cars original wiring. Connect the ground loop that is attached to the harness (the main earth lead for the radio) to a chassis ground on the vehicle.

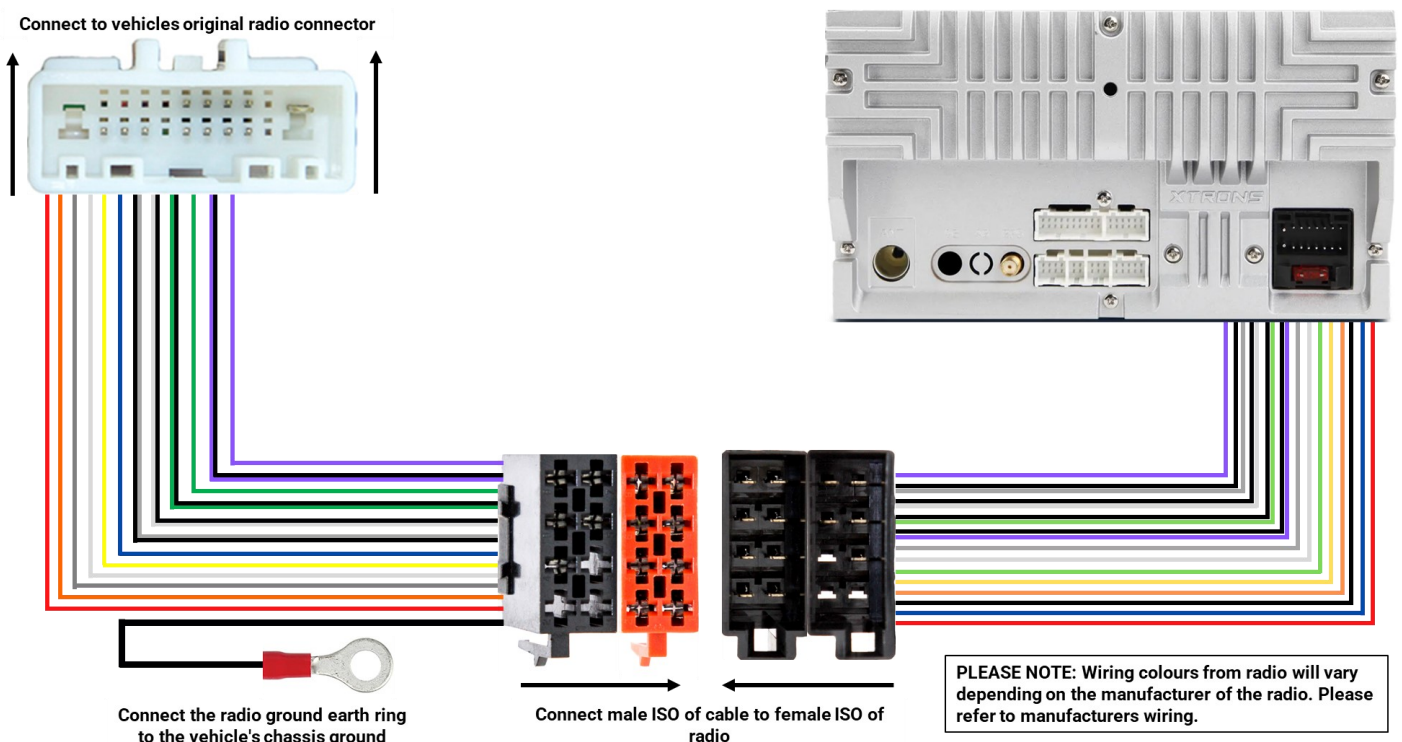

## Antenna adapter (21-118R) installation

1. Connect the vehicle specific connector to the original AM/ FM antenna connection in the car.
2. Connect the DIN aerial connection to the back of the after market radio.
3. Connect the bullet connector (on the blue wire) to the blue antenna turn on wire, or the blue/white remote turn on wire coming from the new aftermarket radio harness. See from the below options

### OPTION ONE

The wiring that came with the aftermarket radio may already come with a bullet connection it can be connected to. (Figure B)

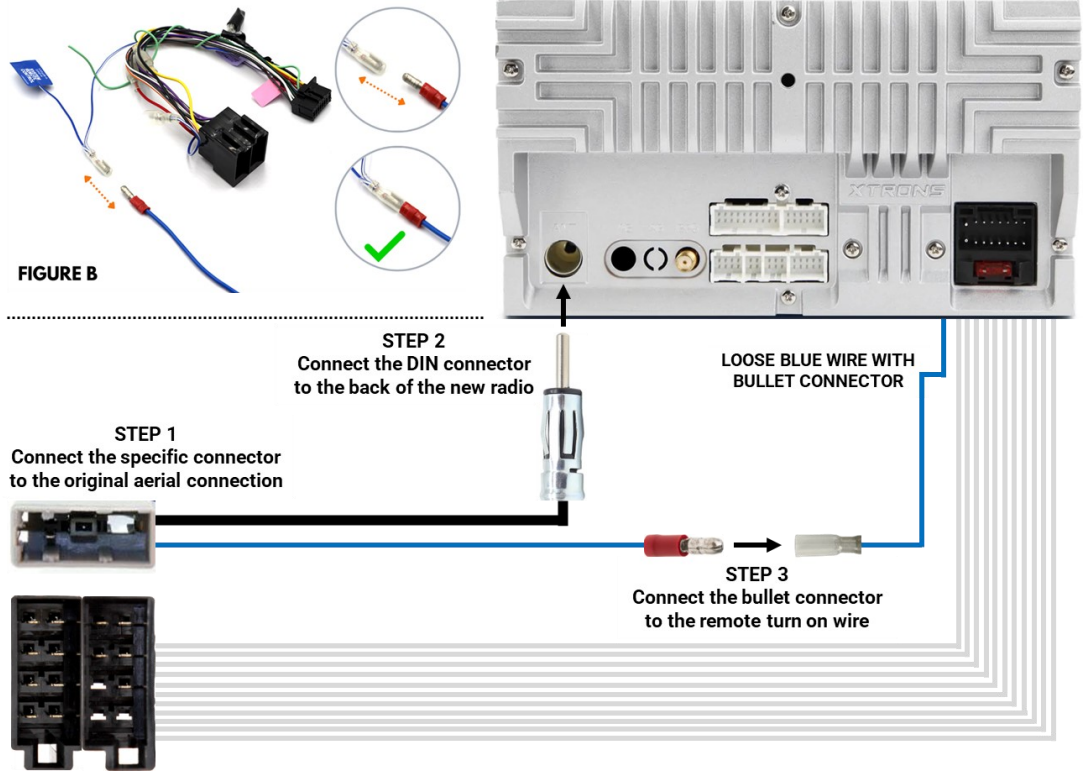

### OPTION TWO

If a loose antenna turn on wire is provided then strip a small amount of insulation and attach the provided female bullet connector (Figure C)

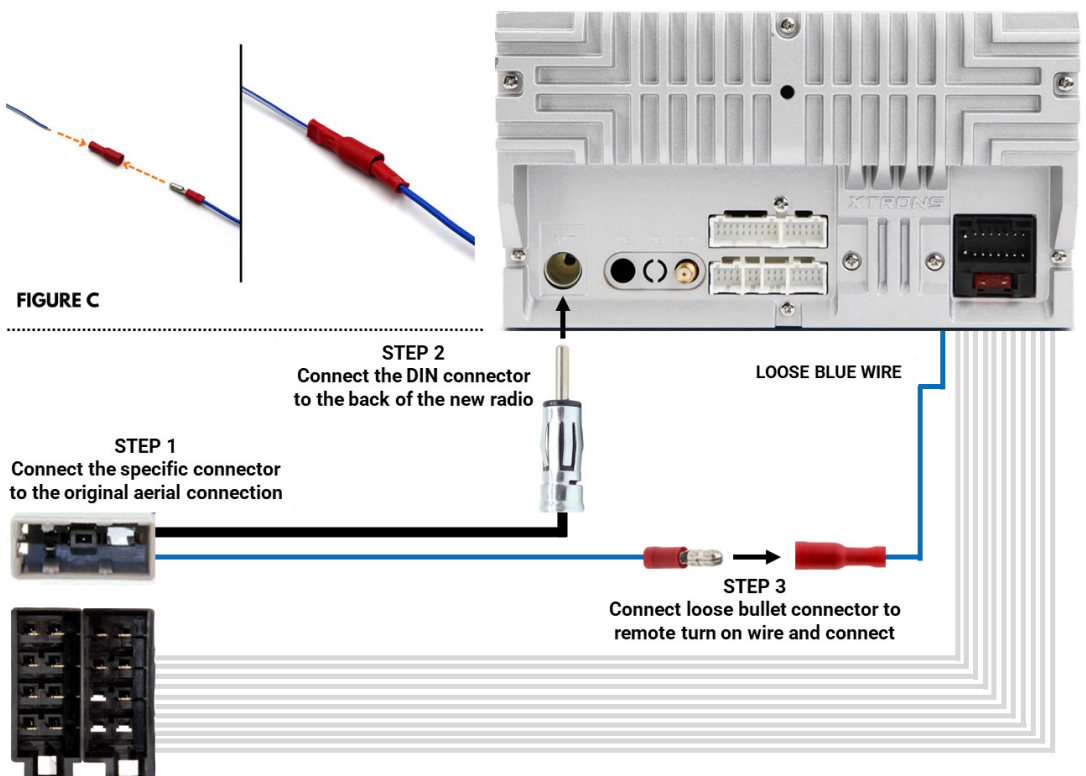

If no bullet or loose wire is available then cut off the male bullet and use the supplied T-Tap to splice into the antenna turn on wire (Figure D)

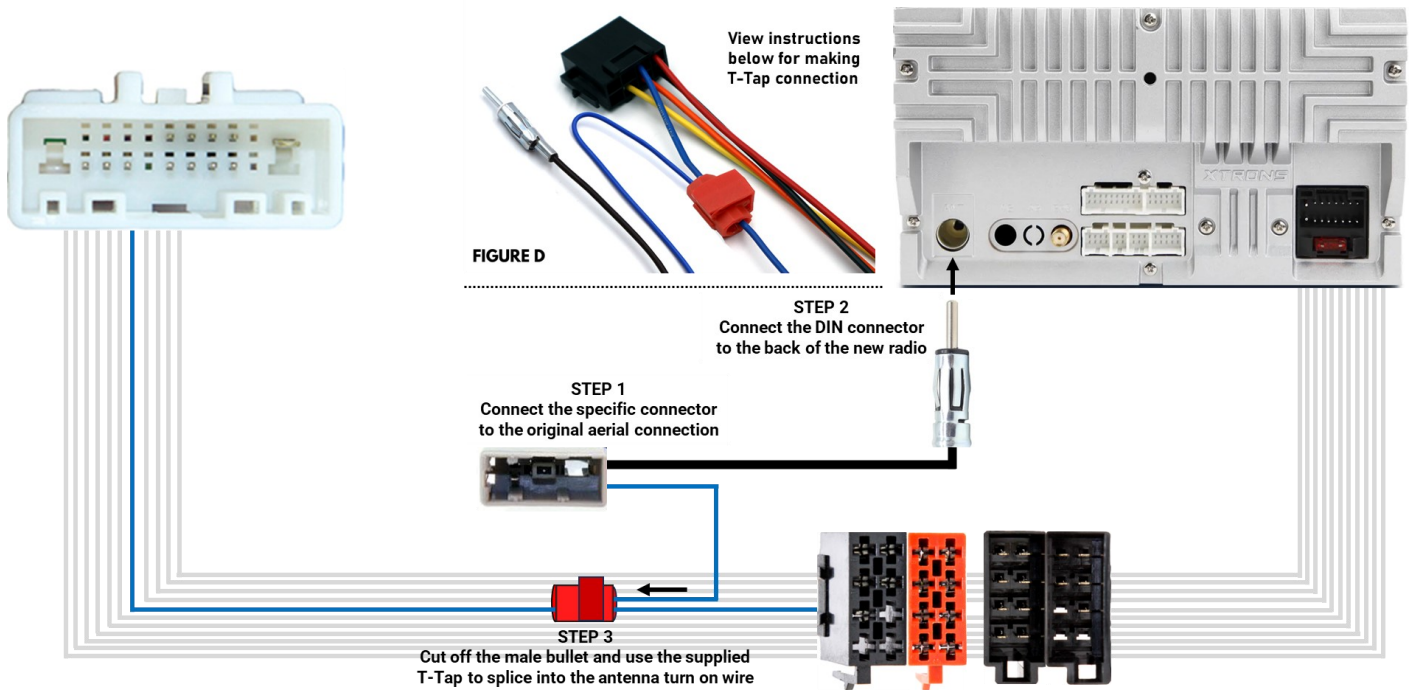

1. Locate the remote output wire on the radio wiring loom/ ISO harness. Usually blue or blue/

2. Attach the T-Tap connector. The remote wire should pass all the way through the connector

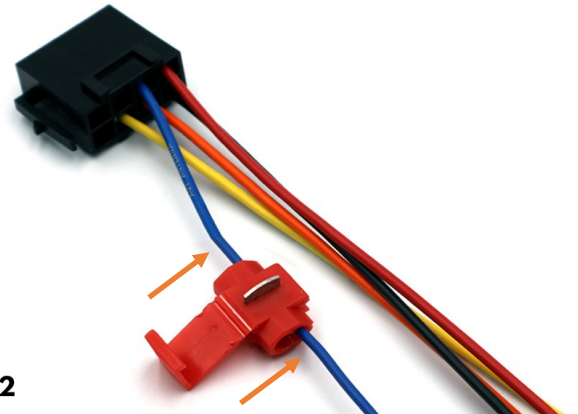
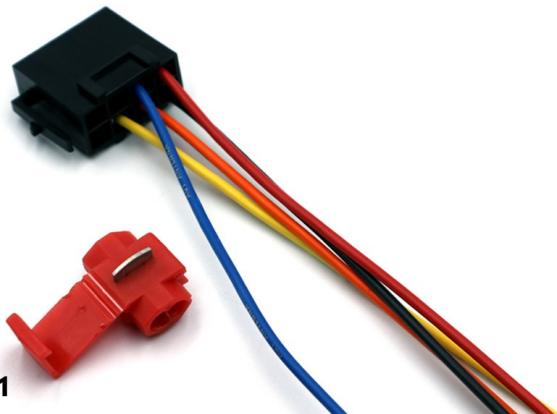

3. Cut the male bullet connector off the antenna amplifier wire and insert it into the other side

4. With both wires inserted, close the T-Tap firmly so that the internal blade cuts through

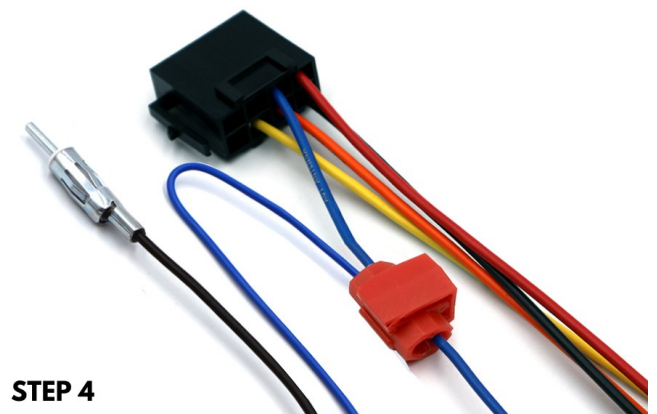
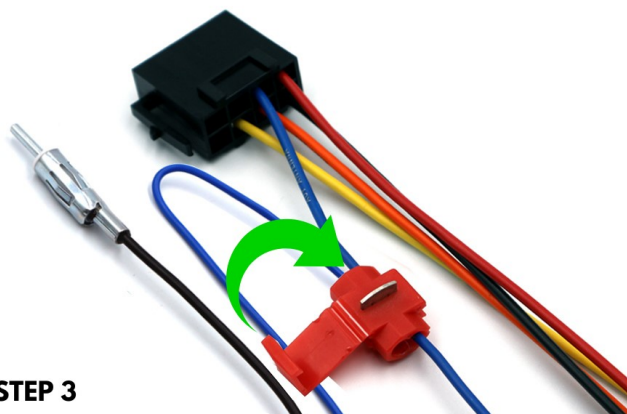

**! Test the aftermarket unit fully, ensuring all the functions are working properly before fixing the new head unit into the dashboard !**

## Aftermarket fascia (50-644) assembly

1. Attach the radio brackets to the new radio trim panel (Figure A)
2. If fitting a Single DIN radio, mount the pocket to the bracket/ trim panel assembly with the (4) #8 x 3/8"Phillips screws supplied. (Figure B)
3. Slide the radio into the assembly and secure with screws supplied with the radio. (Figure C)
4. Mount the new radio into the dash and reassemble the original panels in the reverse order of disassembly.

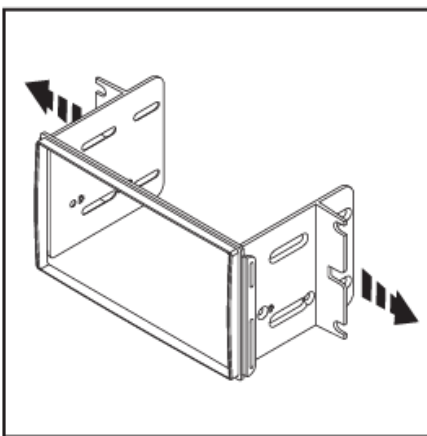

(Figure A)

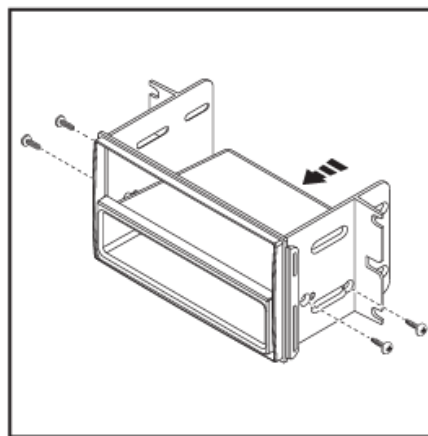

(Figure B)

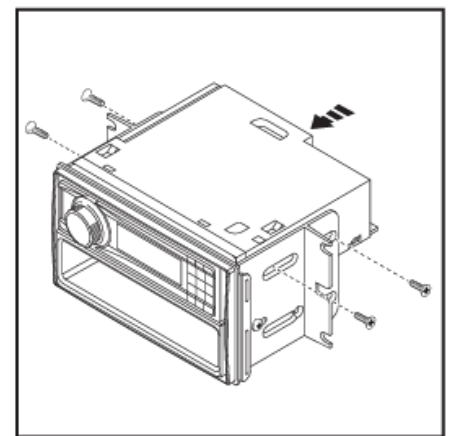

(Figure C)

## Trouble Shooting

### *I have poor FM reception*

Make sure that any connection made to the blue wire is secure and that 12v is being output to the antenna adapter. If using the female bullet connection, make sure it is crimped securely.

If using a T-Tap connector, make sure that it has been closed fully (the arm of the T-Tap should be clipped to the underside) and that the inner blade has cut through the insulation of the cables to make a connection between them.

Check the quality of the FM reception using the original radio. If this is also poor then the antenna is likely to be at fault.

