

Installation Instructions

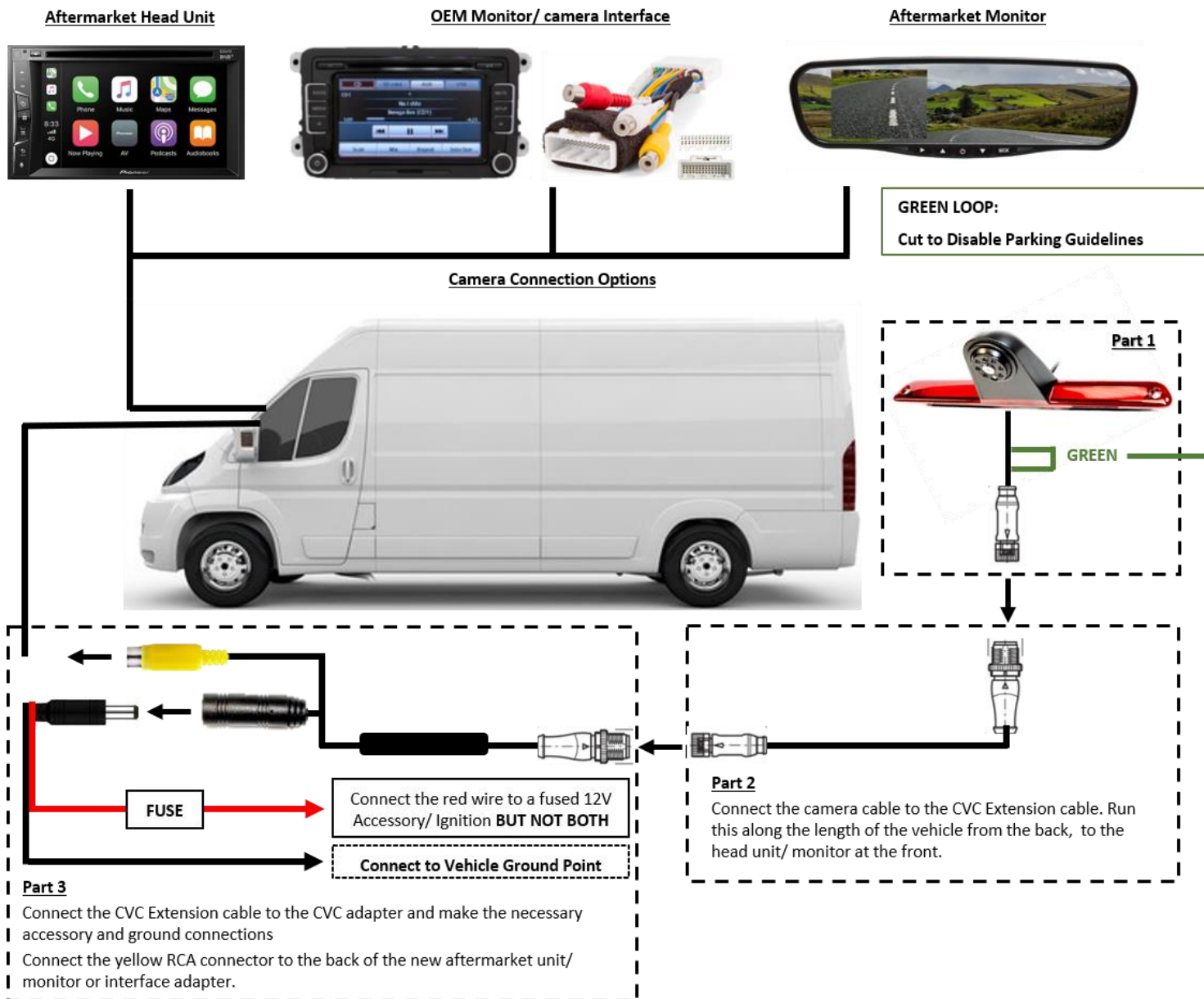

1. Install your monitor or aftermarket head unit. To auto switch the monitor to reverse image, Connect the reverse trigger of the monitor to the reverse light feed or if using a CANbus steering control adapter use the reverse feed supplied.
2. Start fitting the camera by connecting one end of the phono extension cable (part 3) to the female phone cable that connects to the screen that is being used, this may be a standard system or an after-market screen. The connection may also be found on a separate interface loom depending on your vehicle.
3. Connect the red wire of part 3 to a 12V power supply that is **ignition live** (we recommend via a 1 Amp fuse). **unless the vehicle has fitted or being fitted with a reverse camera input interface into the back of the Head Unit in which case this will have a cable for the 12V power supply to connect the red wire from part 3.**
4. Connect the black wire on part 3 to a ground point on the vehicle (as shown in the diagram).
5. Connect the CVC adapter plug (4 PIN male connector in part 3) to the CVC extension cable (4 PIN female connector of part 2).
6. Run the extension cable to the back of the vehicle and connect part 2 (4 PIN female connector) with part 1 (4 Pin male connector of the camera wire)
7. Cut the Green wire loop on part 1 if you wish to disable the guide lines shown on the screen when reversing.
8. Test the camera fully ensuring it comes on when the reverse gear is selected before fitting the camera and all wiring permanently.

Troubleshooting

- Check the power supply to the camera and monitor. **DO NOT USE THE POWER TO THE REVERSING LIGHTS.**
- Check all the plugs are firmly connected and have not been damaged with the arrows facing each on the camera plug.
- Check the ground connection is secure.
- Check that the monitor being used (Standard to the vehicle or after-market) is compatible with a NTSC signal.

For connecting camera to monitor/ display please see over sheet

For monitor/ display connection

Connecting
Reverse
Feed
Options

Option 1



Option 2



Option 3



On aftermarket head units like a Pioneer, you will need to use the reverse feed from the CANbus stalk adapter. This is usually a violet/white wire on the Head Unit or the purple wire on one of our steering wheel control interfaces

On original OEM screens or camera adapters, the reverse feed is usually pre-wired. If not, use the dedicated 12v reverse light supply (OPTION 3) Most OEM head-units will need to be coded using car manufacturers coding tools (ODB tools) or activated for reverse camera input using engineering menu's

If there is no dedicated reverse feed at the aftermarket or original OEM head unit then you will need to use the dedicated 12v reverse light supply. This is found at the rear/ reversing lights.

