

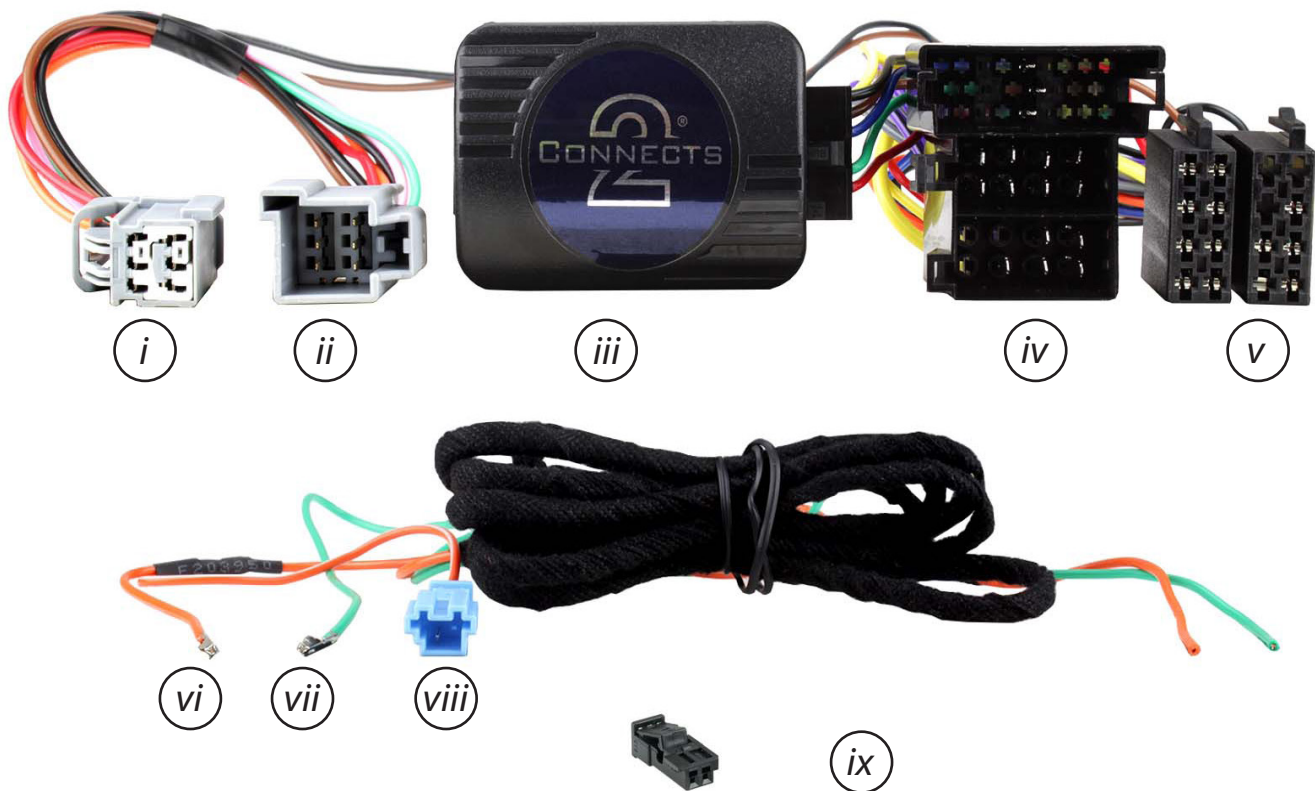

CTSFA026.2

Steering Wheel Control Interface for Fiat vehicles



- i. 6-way connector (6-pin)
- ii. 6-way connector (6-pin)
- iii. Interface Box
- iv. Vehicle Specific Connector
- v. ISO Connector (16-pin)

- vi. Reverse Gear wire output (Orange)
- vii. Speed Pulse wire output (Green)
- viii. Reverse/Speed wire input (2-pin)
- ix. 2-pin connector housing

Designed and
Engineered
in the UK. 

APPLICATION

Note: Application data is subject to change at any time

Fiat Ducato (8 Series)

2021 - UP

For open dash vehicles only.

FEATURES

- Retains Factory Steering Wheel Control Functions
- Retains Phone Button Functionality
- Includes Additional Wiring set for both Speed Pulse & Reverse Gear Outputs

DISCLAIMER

The information provided in this document is subject to change without notice due to manufacturer changes and/or improvements to the product/s. This instruction manual is based on documented data and research. The manufacturer of this product cannot be held responsible for any changes made to the vehicle by the manufacturer or damages that may occur through the installation of this product in accordance with the steps outlined herein.

PRODUCT INFORMATION

The **CTSFA026.2** is an analogue steering wheel control interface for Fiat Ducato motorhome vehicles which come without factory stereos. This interface helps to retain the steering wheel controls and phone button functionality when upgrading to an aftermarket stereo.

WIRING KEY

IN WIRING HARNESS

| | | | |
|--------------|-----------------------|--------|----------------|
| Purple | Right Rear Speaker + | Yellow | Permanent 12V |
| Purple/Black | Right Rear Speaker - | Black | Ground |
| Green | Left Rear Speaker + | Red | Ignition 12V |
| Green/Black | Left Rear Speaker - | Orange | Illumination |
| Grey | Right Front Speaker + | Blue | Antenna Remote |
| Grey/Black | Right Front Speaker - | | |
| White | Left Front Speaker + | | |
| White/Black | Left Front Speaker - | | |

ADDITIONAL CONNECTIONS

| | |
|--------|--------------|
| Green | Speed Pulse |
| Orange | Reverse Gear |

STEERING WHEEL CONTROL FUNCTIONALITY

The following diagram, though based on careful research, is an example only. Individual steering wheel control configurations may differ.

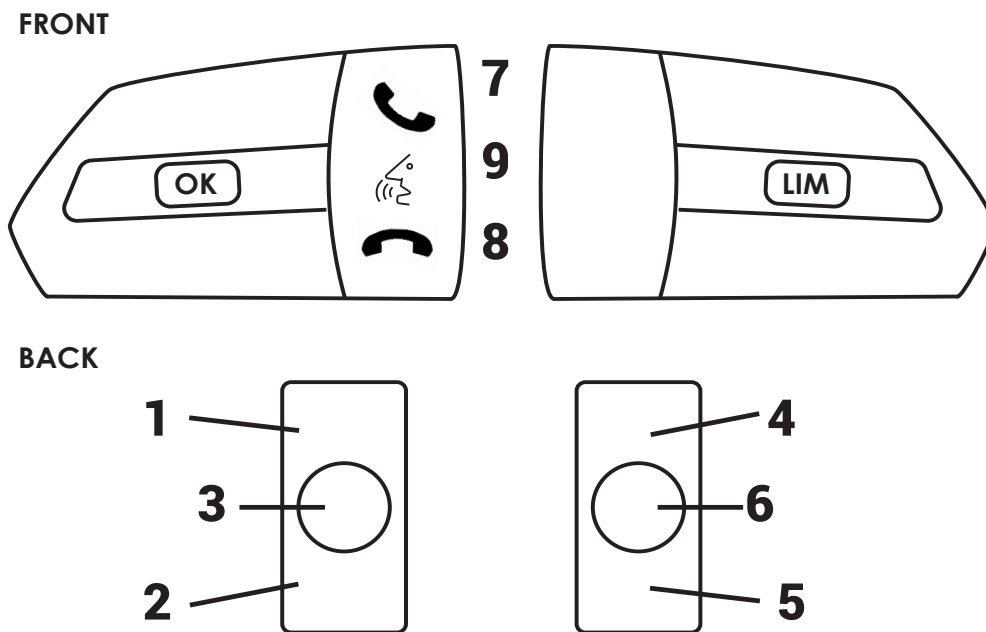

- | | |
|----------------|------------|
| 1. Track Up | 6. Mute |
| 2. Track Down | 7. Pick Up |
| 3. Source | 8. Hang Up |
| 4. Volume Up | 9. Speech |
| 5. Volume Down | |

Please note: Steering wheel controls dealing with car menus and cruise control on the front are unaffected.

PRIOR TO INSTALLATION

Read the manual prior to installation. Technical knowledge is necessary for installation. The place of installation must be free of moisture and away from heat sources. Please ensure that the correct tools are used during the installation to avoid damage to the vehicle or product. **Connects2 can not be held responsible for the installation of this product.**

Before installing the interface, the factory stereo must be removed and disconnected. To do this, please consult the vehicle owner's manual/handbook or contact a fitting professional.

INSTALLATION GUIDE

See wiring diagram on Pg.4 for more information

A stereo connection (patch) lead is also required for the installation of this interface (supplied separately). Please ensure that you have the correct lead before proceeding. For universal patch leads, prepare the wiring loops in accordance with the instruction manual supplied with the product before installation.

1. Connect the 12 Pin connector from the stereo connection (patch) lead to the interface box.
2. Connect the opposite end of the stereo connection (patch) lead to the steering wheel control input on the back of the aftermarket stereo.

NOTE: This may be a 3.5mm jack connector or a wired input depending on the brand of aftermarket stereo being fitted. Please consult the aftermarket stereo installation manual for further information on where to make the connection.

IMPORTANT: THIS STEP MUST BE COMPLETED BEFORE CONNECTING POWER TO THE INTERFACE. FAILURE TO DO SO MAY RESULT IN A LACK OF FUNCTIONALITY AND THE NEED TO RE-INSTALL THE PRODUCT.

3. Connect the 14 Pin connector from supplied wiring loom to the interface box.

4. Connect the 6 Pin male connector to the grey vehicle specific connector (this will either be located toward the bottom of the dash loose, or connected via the cup holder of the vehicle - do not connect to the orange variant).

Note: if the vehicle comes equipped with a qi-charger, disconnect the charger connector and utilise the male and female in between these to act as a t-harness.



5. Route the pin end of the speed/reverse wires from the main dash aperture through and down toward the fuse panel. The bare ended wires will remain in the dashboard aperture for use on the new head unit.

6. Disconnect both the green and black connectors located at the fuse box.

7. Take the green connector and remove the blue/white wire from pin location 17 from the back of the housing. Then take the orange reverse wire from the supplied harness and plug it into the original place.

NOTE: When removing the blue/white wire from the original location, try to ensure that the retaining clip does not get damaged. If this does bend in anyway, gently bend back into shape for reuse.

8. Take the original blue/white wire from the vehicle and place this into one of the 2-pin housings. Once done, insert this 2-pin assembly into the blue housing on the supplied harness.

NOTE: the location of the blue/white wire must match the location seen from behind the blue connector.

9. Take the black connector and proceed to insert the green speed wire into pin location 22 on the back of the housing.

NOTE: before making any of these connections, make sure that the signals are present, as pin positions may vary dependent on vehicle.

10. Connect the power/speaker ISO connector to the power/speaker ISO connector at the rear of the aftermarket stereo.

NOTE: For aftermarket stereos which do not have an ISO connector, please see "Wiring Key" on Pg.2 for information on which wires to connect. Some interfaces may also have additional 'flying' wires which can be connected to the vehicle to support various features ie. parking brake trigger, reverse gear and speed pulse. Details of these can be found under 'Additional Connections'.

11. Connect the female Mini ISO connector on the harness to the male equivalent connectors from the vehicle and test stereo and steering wheel control functionality for correct operation before reassembling the vehicle dashboard. If steering wheel control functions are unresponsive, please uninstall the interface and wiring and re-install carefully in accordance with the above steps.

Need help? Visit support.connects2.com/tickets/technical

WIRING DIAGRAM

