

This cable is designed for fitting radios that have resistive programmable steering wheel controls with loose wire connections.

These are usually labelled SWC GND, SWC1 and SWC2 or KEY GND, KEY1 and KEY2.

Compatible with various vehicle models:

Nissan

Nissan 370Z (09>), Cube (10), Juke (10-19), Leaf (11-17), Micra (07>), Navara D40 (05-16), Note (06-18), NV200 (10>), NV400 (11-20), Pathfinder R51 (05-13), Qashqai (07-13), Tiida (04-11) and X-Trail (07-14)

Renault

Kangoo (12-21), Master (10-19) and Twingo (14>)

Vauxhall/ Opel

Movano (10-19)

Installation

1. Connect the black and brown male ISO connections to the corresponding female ISO connections from the back of the radio. If your radio has loose wires rather than ISO connections, please use an ISO adapter such as a Incartec 20-022 to add them to your radio.
2. Connect the KEY / SWC wires from the cable to the corresponding cables on the radio. Female bullet connectors are supplied to add to the loose wires of the radio to connect to the male bullet connections on the cable. Make sure the insulation is stripped from the ends of the wires and that they are crimped securely.
3. If the radio does not have KEY GND or SWC GND then use the supplied loose wire with a ground ring terminal to connect to either the chassis of the radio or a chassis ground on the vehicle.
4. Connect the vehicle specific connectors into the cars original wiring. Connect the ground loop that is attached to the harness (the main earth lead for the radio) to a chassis ground on the vehicle.
5. Turn on the aftermarket radio and programme the steering wheel controls on the radio as per the manufacturers instructions.

INSTALLATION DIAGRAMS ARE AVAILABLE OVERLEAF.

Troubleshooting

None, or only some of my steering wheel controls are being detected by the new radio.

Check that the supplied bullet connections have been crimped securely and that the insulation was stripped from the ends of the SWC wires on the radio before they were crimped.

If your radio doesn't have KEY GND or SWC GND and you have used the supplied ground loop then check that it is fastened securely to either a vehicle chassis ground or the metal chassis of the radio

Make sure that the controls have all been programmed in using the menus on the radio. The exact steps for this will vary depending on the radio.

The volume control goes from very quiet to very loud with very little adjustment.

If your car has BOSE or another amplified sound system then the sound will be getting amplified by the built in amplifier in the new radio and the original amplifier. You will need an amplifier interface to bring the levels back down to a low level, pre-amplified signal. Our part is Incartec 20-273.

Radios with SWC/KEY Ground wire

Connect to vehicles original radio connector

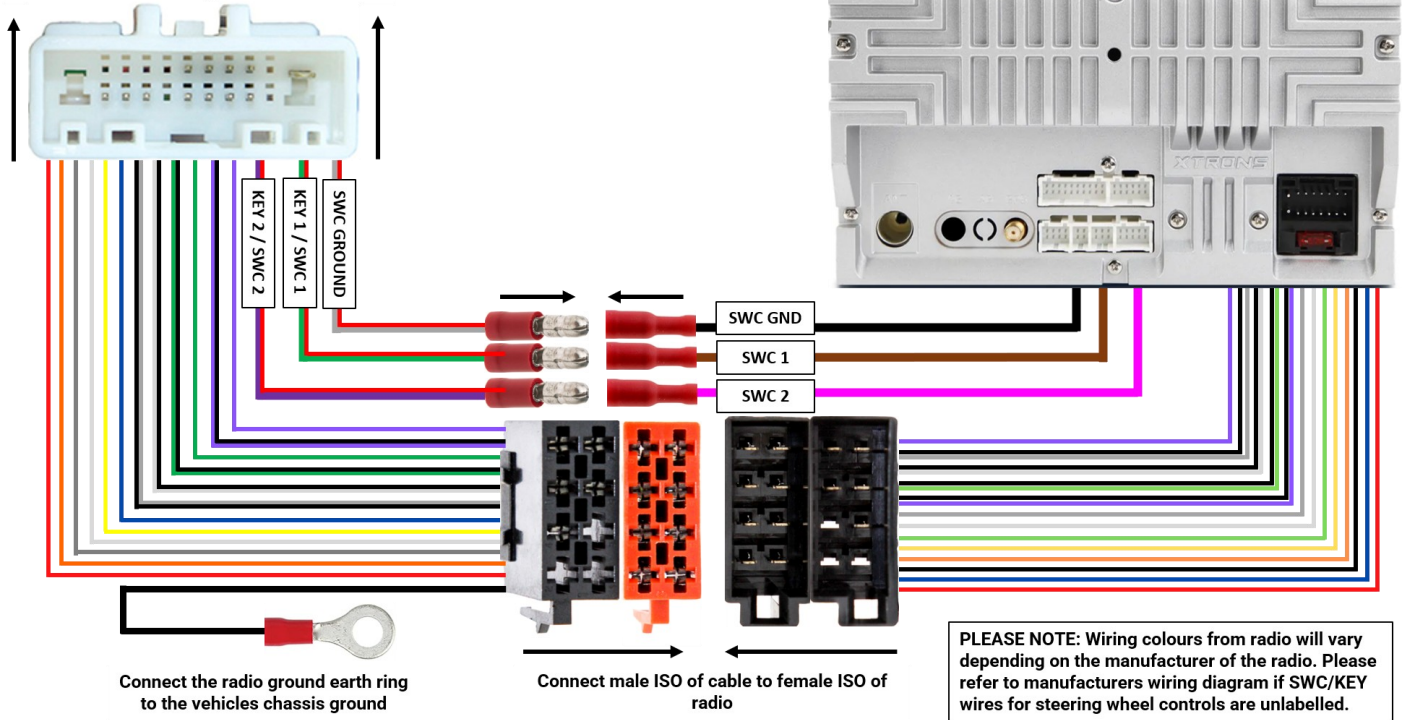

Radios Without SWC/KEY Ground Wire (use Ground Ring Terminal)

Connect to vehicles original radio connector

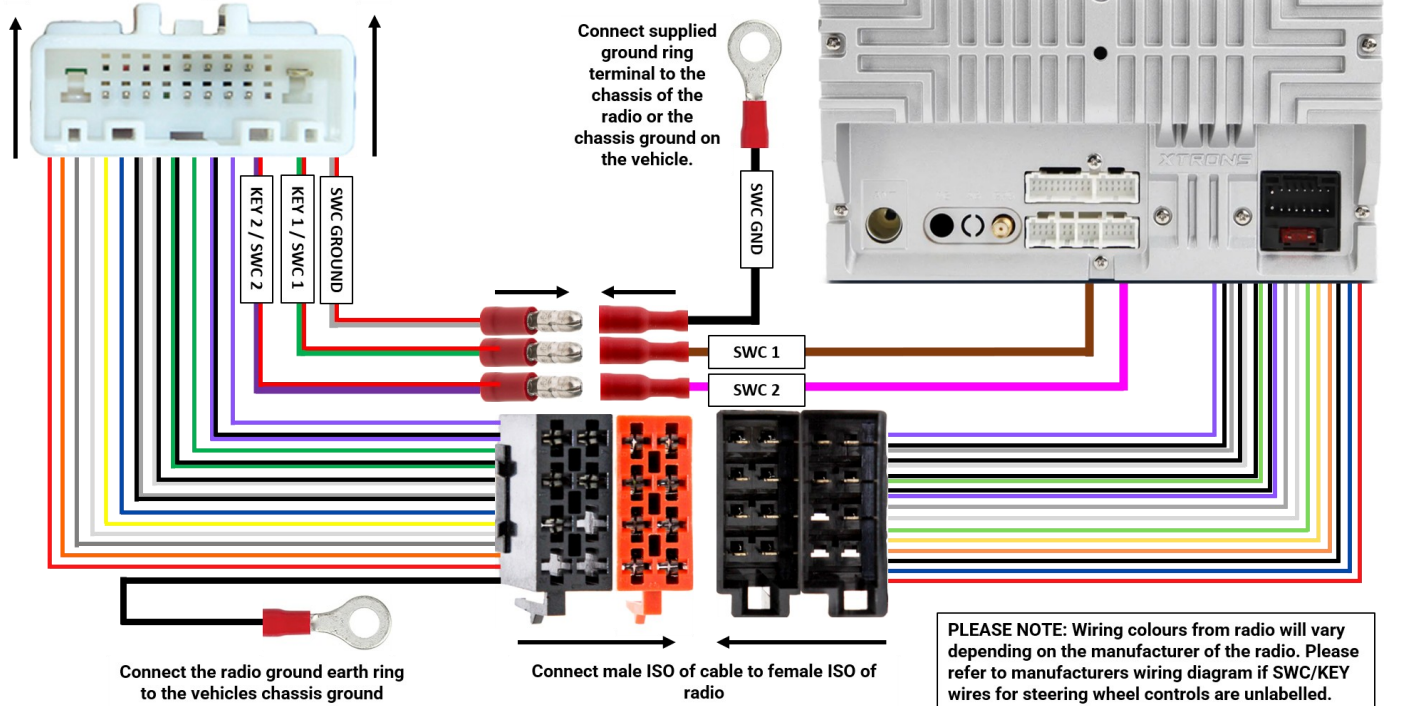

Speaker ISO Wiring Colours	
White	Left Front +
White/Black	Left Front -
Grey	Right Front +
Grey/Black	Right Front -
Green	Left Rear +
Green Black	Left Rear -
Purple	Left Rear +
Purple/Black	Left Rear -

Power ISO Wiring Colours	
Black	Ground
Red	12v Ignition
Blue	12v Remote Turn On
Orange	Illumination
Yellow	12v Permanent

Steering Wheel Control Wiring Colours	
Grey/Red	SWC / KEY Ground
Green/Red	SWC 1 / KEY 1
Purple/Red	SWC2/ KEY2