

50-398 Installation Manual

Colour: Black

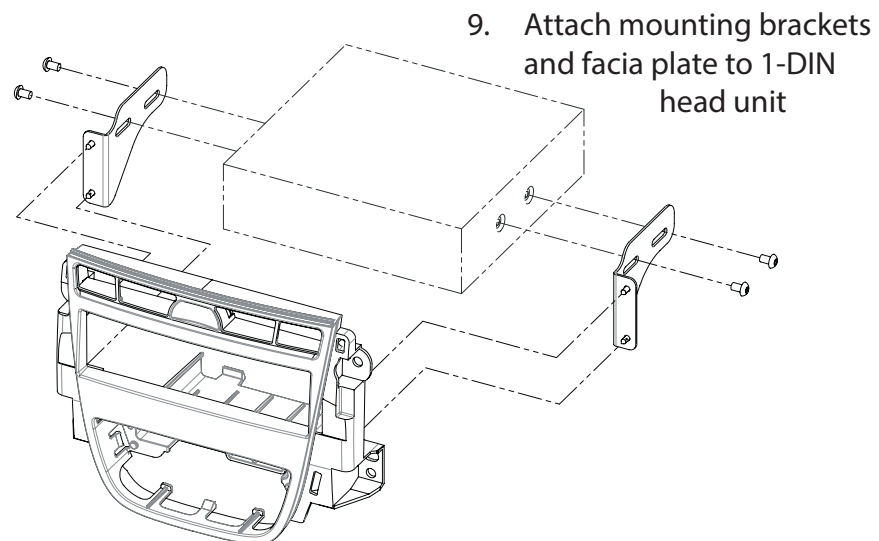

10. Remove switches and control unit from OEM panel



11. Mount switches and control unit to fascia plate

Opel Meriva ->

Compatible with 1-DIN head units

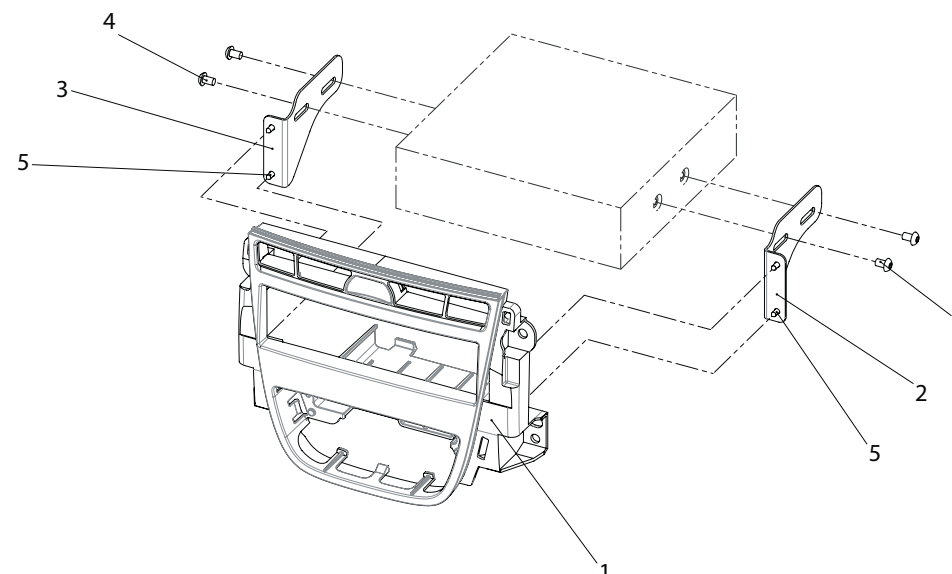

Kit Content

- | | |
|----------------------------|------------------------------------|
| (1) Fascia Plate | (3) Mounting bracket left |
| (2) Mounting bracket right | (4) flat headed screw |
| | (5) self-tapping screw with collar |



1. Opel Meriva OEM dash board

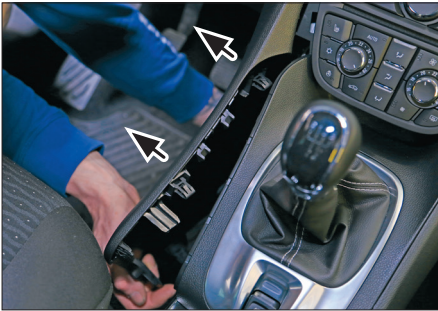

2. Unclip and remove side panels at the left and right side



3. Remove 4 screws of OEM front panel (see arrows)



4. Unclip and remove panel under the gear box (see arrows)



5. Pull gear box panel slightly into your direction (See arrows)



6. Pull front panel carefully into your direction in order to unplug all connectors and cables.

Remove front panel

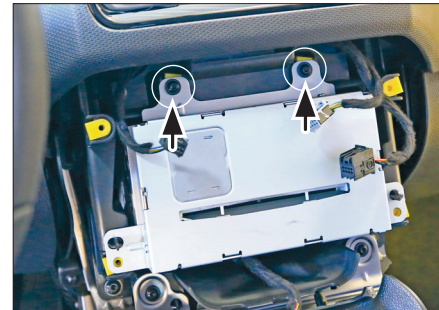

7. Remove two screws of OEM head unit

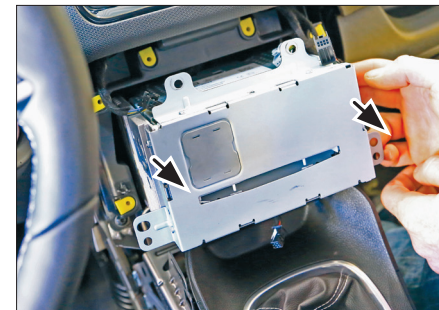

8. Unplug all cables and connectors carefully

Remove OEM head unit by pulling it towards your direction