

**INSTALLATION INSTRUCTIONS
50-967**

APPLICATIONS

Jeep Liberty 2002-2007

KIT FEATURES

- Double DIN radio provision
- **Painted matte black**

KIT COMPONENTS

- A) Radio trim panel • B) Brackets

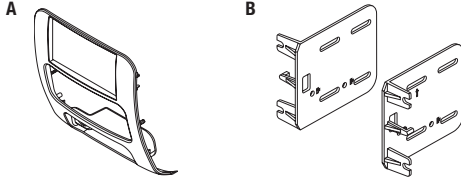

Table of Contents

Dash Disassembly

- Jeep Liberty 2002-2007 2

Kit Assembly

- Double DIN radio provision 3

TOOLS REQUIRED

- Phillips screwdriver • Panel removal tool
- Socket wrench • Dremel or cutting tool

CAUTION: All accessories, switches, and especially air bag indicator lights must be plugged in before reconnecting the battery or cycling the ignition.

NOTE: Refer to the instructions included with the aftermarket radio.

Dash Disassembly

1. Remove ashtray and remove one Phillips screw exposed. (Figure A)
2. Unclip and remove radio/climate control trim panel.
3. Remove (4) Phillips screws securing radio. Disconnect and remove radio.
4. Remove the factory climate controls.
5. Unclip and remove the 12-volt power plug.
6. Remove the factory panel clips and save for kit assembly.
7. Cut and remove the factory radio shelf (shaded area) from the sub-dash to make room for the aftermarket DDIN radio. (Figure B)

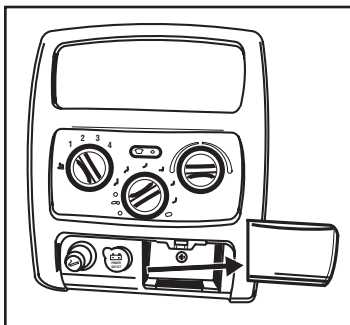

(Figure A)

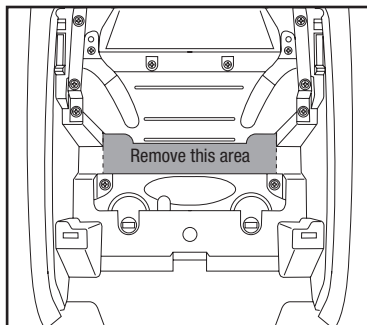

(Figure B)

Continue to kit assembly

Kit Assembly

Kit preparation

1. Attach the factory panel clips to the radio trim panel. (Figure A)

2. Attach the factory climate control to the radio trim panel. (Figure A)
3. Attach factory 12-volt power plug to the radio trim panel. (Figure A)

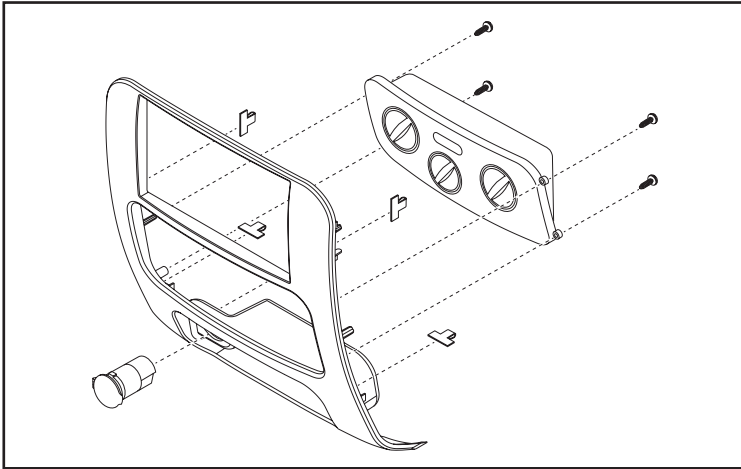

(Figure A)

Double DIN radio provision

1. Mount the radio to the double DIN brackets with screws included with radio. (Figure A)
2. Locate the factory wiring harness and antenna plug in the dash.
3. Mount assembly into the sub dash.
4. Reassemble dash in reverse order of disassembly using the trim panel instead of factory panel.

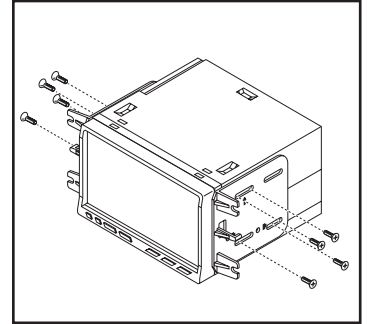

(Figure A)