

Volvo S60/V70 2001-2004 50-961

KIT FEATURES

- ISO DIN radio provision with pocket
- ISO DDIN radio provision
- *Painted to match factory finish*



KIT COMPONENTS

- A) Radio trim panel • B) Radio housing • C) Pocket • D) (4) #8 x 3/8" Phillips screws • E) (4) Panel clips

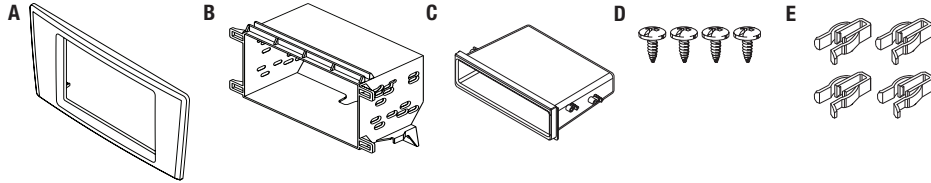

- Panel removal tool • Phillips screwdriver • T-25 Torx driver

Table of Contents

Dash Disassembly	2
Kit Assembly	
– ISO DIN radio provision with pocket.....	3
– ISO DDIN radio provision	3

CAUTION! All accessories, switches, climate controls panels, and especially air bag indicator lights must be connected before reconnecting the battery or cycling the ignition. Also, do not remove the factory radio with the key in the on position, or the vehicle running. It would be best to remove the key from the ignition and then wait a few seconds before removing the factory radio.

Dash Disassembly

1. Remove the panel between the climate control and gear selector. (Figure A)
2. Move the gear selector as far back as possible, unsnap the panel surrounding it, and then rotate it 45 degrees either way. (Figure B)
3. Remove (2) T-25 screws now exposed securing the climate control panel to the vehicle, and then remove. (Figure C)

Continue to 3 a.

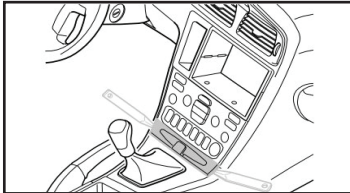

(Figure A)

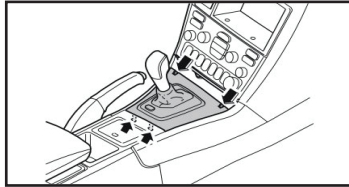

(Figure B)

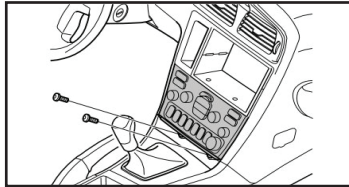

(Figure C)

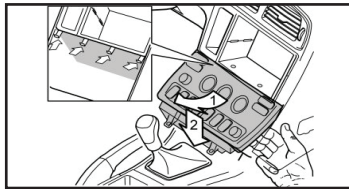

(Figure D)

- a. Angle the panel outwards so that it is possible to insert a couple of fingers between the center console and the side of the panel. (Figure D)
 - b. Remove the panel by pulling it downward, maintaining the same angle. Some force is required because the panel is tightly installed. (Figure D)
 - c. Do not unplug the connectors. Place the panel to one side instead.
4. Remove (2) T-25 Torx screws securing the radio, and then remove. (Figure E)
 5. Remove the sub-dash bracket from the radio, and then remove.
 - a. Remove (5) T-25 Torx screws securing the bracket. (Figure F)
 - b. Depress the snaps on the top and bottom of the pocket. (Figure G)

Continue to kit assembly

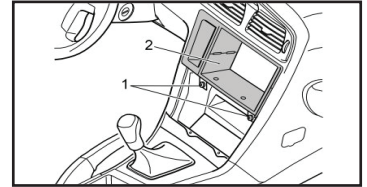

(Figure E)

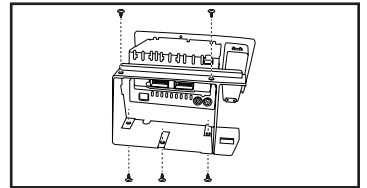

(Figure F)

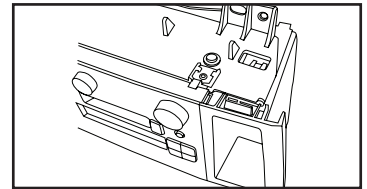

(Figure G)

Kit Assembly

ISO DIN radio provision with pocket

1. Secure the *pocket* to the *radio housing* using (4) #8 x 3/8" Phillips screws provided. (Figure A) **Note:** *Rounded edge of pocket faces towards the bottom.*
2. Remove the metal DIN sleeve and trim ring from the aftermarket radio.
3. Slide the radio into the completed assembly, and then secure it to the assembly using screws supplied with the radio. (Figure A)
4. Locate the factory wiring harness and antenna connector in the dash, and complete all necessary connections to the radio.
5. Reassemble the dash in reverse order of disassembly.
6. Attach (4) *panel clips* supplied to the *radio trim panel*, and then snap the panel over the radio.

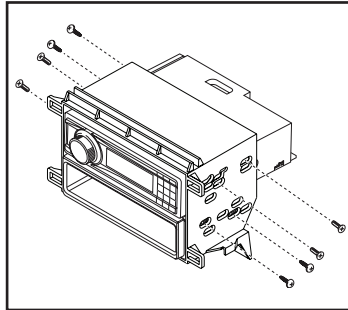

(Figure A)

ISO Double DIN radio provision

1. Slide the radio into the *radio housing* and secure it using screws supplied with the radio. (Figure A)
2. Locate the factory wiring harness and antenna connector in the dash, and complete all necessary connections to the radio.
3. Reassemble the dash in reverse order of disassembly.
4. Attach (4) *panel clips* supplied to the *radio trim panel*, and then snap the panel over the radio.

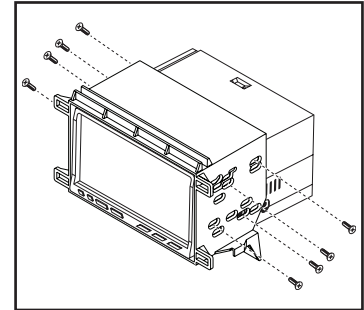

(Figure A)