

Chrysler PT Cruiser 2006-2010 Dodge Durango 2004-2007 Jeep Grand Cherokee 2005-2007 50-955

KIT FEATURES

- ISO DDIN radio provision
- *Painted matte black*



KIT COMPONENTS

- A) Radio trim panel • B) Cutting template • C) Radio trim panel retainers • D) Radio brackets • E (4) #8 x 3/8" Phillips screws

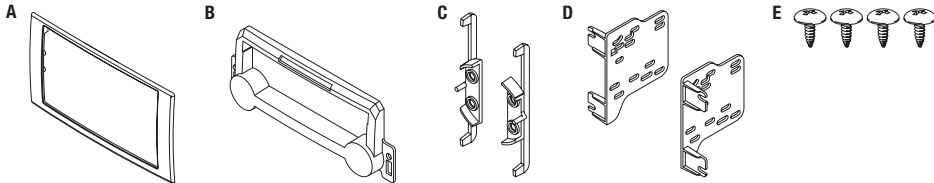

Table of Contents

Dash Disassembly	2
Kit Assembly	3

TOOLS REQUIRED

- Panel removal tool • Phillips screwdriver
- Cutting tool • File • 7mm socket wrench

Dash Disassembly

Jeep Grand Cherokee

1. Unsnap and remove the panel from around the radio including the vent on each side. (Figure A)
2. Remove (4) 7mm screws securing the radio, then unplug and remove the radio.

Continue to kit assembly

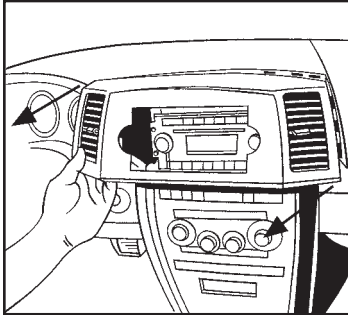

(Figure A)

Chrysler PT Cruiser

1. Remove (2) screws from inside the air vents on the center dash panel. (Figure A)
2. Unsnap the center dash panel (do not remove until the climate controls are removed). (Figure A)
3. Remove (4) Phillips screws securing the climate control panel to the backside of the center dash panel.
4. Remove (4) 7mm screws securing the radio, then unplug and remove the radio.

Continue to kit assembly

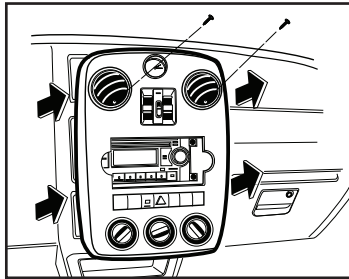

(Figure A)

Dodge Durango

1. Remove (2) 7mm screws from the inside of the pocket facing upward. (Figure A)
2. Unclip and remove the entire trim panel surrounding the radio and climate controls. (Figure B)
3. Remove (4) 7mm screws securing the radio, then unplug and remove the radio.

Continue to kit assembly

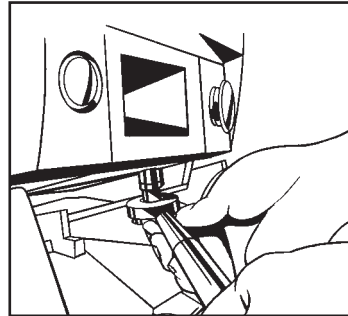

(Figure A)

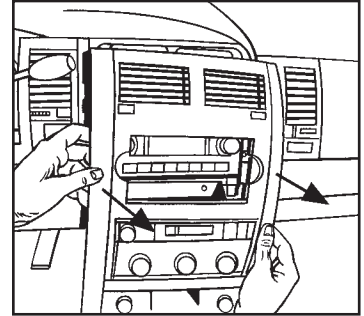

(Figure B)

Kit Assembly

ISO DDIN radio provision

1. The top of the radio opening in each application will need cut or filed to make room for the new DDIN radio. Temporarily attach the provided *cutting template* to the back of the dash panel using the locating pins and/or snaps to align it correctly. Mark the factory panel for cutting, remove the template, and cut and file accordingly. (Figure A)
2. Snap the *radio trim panel* over the front of the factory radio panel (the snaps will be at the top of the radio opening). (Figure B)
3. Secure the *radio trim panel retainers* to the *radio trim panel* using the #8 x 3/8" screws included with the kit.

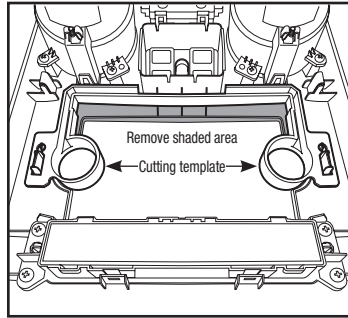

(Figure A)

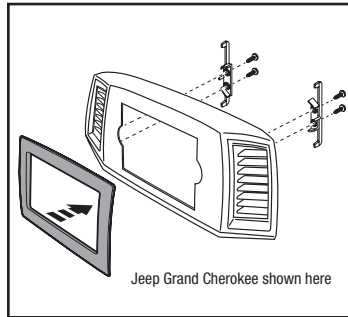

(Figure B)

4. Attach the *radio brackets* to the radio using the screws supplied with the radio. (Figure C)
5. Locate the factory wiring harness and antenna plug in the dash and make all necessary connections to the radio. Re-connect the negative battery terminal and test the radio for proper operation.
6. Reassemble the dash in reverse order of disassembly.

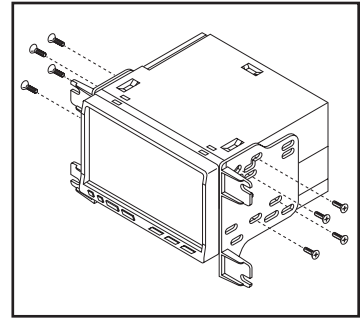

(Figure C)