

29-630-ISO

Non CAN Bus Steering Controls Interface for Chrysler/Jeep-(to use with amplifier interface 23-211)

Chrysler Voyager & Grand Voyager (2002-2008), Dodge Ram 3 (02-05)

Installation diagram

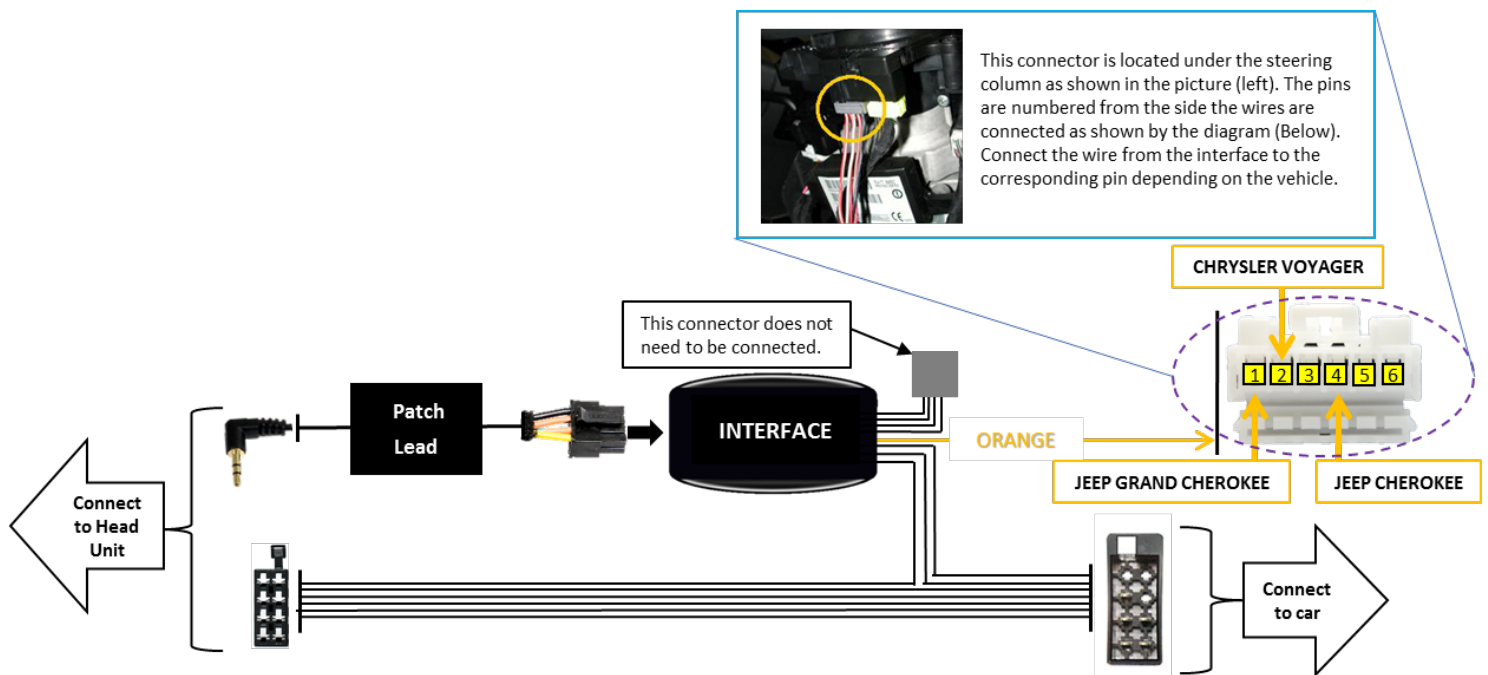

Installation Instructions

1. Ensure your vehicle's ignition is off with the key removed.
2. Remove the original Head Unit (radio) with reference to the manufacturer's instructions.
3. Assemble the Patch Lead (**NOT SUPPLIED IN 29-630-ISO**) with reference to the given instructions with the Patch Lead so that it is compatible with the Head Unit being installed.
4. Connect the patch lead to the new Head Unit and then to the Steering Control Interface (**Black box on 29-630-ISO harness**). **THIS MUST BE DONE FIRST BEFORE ANY OTHER CONNECTIONS.**
5. Connect the power iso between the new head-unit and the 23-211 Amplifier turn on interface.
6. With reference to the diagram above, connect the **ORANGE** wire from the interface to the 6-way connector found under the steering column.
Voyager connect to pin 2 GREY /WHITE
7. Test the system fully ensuring all controls function before refitting the new Head Unit.

Troubleshooting

- Check that the correct patch lead has been used and links in the connector are in the correct place (Always disconnect from the power supply if you change the lead).