

Dodge Durango 2011-2013 Jeep Grand Cherokee 2011-2013

KIT FEATURES

- Double DIN radio provision
- *Painted matte black to match factory*



KIT COMPONENTS

- A) Double DIN brackets

A

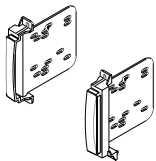

-
- Panel removal tool • Phillips screwdriver • Socket wrench • Cutting tool or file

Table of Contents

Dash Disassembly

- Dodge Durango 2011-2013 2
- Jeep Grand Cherokee 2011-2013 2

Kit Preparation 3

Kit Assembly

- Double DIN radio provision 3
-

Dash Disassembly

Dodge Durango 2011-2013

1. Unclip and remove the panel around the radio including the climate controls. (Figure A)
2. Remove (4) 7mm screws securing the radio and remove. (Figure B)
3. Remove (3) 7mm screws securing the radio bracket to the sub dash. (Figure C)

Continue to kit preparation

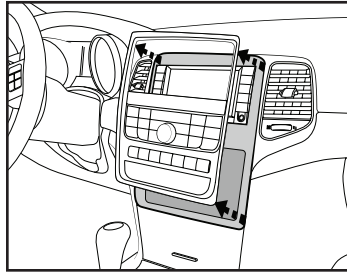

(Figure A)

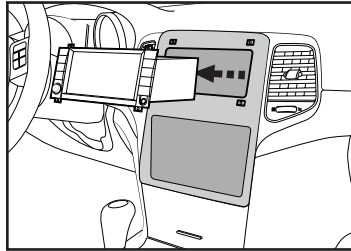

(Figure B)

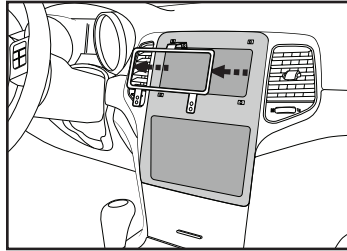

(Figure C)

Jeep Grand Cherokee 2011-2013

1. Unclip and remove the panel from around the radio including the vents and the climate controls. (Figure A)
2. Remove (4) 7mm screws securing radio to dash to remove. (Figure B)
3. Remove (3) 7mm screws securing the radio bracket to the sub dash. (Figure C)

Continue to kit preparation

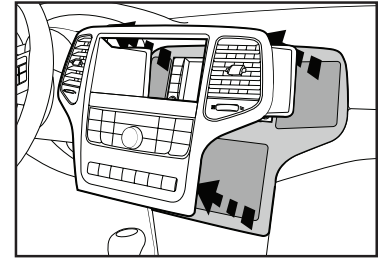

(Figure A)

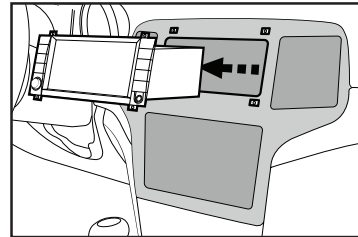

(Figure B)

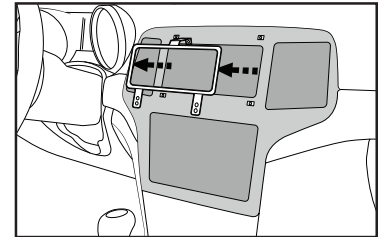

(Figure C)

Kit Preparation

1. Modification to the sub dash is necessary for the aftermarket double DIN radio to fit. You will need to trim the top and bottom of the sub dash cavity.

Continue to kit assembly

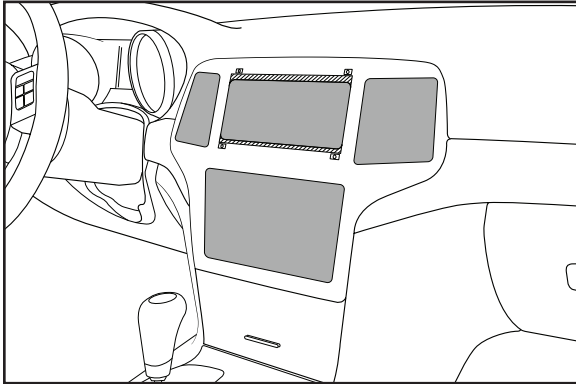

(Figure A)

Kit Assembly

Double DIN radio provision

1. Attach the double DIN brackets to the radio using the screws supplied with the radio. (Figure A)
2. Locate the factory wiring harness in the dash. Metra recommends using the proper mating adapter from
3. Reassemble the dash in reverse order of disassembly.

Metra or AXCESS. Re-connect the negative battery terminal and test the radio for proper operation.

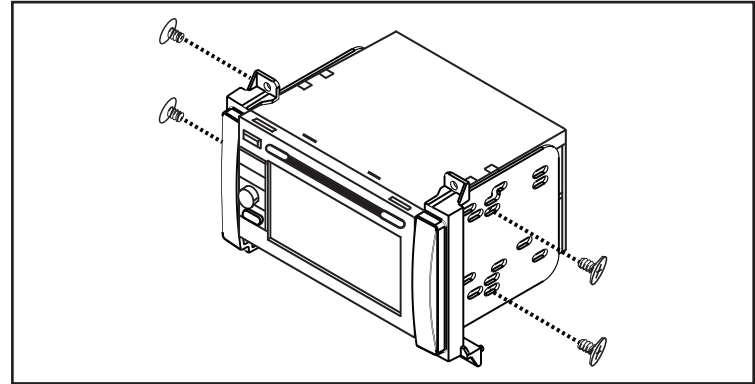

(Figure A)