

3. Connecting to the back of the air conditioning panel

1. Unplug 20-PIN connector from back of the air con panel and plug into female connector on interface cable.
2. Connect the male end of the interface cable to the back of the air con panel where the original connector was.

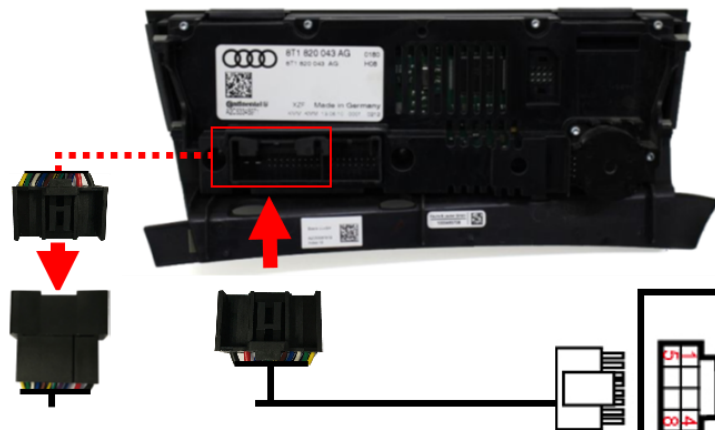

Wire Connections

4: +12V input	8: n/c
3: Can High	7: n/c
2: Can Low	6: n/c
1: Ground	5: n/c

1. Set DIP Switches

The switches need to be set before the interface is powered. If the switches need to be changed the interface will need to be disconnected from the power to reset.

Switch 1	OFF	Front camera disabled
	ON	Front camera enabled
Switch 2	OFF	Video in disabled
	ON	Video in enabled
Switch 3	OFF	Guidelines enabled
	ON	Guidelines disabled
Switch 4	OFF	Graphical radar enabled
	ON	Graphical radar disabled

2. Connecting to the back of the display

1. Unplug the 10-PIN rectangular connector from the rear of the car display screen and connect it to the interface cable.
2. Connect the other end of the interface cable to where the original cable was connected (back of the car display screen)

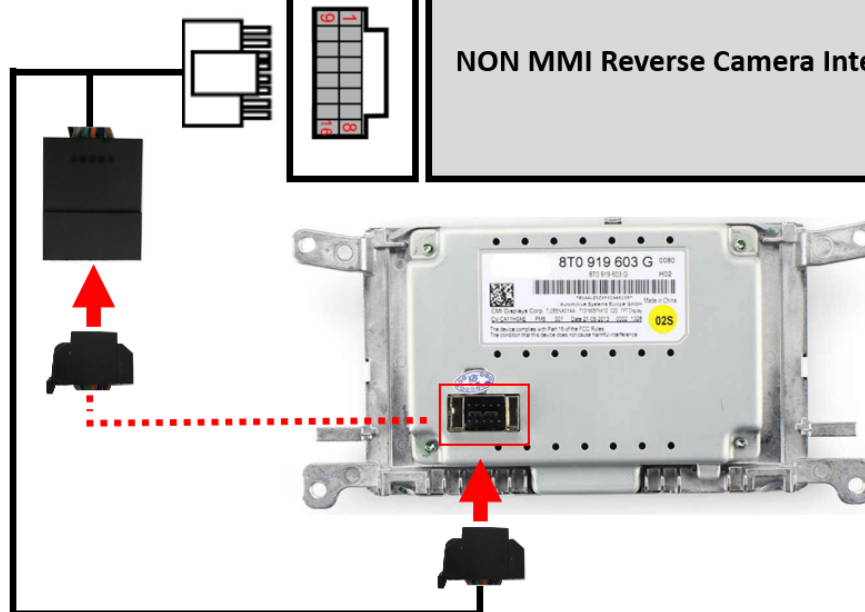

27-552 NON MMI Reverse Camera Interface

4. Set Camera Connections

Connect the cameras to the camera Input harness, this harness also supplies optional power outputs to the camera. Cars with manual gears may need the reverse trigger wire to be connected.

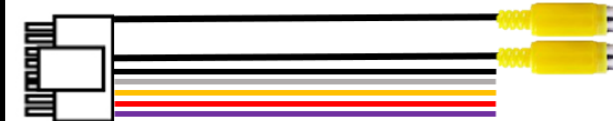

Wire Connections

9: Rear video -	1: Front video -
10: Rear video +	2: Front video +
11: n/c	3: n/c
12: n/c	4: n/c
13: n/c	5: Reverse trigger in
14: Ground	6: n/c
15: +12V output power supply for camera	7: n/c
16: +12V constant output	8: +12V output accessory